

# MILLENNIUM FREESCALE™

## FS818 SERIES

### PRODUCT FEATURES:

- » Surface mount – wall or ceiling; 12"W×23"H×6"D
- » Marine grade aluminum baseplate
- » Round or Triangle 100% DR acrylic lens options with multiple lens frame styles
- » UL certified IP65 per IEC 60598



FS818R

FS818T

### SPECIFICATIONS

**BASEPLATE:** Die-formed marine grade aluminum; welded corners. Baseplate provided with four-point mounting holes, one wireway hole – see Cross Section/Details. TGIC Polyester powder coat – 5-stage pre-treatment; Salt spray test: 1,000 hours.

**REFLECTOR:** Die-formed marine grade aluminum. Full reflector/wire cover – 92% reflectivity.

**LENS:** UV-stabilized, high impact resistant, pressure formed pearlescent 100% DR acrylic. Nominal thickness .125". Lens secured in place by lens frame and sealed to baseplate with closed cell silicone gasket.

**LENS FRAME/CROSS BARS:** Marine grade aluminum; secured to baseplate with tamper-resistant stainless steel Torx® with center pin fasteners. Cross bars nominal thickness .25". Post assembly TGIC polyester powder coat – 5-stage pre-treatment; Salt spray test: 1,000 hours. Optional perf insert 30% open, stainless steel. See Ordering Information for standard, optional, architectural, and custom finishes.

**HARDWARE:** Four stainless steel Torx® with center pin fasteners. Internal brackets and fasteners are non-corrosive. Surface Conduit Adapter (SCA) accessory – stainless steel trim frame assembly with integral J-box; finished to match lens frame (n/a with CA finish). Water-tight conduit fittings supplied by others. Rough Service Adapter (RSA) accessory – stainless steel plate (adds .625" height) finished to match lens frame (n/a with CA finish). Stainless steel fasteners provided for mounting fixture to RSA or SCA.

**ELECTRICAL:** Available 3500K, 4000K and 5000K color temperatures, 82 CRI. 120-277VAC, 50/60Hz electrical input with serviceable high power factor electronic, constant-current driver (<20% THD, >0.95 PF). Standard 0-10V dimming with 10-100% range, maximum driver source of 500 µA.

**INSTALLATION:** Standard four-point mounting required for Peace of Mind Guarantee®.

**PHOTOMETRICS:** Photometry tested to the IESNA LM-79-08 standard by an ILAC/ISO17025 accredited laboratory. For photometric information, go to [www.kenall.com](http://www.kenall.com).

**WARRANTY:** Limited five (5) year LED warranty.

**LISTINGS:** UL and CUL listed for Wet Location. UL certified IP65 per IEC 60598.



### ORDERING INFORMATION (Ex: FS818T-1M-PIA-MB-25L40K-1-120-FS)

Model	Lens Frame	Lens Type	Finish	Lamp Type	Lamp Qty	Voltage	Options	Accessories
					<b>1</b>			
<b>Model</b>		<b>Lamp Type</b>		<b>Options</b>				
FS818R Round		25L35K 25 Watt 3500K LED		FS Single Fuse & Holder				
FS818T Triangle		25L40K 25 Watt 4000K LED		PC Photo Control with deep housing surface adapter (n/a with DV)				
		25L50K 25 Watt 5000K LED		PH Phillips Head Fasteners				
<b>Lens Frame</b>		<b>Lamp Quantity</b>		<b>Accessories</b>				
0 No Bars		1 One Lamp		RSA▼ Rough Surface Adapter				
1M One Bar – Middle				SCA▼ Surface Conduit Adapter				
2M Two Bars – Middle				9500 Torx® Screwdriver				
2TB Two Bars – Top & Bottom				D-0552 Torx® Driver Bit				
2TBP Two Horizontal Bars w/Perf		<b>Voltage</b>						
3E Three Bars – Even Spaced		120 120 Volts						
4TB Four Bars – Top & Bottom		277 277 Volts						
		DV 120-277 Volts						

▼ n/a with option(s) that require deep housing surface adapter

### Lens Type

- PIA Pearlescent High Impact 100% DR Acrylic
- MPA Matte Pearlescent High Impact 100% DR Acrylic

### Finish

- BR Bronze
- CS Cool Satin Aluminum
- DB Dark Bronze
- FG Forest Green
- LG Light Gray
- MB Matte Black
- MW Matte White
- WS Warm Satin Aluminum
- CC Custom Color (Consult factory)

### LENS FRAME

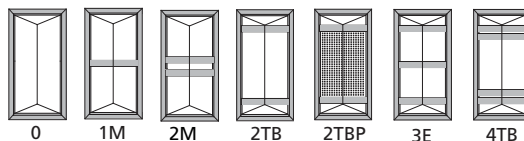

[www.kenall.com](http://www.kenall.com)

P: 800-4-Kenall

F: 262-891-9701

10200 55th Street Kenosha, Wisconsin 53144

When you see this image, you will know the Kenall product shown or described is designed and manufactured in the USA with components purchased from US suppliers, and meets the Buy American requirements under the ARRA. Kenall has not determined the origin of its domestically purchased components or the subcomponents thereof. May be covered by patents found at [www.kenall.com/patents](http://www.kenall.com/patents). Content of specification sheets is subject to change; please consult [www.kenall.com](http://www.kenall.com) for current product details. © 2018 Kenall Mfg. Co. All rights reserved.

# MILLENIUM FREESCALE™

## FS818 SERIES – Technical Data

### PERFORMANCE

Lamp Type	Initial Delivered Lumens		Input Power (W)	Drive Current (mA)	Estd. L70 LED Life (Hrs)
	@ 25°C	Efficacy (lm/W)			
25L35K	1636	55	30	94	80,000
25L40K	1744	58	30	94	80,000
25L50K	1814	60	30	94	80,000

Displayed info is for PIA lens only. Infor subject to change. Visit [www.kenall.com](http://www.kenall.com) for IES files and additional information.

Model: FS818T-2TB-PIA-MB-25L40K-DV

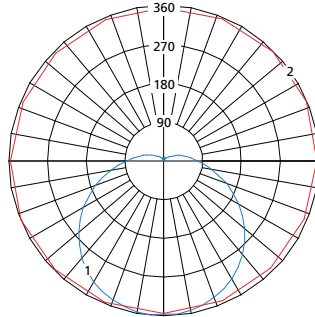

Maximum Candela = 360 Located At Horizontal Angle = 202.5, Vertical Angle = 5

- 1 - Vertical Plane Through Horizontal Angles (202.5-22.5) (Through Max. Cd.)
- 2 - Horizontal Cone Through Vertical Angle (5) (Through Max. Cd.)

### DIMENSIONAL DATA

FS818R CROSS SECTION

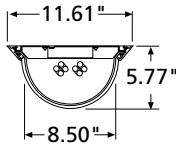

(4) 1/2" Conduit Entries

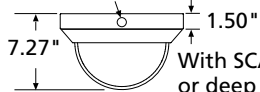

With SCA option or deep housing surface adapter

FS818T CROSS SECTION

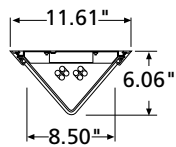

(4) 1/2" Conduit Entries

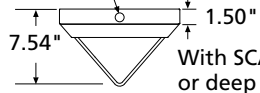

With SCA option or deep housing surface adapter

BACK VIEW

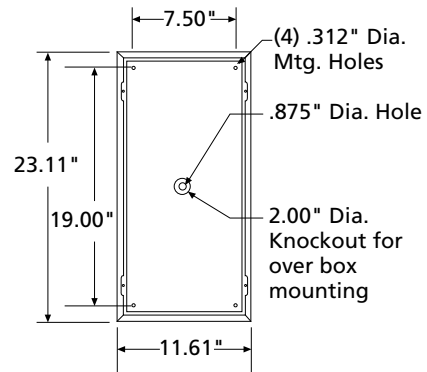

[www.kenall.com](http://www.kenall.com)

P: 800-4-Kenall

F: 262-891-9701

10200 55th Street Kenosha, Wisconsin 53144

When you see this image, you will know the Kenall product shown or described is designed and manufactured in the USA with components purchased from US suppliers, and meets the Buy American requirements under the ARRA. Kenall has not determined the origin of its domestically purchased components or the subcomponents thereof. May be covered by patents found at [www.kenall.com/patents](http://www.kenall.com/patents). Content of specification sheets is subject to change; please consult [www.kenall.com](http://www.kenall.com) for current product details. © 2018 Kenall Mfg. Co. All rights reserved.