

MIGHTY MAC™

WDS SERIES

PRODUCT FEATURES:

- » Surface wall mount – (10"×11")×26", (10"×11")×51"
- » Dual purpose – luminaire with built-in bookshelf
- » TIG welded housing with no post grinding for additional strength
- » Vertically adjustable bracket secured to housing via thru-studs



PROJECT INFORMATION

Job Name _____

Fixture Type _____

Catalog Number _____

Approved by _____

SPECIFICATIONS

HOUSING: One-piece die-formed prime grade material as specified – see ordering information. Corners continuously seam welded and smooth with no post grinding (TIG).

LENS: As specified – maximum thickness .625" – see ordering information. Kenall recommends a prismatic inner lens and a clear outer lens. Two clear lenses used in combination cannot be provided.

LENS RETENTION: Vertically adjustable continuous "Z" brackets of prime grade material, secured to housing via thru-studs (6" maximum spacing).

DOOR: One-piece die-formed prime grade material as specified – see ordering information.

HINGE: Staked and welded external piano hinge (1/2" knuckle/1/8" diameter pin) standard. See Options for Internal Hinge (IH) and Full Length Internal Hinge (IHF).

FASTENERS: Hardened security screws as specified – see ordering information. Fully recessed.

FINISH: TGIC polyester powder coat – 5-stage pre-treatment. Salt spray test: 1,000 hours; Reflectance: 92%.

LAMPS: Quantity and type as specified – see ordering information. Lamps supplied by others.

BALLAST: Quantity and type as specified – see ordering information. All ballasts UL listed class P.

LUMINOUS SEAL: Polyurethane foam prevents light leaks from luminaire base.

PHOTOMETRICS: For photometric information, go to www.kenall.com.

WARRANTY: One (1) year warranty for Kenall fluorescent products.

LISTINGS: UL and CUL listed for damp locations.



ORDERING INFORMATION (Ex: WDS-2-0/0-2-17-RS-1-120- 1/B-1)

Model	Size	Hsg./Base Plate	Lamp Qty	Lamp Type	Ballast Type	Ballast Qty	Voltage	Lens (Inner/Outer)	Fasteners	Options
WDS		/						/		
Nominal Size			Lamp Quantity		Ballast Quantity				Fastener	
2 (10"×11")×26"			1 One		1 One				1 Torx® Head w/ Center Pin	
4 (10"×11")×50"			2 Two						2 Allen Head w/ Center Pin	
Housing/Door Material			Lamp Type		Voltage				Options	
0 14-Ga CRS (Painted White)			2' Nominal Length		120 120 Volts				EL Standard Lumen EL Pack	
1 16-Ga CRS (Painted White)			17 F17T8		277 277 Volts				PEL High Lumen EL Pack	
2 18-Ga CRS (Painted White)					347 347 Volts				SEL Specified EL Pack	
3 14-Ga SS (Painted White)			4' Nominal Length						DLN LED Night Light w/Light Level Control (100% - 20%. Voltage specific selection required)	
4 16-Ga SS (Painted White)			32 F32T8						FS Single Fuse & Holder	
6 14-Ga SS (Brushed)									IH Internal Hinge	
7 16-Ga SS (Brushed)			Ballast Type		Lens (Inner/Outer)‡				IHF Full Length Internal Hinge	
			IS Instant Start Electronic <10% THD (T8)		0 No Lens				PSL♦ Push Switch – Left side (as viewed facing fixture)	
			RS Rapid Start Electronic <10% THD (T8)		1 .125" Prismatic Acrylic				PSR♦ Push Switch – Right side (as viewed facing fixture)	
			SB Specified Ballast		2 .125" Prismatic Polycarbonate				RGT Removable Gear Tray	
					3 .125" Textured Polycarbonate				TCL♦ Touch Control Switch – Left side (as viewed facing fixture)	
					4 .125" Clear Polycarbonate				TCR♦ Touch Control Switch – Right side (as viewed facing fixture)	
					5 .156" Prismatic Polycarbonate				TN PL Night Light – 5/7/9 Watt (Lamp supplied by others; 120/277V specific selection required)	
					6 .156" Textured Tempered Glass				UV Ultraviolet Filter	
					7 .187" Prismatic Polycarbonate					
					8 .187" Clear Polycarbonate					
					9 .187" Clear Tempered Glass					
					A .250" Clear Polycarbonate					
					B .375" Clear Polycarbonate					
					C .375" Clear Tempered Glass					
					J .500" Clear Polycarbonate					
					P .500" Clear Tempered Glass					

‡ Refer to lens specifications
♦ n/a with 347V



www.kenall.com | P: 800-4-Kenall | F: 262-891-9701 | 10200 55th Street Kenosha, Wisconsin 53144, USA

A brand of **legrand**

This product complies with the Buy American Act: manufactured in the United States with more than 50% of the component cost of US origin. It may be covered by patents found at www.kenall.com/patents. Content of specification sheets is subject to change; please consult www.kenall.com for current product details. ©2019 Kenall Mfg. Co.

MIGHTY MAC™

WDS SERIES

DIMENSIONAL DATA

CROSS SECTION

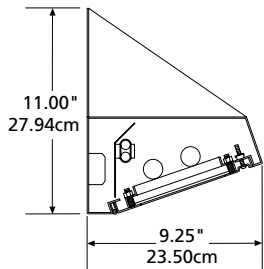

MOUNTING HOLES

