

# TEKDEK™ TD17

## Luminaires for Parking Garages

PEACE OF MIND  
Guarantee®



POLYCARBONATE LENS &  
DIRECT SURFACE MOUNT ONLY

### PRODUCT FEATURES

- Textured tertiary lens for glare reduction and up-light feature to eliminate "cave-effect"
- Outputs ranging from 4,080 lm to 14,866 lm
- Compatible with TekLink™ lighting control technology and Wattstopper FSP-600 Series



### SPECIFICATIONS

**HOUSING:** Marine-grade die-cast aluminum and UV-stabilized polycarbonate construction. Standard TGIC polyester powder coat finish on aluminum components with five-step pre-treatment to withstand 1,000 hour salt spray test per ASTM B117. See Ordering Information for available finishes. Closed-cell silicone gasketing seals all housing component interfaces. Die-cut closed-cell neoprene self-adhesive gasket seals housing to mounting surface (DTS).

**MOUNTING:** Direct-to-surface (DTS) mounting over recessed junction box, Trunnion Mount (TK) or pendant-mounted (PM) via 3/4" (1.91 cm) rigid sealed conduit (by others). See Ordering Information for selection. Housing access secured via tamper-resistant Torx™ fasteners.

**OPTICAL:** Type II, V-Narrow and V-Square roadway distributions available. UV-stabilized, high-impact resistant injection-molded clear textured 100% DR acrylic or polycarbonate tertiary lens.

**ELECTRICAL:** Serviceable high-brightness LED array. See Ordering Information for color temperature and CRI options. 70 CRI minimum. 120-277 VAC, 347VAC and 480VAC 50/60Hz single-phase input; constant-current dimming driver; <20% THD, >0.90 PF. Minimum 83% electrical efficiency. 0-10V dimming protocol with 10-100% range without dim-to-dark capabilities; 0.9mA max source current Replaceable surge suppressor rated to 20kA/kV per IEEE/ANSI C62.41 Cat. A. EMC compliant with FCC 47 CFR Part 15, Class B. Passes IEC 61000-4-4 EFT and IEC 61000-4-5 (Class 4) surge evaluation.

**CONTROLS & SENSOR:** Optional TekLink lighting control system. Optional sensor available with compatible Wattstopper or other third party controls. To see the full list of compatible controls, [click here](#).

**PHOTOMETRICS:** Photometry tested to the IESNA LM-79-08 standard by an ILAC/ISO17025 accredited laboratory. For additional photometric data, please go to [www.kenall.com](http://www.kenall.com).

**WARRANTY:** Limited five (5) year warranty. [Peace of Mind Guarantee against breakage](#).

**LISTINGS:** Luminaire is certified to UL Standards by Intertek Testing Laboratory for Wet Location. IP65 rating per IEC 60598. Ambient temperature rating is -40°C to 50°C (55°C on 30L/47L). Passes 3G vibration test per ANSI C136.31-2001. Luminaire tested to an IK10 impact protection rating per IEC 60068-2-75:1997-08 (TP Lens type required). Build America, Buy America Act compliant.

### ORDERING INFORMATION (EX: TD17-PM-5N-TP-DB-47L-40K8-DCC-DV)

Model	Mounting	Dist. Type	Lens Type	Finish	Lamp Power	Lamp Color	Driver Type	Voltage	Options	Accessories	Controls	Controls Kit
<b>TD17</b>							<b>DCC</b>					< >
<b>Mounting</b>			<b>Lamp Power</b>			<b>Voltage</b>			<b>Controls - Wattstopper</b>			
<b>DTS*</b>	Direct-to-Surface		<b>30L</b>	30W LED	<b>DV</b>	120-277 VAC, 50/60Hz			<b>WSP6-L2</b> 8ft Height Lens			
<b>PM</b>	Pendant Mount		<b>47L</b>	47W LED	<b>347†</b>	347VAC, 60Hz			<b>WSP6-L2S</b> 8ft Height Lens w/ Shroud			
<b>TK</b>	Trunnion Kit		<b>72L</b>	72W LED	<b>480•</b>	480VAC, 60Hz			<b>WSP6-L2C</b> 8ft Height Lens w/ Collar			
<b>QM§</b>	Quick Mount System		<b>94L</b>	94W LED					<b>WSP6-L3</b> 20ft Height Lens			
<b>Distribution Type</b>			<b>Lamp Color</b> ▼			<b>Options</b>			<b>WSP6-L3S</b> 20ft Height Lens w/ Shroud			
<b>2™▲</b>	Type II		<b>30K8</b>	3000K/80CRI min	<b>LEL‡•</b>	7W Emergency Battery Pack (32°F [0°C] minimum ambient, DV input only)			<b>WSP6-L3C</b> 20ft Height Lens w/ Collar			
<b>2HSS™▲</b>	Type II, House-side shield		<b>35K8</b>	3500K/80CRI min	<b>GTDU•</b>	UL924 and UL1008 Listed Switch Bypass/Lighting Transfer Switch with 0-10V Dimming Override (not available with LEL/CEL Option, DV input only)			<b>WSP6-L7</b> 40ft Height Lens			
<b>5N</b>	Type V – Narrow Round		<b>40K8</b>	4000K/80CRI min	<b>FS</b>	Single Fuse & Holder			<b>WSP6-L7S</b> 40ft Height Lens w/ Shroud			
<b>5S</b>	Type V – Wide Square		<b>40K7</b>	4000K/70CRI min	<b>BG</b>	Bird Guard			<b>WSP6-L7C</b> 40ft Height Lens w/ Collar			
<b>Lens Type</b>			<b>Driver Type</b>			<b>Accessories</b>			Please consult Kenall Applications when ordering TekLink controls. When specifying with integral TekLink controls, a mounting height of 10-14' is recommended for optimal sensor coverage; 20' maximum with reduced coverage.			
<b>TP*</b>	Textured Polycarbonate		<b>DCC</b>	0-10V Dimming Constant Current	<b>PH</b>	Phillips Fasteners			<b>Controls Kit</b>			
<b>TA</b>	Textured Acrylic				<b>A1</b>	A1 Construction (see page 4)			< > Factory Assigned Internal Code			
<b>Finish</b>			<b>Controls - TekLink</b>			<b>Controls - TekLink</b>			* Required for Peace of Mind Guarantee®			
<b>DB</b>	Dark Bronze		<b>TL50§</b>			Non-Networked Control - Motion Only			‡ Not available with 94L Lamp Type			
<b>FG</b>	Forest Green		<b>TL100</b>			Wireless Networked Control - Motion Only			▲ Not available in conjunction with TL1000 or TL2000			
<b>GW</b>	Reflectance White		<b>TL1000*</b>			Wired Network Control - Advanced			■ Not available with 30L Lamp Type or TL50 TekLink Option			
<b>LG</b>	Light Gray		<b>TL2000*</b>			Wireless Network Control - Advanced			§ S1 Construction (See page 3)			
<b>MB</b>	Matte Black								• A1 Construction (See page 3)			
<b>MW</b>	Matte White								▼ A2 Construction (see page 3)			
<b>SL</b>	Silver								† A1 Construction when paired with TL50 or TL100 Control System			
<b>CC</b>	Custom Color (consult factory)											

**PERFORMANCE**

Lamp Code	Initial Delivered Lumens, By Optic Type (lm)						Efficacy (lm/W)	Input Power (W)	Estd. L70 LED Life (Hrs)
	2-TA	2-TP	5S-TA	5S-TP	5N-TA	5N-TP			
30L-57K7	4,843	4,814	5,349	5,317	5,319	5,288	134 - 149	36	175,000
30L-50K7	4,843	4,814	5,349	5,317	5,319	5,288	134 - 149	36	175,000
30L-40K7	4,843	4,814	5,349	5,317	5,319	5,288	134 - 149	36	175,000
30L-40K8	4,370	4,344	4,827	4,798	4,800	4,772	121 - 134	36	175,000
30L-35K8	4,370	4,344	4,827	4,798	4,800	4,772	121 - 134	36	175,000
30L-30K8	4,104	4,080	4,510	4,483	4,508	4,482	113 - 125	36	175,000
47L-57K7	6,867	6,826	7,584	7,540	8,060	8,012	129 - 152	53	175,000
47L-50K7	6,867	6,826	7,584	7,540	8,060	8,012	129 - 152	53	175,000
47L-40K7	6,867	6,826	7,584	7,540	8,060	8,012	129 - 152	53	175,000
47L-40K8	6,197	6,160	6,845	6,804	7,274	7,231	116 - 137	53	175,000
47L-35K8	6,197	6,160	6,845	6,804	7,274	7,231	116 - 137	53	175,000
47L-30K8	5,820	5,786	6,395	6,357	6,831	6,791	109 - 129	53	175,000
72L-57K7	9,414	9,358	10,097	10,038	11,566	11,498	120 - 148	78	150,000
72L-50K7	9,414	9,358	10,097	10,038	11,566	11,498	120 - 148	78	150,000
72L-40K7	9,414	9,358	10,097	10,038	11,566	11,498	120 - 148	78	150,000
72L-40K8	8,496	8,445	9,112	9,058	10,438	10,376	108 - 134	78	150,000
72L-35K8	8,496	8,445	9,112	9,058	10,438	10,376	108 - 134	78	150,000
72L-30K8	7,979	7,932	8,590	8,539	9,803	9,745	102 - 126	78	150,000
94L-57K7	11,699	11,630	12,549	12,474	14,374	14,289	118 - 146	99	125,000
94L-50K7	11,699	11,630	12,549	12,474	14,374	14,289	118 - 146	99	125,000
94L-40K7	11,699	11,630	12,549	12,474	14,374	14,289	118 - 146	99	125,000
94L-40K8	10,558	10,496	11,324	11,257	12,972	12,895	106 - 131	99	125,000
94L-35K8	10,558	10,496	11,324	11,257	12,972	12,895	106 - 131	99	125,000
94L-30K8	9,953	9,894	10,675	10,612	12,183	12,111	100 - 123	99	125,000

Displayed information is for selected luminaires only. Information subject to change without notice. Visit [www.kenall.com](http://www.kenall.com) for .ies files and additional information.

Model: TD17-sss-2-TA-vv-94L-40K7-DCC-DV

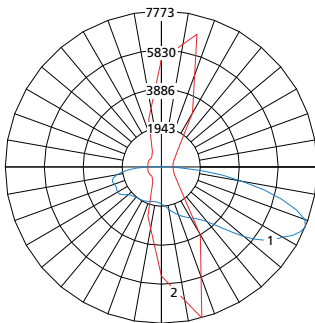

Model: TD17-sss-5N-TA-vv-94L-40K7-DCC-DV

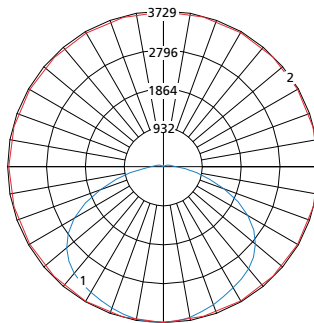

Model: TD17-sss-5S-TA-vv-94L-40K7-DCC-DV

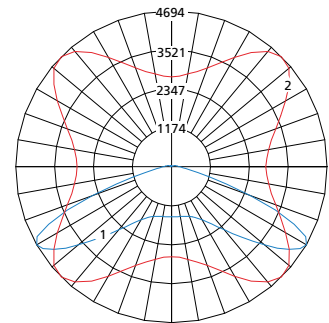
**LUMEN AMBIENT TEMPERATURE (LAT) FACTORS**

Avg. Ambient Temperature	10°C	15°C	20°C	25°C	30°C	35°C	40°C
Lumen Output Factor	1.03	1.02	1.01	1	0.99	0.98	0.97

**DIMENSIONAL DATA**

**CONSTRUCTION 'S1' DIMENSIONS**

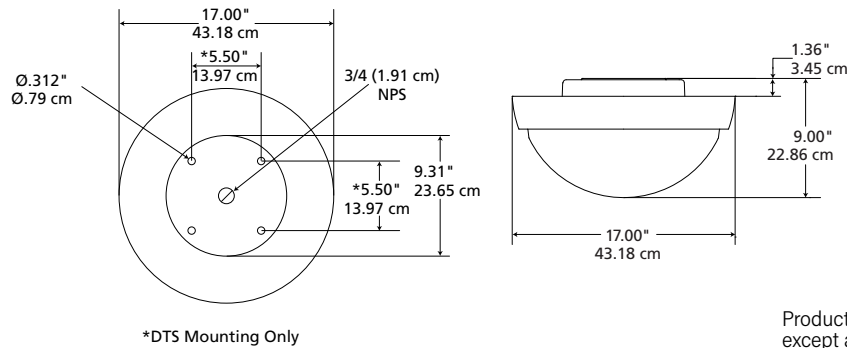

Product built as above under all configurations, except as noted for options below.

**CONSTRUCTION 'A1' DIMENSIONS**

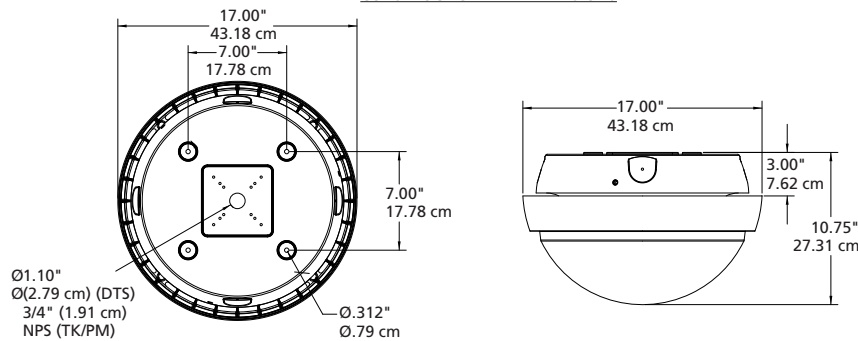

Product built as A1 when ordered with '480V', 'LEL', 'GTDU', 'A1', 'TL1000' (w/ standard microwave sensor) or 'TL2000' (w/ standard microwave sensor) option

**CONSTRUCTION 'A2' DIMENSIONS**

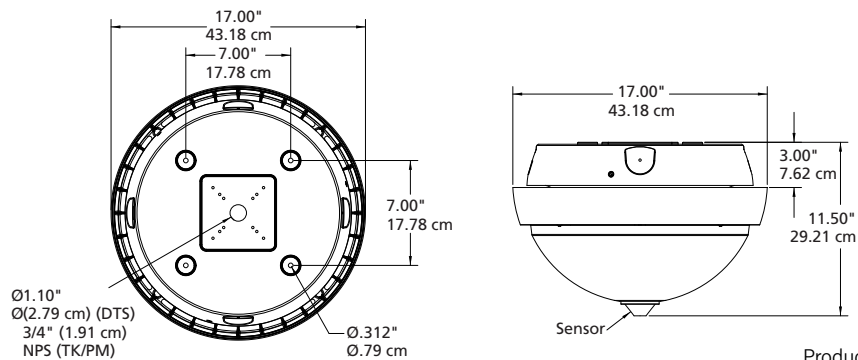

Product built as A2 when ordered with 'TL1000' (w/ PIR sensor), or 'TL2000' (w/ PIR sensor) option. PIR sensor is not standard, but available upon request

**OPTIONS WATTSTOPPER CONTROLS**

**Wireless System: Smart and Simple**  
Wattstopper PLUS

The FSP-600 series by Wattstopper PLUS is an integrated, luminaire level lighting controller and sensor for indoor/outdoor lighting applications that require networked wireless control. The FSP-600 series is designed to integrate directly into exterior, high bay, parking garage, and general site lighting solutions. Each FSP-600 supports 0-10V continuous dimming, occupancy sensing and daylight control.

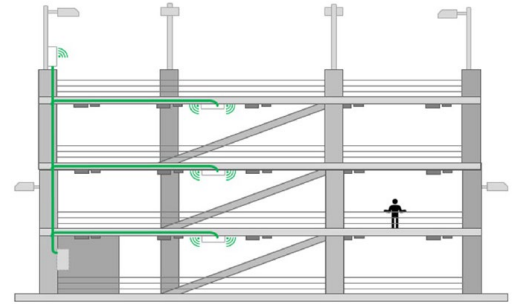

*Ideal Wireless Manager Locations in Parking Structure*

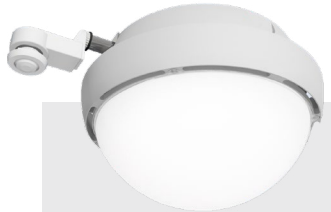

**TD17 SERIES**

**Other Available Products**



**HPG SERIES**



**SPG SERIES**

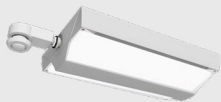

**MOS SERIES**

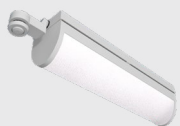

**TES SERIES**

**Coverage Patterns**

**FSP-L2 top and side coverage patterns**

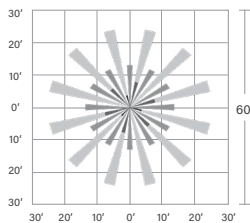

**Wattstopper PLUS FSP-600 series Wireless Sensor**

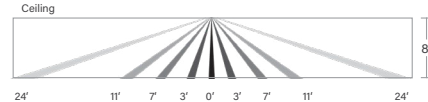

**FSP-L3 top and side coverage patterns**

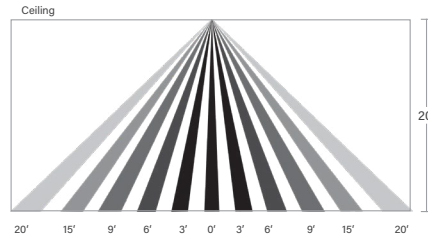
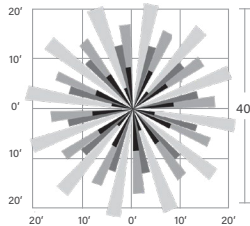

**FSP-L7 top and side coverage patterns**

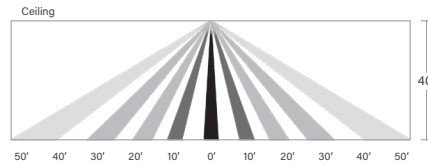
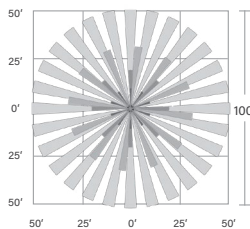

**FSP-600 series by Wattstopper PLUS Features and Benefits**

- High- and low-mounted solution designed for industrial & outdoor environments
- All-in-one control with 0-10V continuous dimming, occupancy and daylighting
- Load and zone-based control to meet advanced energy codes
- Multiple lens options to meet a variety of mounting heights and coverage needed
- Programmable parameters include scheduling, grouping, time delay, high/low/off, time clock, and many more.
- Seamless integration into the Wattstopper PLUS lighting control platform
- Out-of-the-box functionality
- Data insights via Polaris Monitor software
- Included in Wattstopper's OEM Partner Program
- End-of-line testing features make install easy and 'touchless' on the factory floor

For additional FSP-600 resources [click here](#).

**OPTIONS WATTSTOPPER CONTROLS**

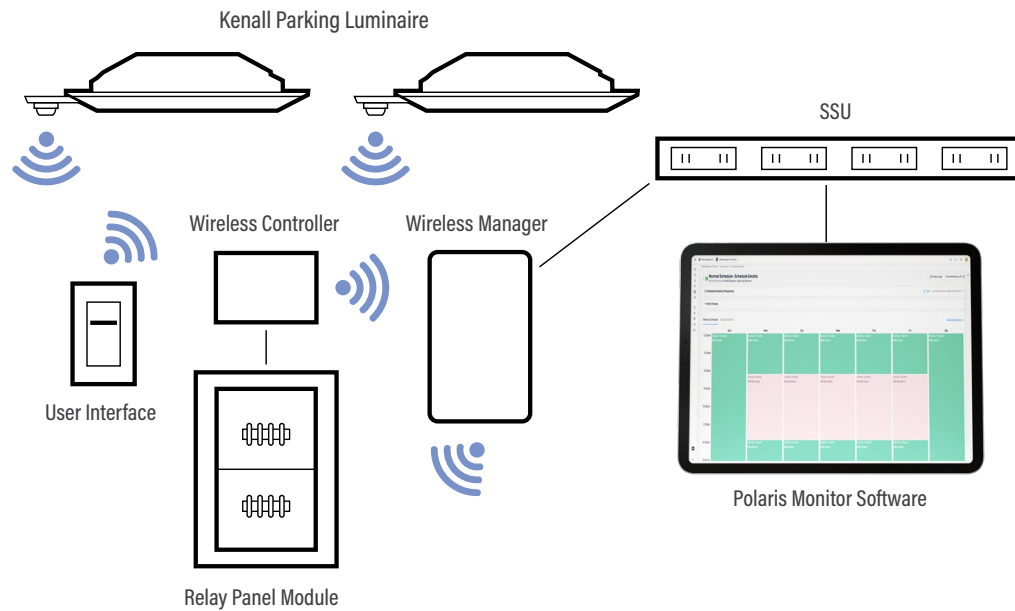

**Initial Power Up and Other Settings**

Factory default setting is 100% light output until the FSP-600 is commissioned into the Wattstopper Plus network.

Polaris software supports the ability to monitor power and energy calculations based on schedules, occupancy, and load usage.

The FSP-600 series commissioning process is similar to existing PLUS devices, Polaris config software supports the following capabilities:

- Control loads individually or as a group
- Event scheduling using astronomical or time of day
- Occupancy sensing to turn loads on or off and dim to a level using ramp up or fade down timers.

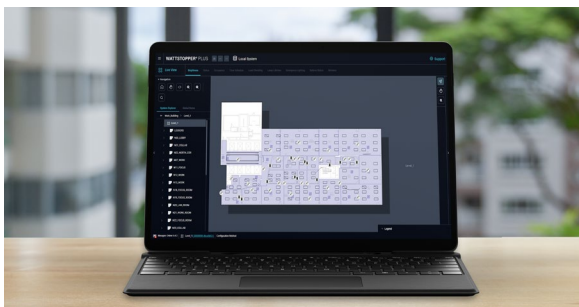

**Bringing Visibility & Control to Wattstopper PLUS**

Polaris software is at the core of Wattstopper PLUS — empowering facility managers and enabling the Wattstopper Experience. The advanced Polaris Monitor software is intuitive and easy to use thanks to new workflows, multi-device access, and other enhancements.