

MIGHTY MAC™

SDA SERIES

PRODUCT FEATURES:

- » Surface ceiling mount – 12"×24", 12"×48"
- » Housing TIG welded with no post grinding for additional strength
- » "Z" bracket lens retention with thru-studs spaced 6" apart



SPECIFICATIONS

HOUSING: One-piece die-formed prime grade material as specified – see ordering information. Corners continuously seam welded and smooth with no post grinding (TIG).

LENS: As specified – maximum thickness .625" – see ordering information. Kenall recommends a prismatic inner lens and a clear outer lens. Two clear lenses used in combination cannot be provided.

LENS RETENTION: Vertically adjustable continuous "Z" brackets of prime grade material, secured to housing via thru-studs (6" maximum spacing).

DOOR: One-piece die-formed prime grade material as specified – see ordering information.

HINGE: Staked and welded external piano hinge (1/2" knuckle/1/8" diameter pin) standard. See Options for Internal Hinge (IH) and Full Length Internal Hinge (IHF).

FASTENERS: Hardened security screws as specified – see ordering information. Fully recessed.

FINISH: TGIC polyester powder coat – 5-stage pre-treatment. Salt spray test: 1,000 hours; Reflectance: 92%.

LED MODULE: Serviceable mid-power LED array. Minimum 80 CRI standard (R9>0), consult factory for optional 90CRI (R9>50). Maximum three-step MacAdam ellipse variation. See Ordering Information for available color temperature options.

DRIVER: 120-277VAC or 347VAC, 50/60Hz electrical input with serviceable constant-current driver (<20% THD, >0.90 PF). Minimum 85% driver efficiency. Standard 0-10V dimming with 1-100% range and dim-to-dark capabilities; 0.4mA maximum source current.

SENSOR & CONTROLS: Optional sensor available with compatible third party controls. To see the full list of compatible controls, click [here](#).

PHOTOMETRICS: Photometry tested to the IESNA LM-79-08 standard by an ILAC/ISO17025 accredited laboratory. For additional photometric data, please go to www.kenall.com.

WARRANTY: Limited five (5) year warranty on LED lamps.

LISTINGS: Luminaire is certified to UL1598 and UL8750 standards by Intertek Testing Services for Damp Locations.



ORDERING INFORMATION (Ex: SDA-2-1/1-45L35K-DCC-DV-SYM/B-1-NLA)

Model	Size	Housing/Door	Lamp Code	Driver Type	Input Voltage	Lens (Inner/Outer)	Fasteners	Options
SDA		/		DCC		/		
Nominal Size		Lamp Code		Driver Type		Input Voltage		Options
2	12"×24"	2' Nominal Length		SYM ▲ Symmetric, Diffused DR Acrylic				LEL Integral 10W Emergency Battery Backup (4' only, 45L max; n/a 347V, 0°C min ambient)
4	12"×48"	45L30K 45 Watt 3000K LED (82 CRI)		0 No Lens				LELST Integral 6W Self-Testing Emergency Battery Backup (4' only, 45L max; n/a 347V, 0°C min ambient)
Housing/Door Material		45L35K 45 Watt 3500K LED (82 CRI)		1 .125" Prismatic Acrylic				NLW ▲ 2700K White LED Night Light
0	14-Ga CRS (Painted White)	45L40K 45 Watt 4000K LED (82 CRI)		2 .125" Prismatic Polycarbonate				NLA ▲ Amber LED Night Light
1	16-Ga CRS (Painted White)	45L50K 45 Watt 5000K LED (82 CRI)		3 .125" Textured Polycarbonate				IHF Full Length Internal Hinge
2*	18-Ga CRS (Painted White)	4' Nominal Length		G† .125" Clear Polycarbonate				IH Internal Hinge
3	14-Ga SS (Painted White)	45L30K 45 Watt 3000K LED (82 CRI)		4 .156" Prismatic Polycarbonate				FS Single Fuse & Holder
4	16-Ga SS (Painted White)	45L35K 45 Watt 3500K LED (82 CRI)		TG .250" Textured Tempered Glass				KO 1/2" EMT Knockout
6	14-Ga SS (Brushed)	45L40K 45 Watt 4000K LED (82 CRI)		6 .187" Prismatic Polycarbonate				RGT Removable Gear Tray
7	16-Ga SS (Brushed)	45L50K 45 Watt 5000K LED (82 CRI)		7† .187" Clear Polycarbonate				SK Speaker Housing Extension
9	12-Ga CRS (Painted White)	67L30K 67 Watt 3000K LED (82 CRI)		8† .187" Clear Tempered Glass				WL Wet Location Listed
		67L35K 67 Watt 3500K LED (82 CRI)		9† .250" Clear Polycarbonate				
		67L40K 67 Watt 4000K LED (82 CRI)		A† .250" Clear Tempered Glass				
		67L50K 67 Watt 5000K LED (82 CRI)		B† .375" Clear Polycarbonate				
		Driver Type		C† .375" Clear Tempered Glass				
		DCC Dimming Constant Current		J† .500" Clear Polycarbonate				
		Input Voltage		P† .500" Clear Tempered Glass				
		DV 120-277VAC, 50/60Hz		Fasteners				
		347 347VAC, 60Hz		1 Torx® T-20 Head w/ Center Pin				
				2 Allen Head w/ Center Pin				

* n/a as Door Material
 † Must be paired with prismatic, diffused or textured lens
 ‡ Refer to lens specifications
 ▲ Can only be used with clear or no outer lens
 ▼ n/a with 347 input



MIGHTY MAC™

SDA SERIES

PERFORMANCE

Nominal Size	Lamp Type	Initial Delivered Lumens		Input Power (W)	Drive Current (mA)	Estd. L70 LED Life (Hrs)
		@ 25°C	Efficacy (lm/W)			
2	45L30K	3,998	86	46	100	>72,000
	45L35K	4,122	89	46	100	>72,000
	45L40K	4,263	92	46	100	>72,000
	45L50K	4,437	96	46	100	>72,000
4	45L30K	4,386	95	46	100	>72,000
	45L35K	4,522	98	46	100	>72,000
	45L40K	4,676	102	46	100	>72,000
	45L50K	4,868	106	46	100	>72,000
	67L30K	7,003	94	74	75	>72,000
	67L35K	7,220	97	74	75	>72,000
	67L40K	7,466	100	74	75	>72,000
	67L50K	7,772	104	74	75	>72,000

NOTE: All products tested with SYM/B lens configuration. See "Lumen Output Scaling Factor" table for output values with alternate lens configurations. Information subject to change without notice. Visit www.kenall.com for IES files and additional information.

Model: SDA-4-x-y-67L40K-DCC-z-SYM-B-1

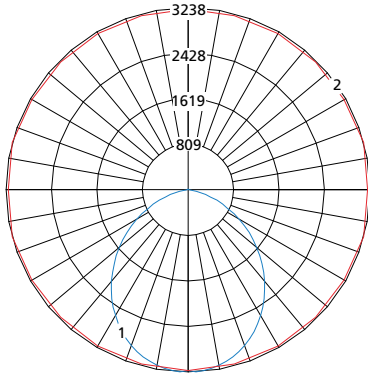

Maximum Candela = 3238 Located At Horizontal Angle = 15, Vertical Angle = 2.5

- 1 - Vertical Plane Through Horizontal Angles (15-195) (Through Max. Cd.)
- 2 - Horizontal Cone Through Vertical Angle (2.5) (Through Max. Cd.)

LUMEN OUTPUT SCALING FACTORS

Lens Configuration	Inner Lens	Outer Lens	Scaling Factor
SYM/G	1/8" Frost Acrylic	1/8" Clear PC	1.10
SYM/7		3/16" Clear PC	1.06
SYM/8		3/16" Clear TG	1.06
SYM/9		1/4" Clear PC	1.03
SYM/B		3/8" Clear PC	1.00
SYM/C		3/8" Clear TG	1.03
SYM/J		1/2" Clear PC	0.99
1/G		1/8" Prismatic Acrylic	1/8" Clear PC
1/9	1/4" Clear PC		0.99
1/B	3/8" Clear PC		0.99
2/J	1/2" Clear PC		0.87

NOTE: Use this table to determine the lumen output and efficacy of the desired lens configuration by multiplying the provided value with the appropriate number in the "Performance" table above.



MIGHTY MAC™

SDA SERIES

DIMENSIONAL DATA

CROSS SECTION

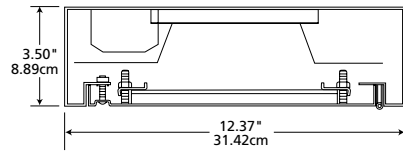

MOUNTING HOLES

