

# RANGER™

## R8 SERIES

### PRODUCT FEATURES:

- » Surface mount – ceiling or wall; nominal 8" x 24", 8" x 48"
- » 20-gauge cold rolled steel baseplate with one-piece extruded clear prismatic acrylic lens
- » ADA compliant



### PROJECT INFORMATION

Job Name \_\_\_\_\_

Fixture Type \_\_\_\_\_

Catalog Number \_\_\_\_\_

Approved by \_\_\_\_\_

### SPECIFICATIONS

**HOUSING:** One-piece 20-gauge CRS baseplate and end caps. Baseplate provided with four-point (2 and 3 foot), six-point (4 foot) and eight-point (6 foot) mounting holes and one wireway hole – see Cross Section/Details. White TGIC polyester powder coat – 5-stage pre-treatment. Salt spray test: 1,000 hours; Reflectance: 92%. Baseplate/end caps mount flush to ceiling or wall surface.

**LENS:** Positioned in baseplate channels and retained with two white nylon fasteners. One-piece extruded clear prismatic impact blend acrylic lens.

**SOCKETS:** Shock-resistant sockets with internal locking collar to ensure positive lamp retention.

**HARDWARE:** Two white nylon fasteners secure lens in baseplate channel.

**ELECTRICAL:** Available 3500K, 4000K and 5000K color temperatures, 82 CRI. 120-277VAC and 347VAC, 50/60Hz electrical input with serviceable high power factor electronic, constant-current driver (<20% THD, >0.95 PF). Standard 0-10V dimming with 1-100% range and dim-to-dark capabilities (non dim-to-dark with 347V). Maximum driver source of 330 µA. Constatl factory for fluorescent option.

**INSTALLATION:** Four-point (2 and 3 foot), six-point (4 foot) and eight-point (6 foot) mounting required for One Year Guarantee.

**WARRANTY:** Limited five (5) year warranty for LED lamps.

**LISTINGS:** UL and CUL listed for Damp Locations – wall and ceiling mount. See WL Option for Wet Locations, covered ceilings only. ADA Compliant.



### ORDERING INFORMATION (Ex: R8-48-67L40K-DCC-1-DV)

Model	Nom Length	Lamp Qty	Lamp Type	Ballast/Driver Type	Ballast/Driver Qty	Voltage	Options	Accessories	
<b>R8</b>									
<b>Nominal Length</b>		<b>Lamp Type</b>		<b>Ballast/Driver Type</b>		<b>Options</b>			
24	2	<b>2' Lengths</b>		<b>IS</b>	Instant Start Electronic <10% THD (T8, T8HO)		<b>EL†</b>	One-Lamp Indoor Battery Pack (32°F)	
48	4'	17 F17T8		<b>RS</b>	Rapid Start Electronic <10% THD (T8, T8HO, T5, T5HO)		<b>AL</b>	Marine Grade Aluminum Housing	
<b>Lamp Quantity†</b>		<b>4' Lengths</b>		<b>SB</b>	Specified Ballast		<b>PSS</b>	Painted Stainless Steel Housing	
2	Two Lamps	45L35K 45 Watt 3500K LED		<b>DCC</b>	0-10V Dimming LED Driver (LED only)		<b>BSS</b>	Brushed Stainless Steel Housing	
		45L40K 45 Watt 4000K LED		<b>Ballast/Driver Quantity</b>					
		45L50K 45 Watt 5000K LED		1	One		<b>.156</b>	.156" P12 Polycarbonate Lens	
		67L35K 67 Watt 3500K LED		2†	Two		<b>.187</b>	.187" P12 Polycarbonate Lens	
		67L40K 67 Watt 4000K LED		<b>Voltage</b>					
		67L50K 67 Watt 5000K LED		120	120 Volt		<b>FS</b>	Single Fuse & Holder	
		28 F28T5		277	277 Volt		<b>KO</b>	Two 1/2" EMT Conduit Entry Knockouts (one per end cap)	
		32 F32T8		347	347 Volt		<b>PM</b>	Pendant Mount (stems by others; damp only)	
		54 F54T5HO		DV	120-277 Volts		<b>TR</b>	Torx® Fasteners	
								<b>WL</b>	Wet Location Rating (covered ceiling only)
								<b>Accessory</b>	
								9500 Torx® with center pin	

† n/a with LED



www.kenall.com | P: 800-4-Kenall | F: 262-891-9701 | 10200 55th Street Kenosha, Wisconsin 53144, USA

A brand of **legrand**

This product complies with the Buy American Act: manufactured in the United States with more than 50% of the component cost of US origin. It may be covered by patents found at www.kenall.com/patents. Content of specification sheets is subject to change; please consult www.kenall.com for current product details. ©2019 Kenall Mfg. Co.

# RANGER™

## R8 SERIES

### PERFORMANCE

Lamp Type	Initial Delivered Lumens		Input Power (W)	Drive Current (mA)	Estd. L70 LED Life (Hrs)
	@ 25°C (lm)	Efficacy (lm/W)			
45L35K	5,949	124	48	100	80,000
45L40K	6,152	128	48	100	80,000
45L50K	6,573	137	48	100	80,000
67L35K	9,088	126	72	75	80,000
67L40K	9,398	131	72	75	80,000
67L50K	10,041	139	72	75	80,000

Information subject to change without notice. Photometry tested to the IESNA LM-79-08 standard by an ILAC/ISO17025 accredited laboratory. For photometric data, please go to [www.kenall.com](http://www.kenall.com)

Model: R8-48-67L40K-DCC-1-DV

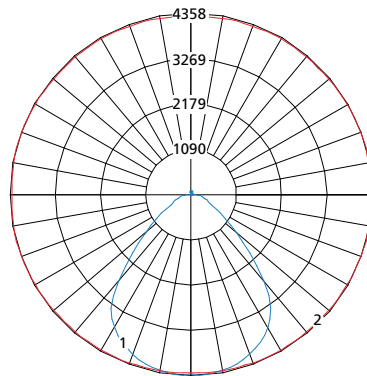

Maximum Candela = 4358 Located At Horizontal Angle = 15, Vertical Angle = 2.5

- 1 - Vertical Plane Through Horizontal Angles (15-195) (Through Max. Cd.)
- 2 - Horizontal Cone Through Vertical Angle (2.5) (Through Max. Cd.)

### DIMENSIONAL DATA

CROSS SECTION

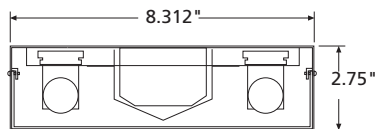

BASEPLATE – 2'

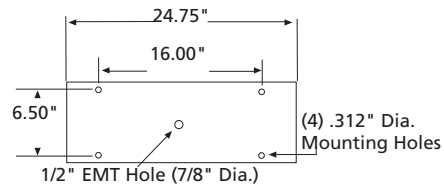

BASEPLATE – 4'

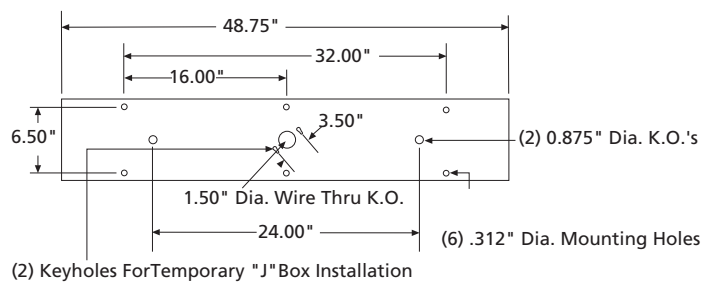

[www.kenall.com](http://www.kenall.com) | P: 800-4-Kenall | F: 262-891-9701 | 10200 55th Street Kenosha, Wisconsin 53144, USA

A brand of **Legrand**

This product complies with the Buy American Act: manufactured in the United States with more than 50% of the component cost of US origin. It may be covered by patents found at [www.kenall.com/patents](http://www.kenall.com/patents). Content of specification sheets is subject to change; please consult [www.kenall.com](http://www.kenall.com) for current product details. ©2019 Kenall Mfg. Co.