

# MEDMASTER™

## MPWUD SERIES with BIOS SkyBlue™

### PRODUCT FEATURES:

- » Surface wall mount luminaire with bi-directional illumination for ambient/reading functionality
- » Features BIOS SkyBlue Technology to benefit daytime alertness, cognition, mood and circadian rhythms
- » High R9 value and High CRI provide biologically optimized LED spectrum for early detection of cyanosis.
- » Standard antimicrobial finish

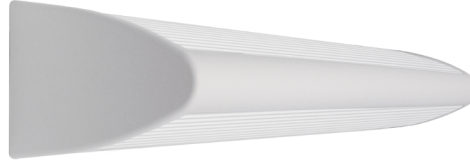

### SPECIFICATIONS

**HOUSING:** Extruded marine grade aluminum body with die-cast end caps and attached to mounted baseplate. Housing secured with countersunk fasteners. White TGIC polyester powder coat – 5-stage pre-treatment. Salt spray test: 1,000 hours; Reflectance: 92%. Matte white antimicrobial finish standard on exposed surfaces of installed luminaire.

**BASEPLATE:** 16-gauge CRS baseplate provided with four-point (24" housing) or six-point (36" housing) mounting holes and one wireway hole. TGIC polyester powder coat – 5-stage pre-treatment. Salt spray test: 1,000 hours; Reflectance: 92%.

**OPTIC:** Extruded high-efficiency diffused, impact-resistant acrylic lens.

**LED MODULE:** Serviceable static, dynamic or tunable mid-power Gen 2 BIOS Biological LED modules. Biological Static, Biological Dynamic, and Biological Tunable LED source with blue spectrum peak at 490nm and higher melanopic ratio. CRI 80+ with R9 > 90. Dynamic features 500K downward CCT shift when dimmed for evening applications requiring lower melanopic ratio. Tunable features 2700K CCT for evening applications. Refer to table for specific melanopic values.

**DRIVER/CONTROL:** 120-277VAC, 50/60Hz electrical input (PF ≥ 0.9, THD < 20%). **Biological Static:** Serviceable, constant-current single channel driver with single analog (0-10V) control input for intensity. 1-100% range with dim to dark capabilities and a linear dimming curve. **Biological Dynamic:** Serviceable constant-current driver with the BIOS Dynamic Bio-Dimming™ module keeps light output constant while reducing melanopic lux. Single analog (0-10V) control input. 1-100% dimming range with dim-to-dark capabilities and a linear dimming curve. Dimming from 100-75% reduces CCT by 500K, dimming below 75% reduces light level. **Biological Tunable:** Serviceable, constant-current multi-channel programmable driver with dual analog (0-10V) control inputs for intensity and CCT. Optional DALI (Type 8) driver. Logarithmic intensity profile with 0.1-100% range, with dim-to-dark capabilities. Linear profile on CCT adjustment.

**INSTALLATION:** Surface, wall-mount. Four-point mounting on 24"; Six-point mounting on 48".

**WARRANTY:** Limited five (5) year warranty.

**LISTINGS:** Luminaire is certified to UL standards by Intertek Testing Laboratories for Damp Locations. Certified by independent lab to meet OSHPD seismic loading standard. Pre-approved by OSHPD for installation in California healthcare facilities.



### ORDERING INFORMATION (Ex: MPWUD-48-MW-1/1-45B-35K8-DIM1-DV)

Model	Length	Finish	Lens Type	Lamp Configuration	Lamp Power	Lamp Color	Driver	Voltage	Options
<b>MPWUD</b>			<b>FA</b>						

#### Nominal Length

24	24" Nominal
48	48" Nominal

#### Finish

<b>MW</b>	Matte White (Antimicrobial finish)
<b>CC</b>	Custom Color (Consult Factory)

#### Lens Type

<b>FA</b>	Frost Acrylic
-----------	---------------

#### Lamp Configuration

<b>1/1</b>	1 Up/1 Down
<b>1/0</b>	1 Up/0 Down (solid bottom)
<b>0/1</b>	0 Up/1 Down (solid top)

#### Lamp Power

<b>25B</b>	25 Watt BIOS
<b>45B</b>	45 Watt BIOS

#### Lamp Color

<b>35K8</b>	3500K SkyBlue / 80CRI min / R9 90+
<b>40K8</b>	4000K SkyBlue / 80CRI min / R9 90+

#### Driver Type

<b>DIM1</b>	BIOS Biological Static with 0-10V Dimming to 1% with Dim-to-Dark Capabilities
<b>BIODIM1+</b>	BIOS Biological Dynamic with 0-10V Intensity Dimming to 1% and Dim-to-Dark Capabilities
<b>ATW+</b>	BIOS Biological Tunable White with 0-10V Control of Intensity and CCT independently on 2 separate channels
<b>DTW+</b>	BIOS Biological Tunable White with DALI Control of Intensity and CCT independently on 2 separate channels

#### Input Voltage

<b>DV</b>	120-277 Volts
<b>120</b>	120 Volts

#### Options

<b>NLWL</b> <sup>^</sup>	2700K LED Night Light, Left Side
<b>NLWR</b> <sup>^</sup>	2700K LED Night Light, Right Side
<b>NLAL</b> <sup>^</sup>	Amber LED Night Light, Left Side
<b>NLAR</b> <sup>^</sup>	Amber LED Night Light, Right Side
<b>LEL</b> <sup>++</sup>	Emergency Battery Pack
<b>ES</b>	Emergency Shut-Off Switch (120V rated)
<b>FS</b>	Fuse & Holder
<b>LVC</b> <sup>†</sup>	Low Voltage Controller (Click <a href="#">here</a> for specifications)
<b>LVCD</b> <sup>†</sup>	Low Voltage Controller with Dimming (Click <a href="#">here</a> for specifications)
<b>TR</b>	Tamper Resistant Torx® with center pin Fastener

+ n/a with 24" length

<sup>^</sup> n/a with 1/0 lamp configurations

\* 0/1 or 1/0 lamp configuration only.

<sup>†</sup> Low voltage controller wired to provide ON/OFF control (and dimming control when ordered with LVCD) via compatible wall/bed controls. Up-light function designated as "Ambient" on LVC Technical Guides. Down-light function designated as "Reading". DIM1 Driver Type only.

#### ACCESSORIES ORDERED SEPARATELY

<b>MPWS</b>	Low Voltage Wall Switch (Click <a href="#">here</a> for Specifications)
-------------	---



www.kenall.com | P: 800-4-Kenall | F: 262-891-9701 | 10200 55th Street Kenosha, Wisconsin 53144, USA

This product complies with the Buy American Act: manufactured in the United States with more than 50% of the component cost of US origin. It may be covered by patents found at www.kenall.com/patents. Content of specification sheets is subject to change; please consult www.kenall.com for current product details. ©2022 Kenall Mfg. Co.

A brand of **legrand**

# MILLENNIUM STRETCH™

## MPWUD SERIES with BIOS SkyBlue™

### DELIVERED MELANOPIC RATIO OF 35K8 BIOS

BIOS Type	Spectral Mode	Nominal CCT	Melanopic Ratio*	
			m-EER	m-DER
Biological Static	Daytime	3500K	≥0.80	≥0.72
Biological Dynamic	Daytime	3500K	≥0.80	≥0.72
	Evening	3000K	≤0.49	≤0.44
Biological Tunable	Daytime	3500K	≥0.80	≥0.72
	Evening	2700K	≤0.47	≤0.42

### DELIVERED MELANOPIC RATIO OF 40K8 BIOS

BIOS Type	Spectral Mode	Nominal CCT	Melanopic Ratio*	
			m-EER	m-DER
Biological Static	Daytime	4000K	≥0.90	≥0.81
Biological Dynamic	Daytime	4000K	≥0.90	≥0.81
	Evening	3500K	≤0.57	≤0.51
Biological Tunable	Daytime	4000K	≥0.90	≥0.81
	Evening	2700K	≤0.47	≤0.42

\*Melanopic ratios are provided in two forms: (m-EER) which is calculated using the WELL v2 methodology and the corresponding CIE melanopic Daylight Equivalent Ratio, (m-DER).

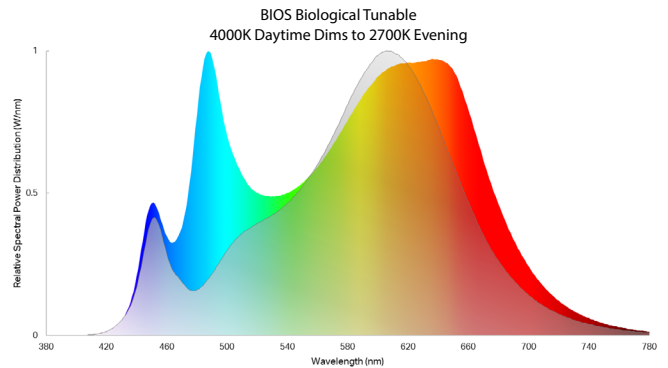
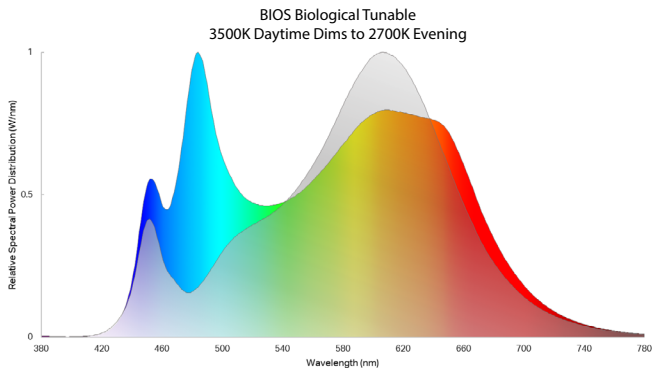
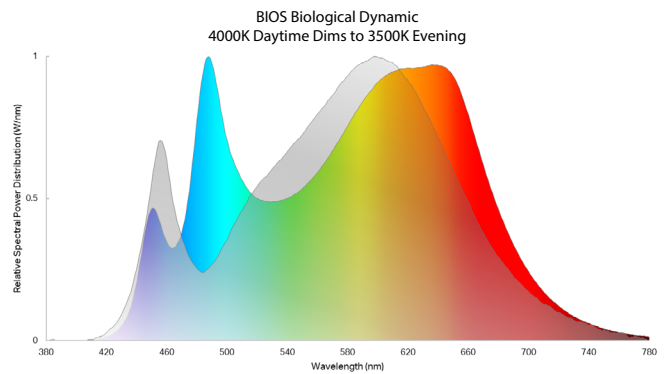
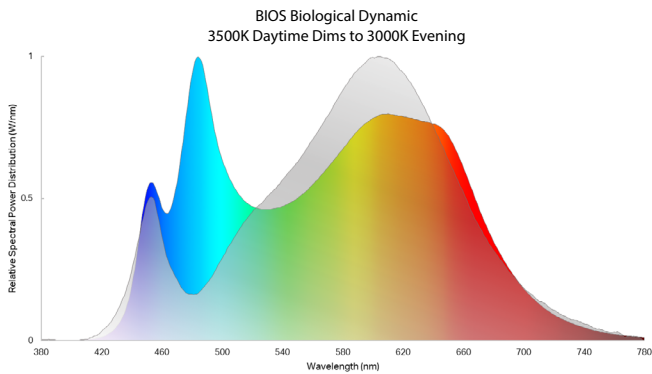
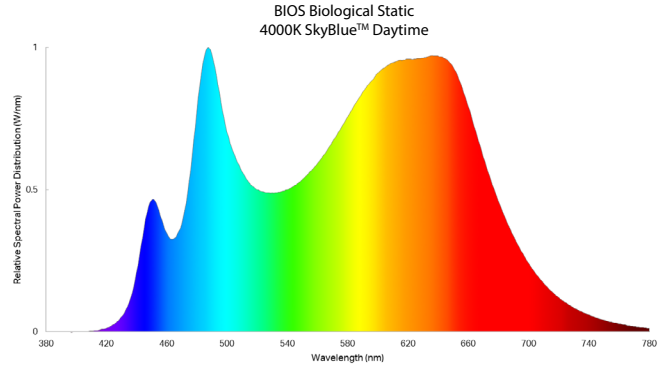
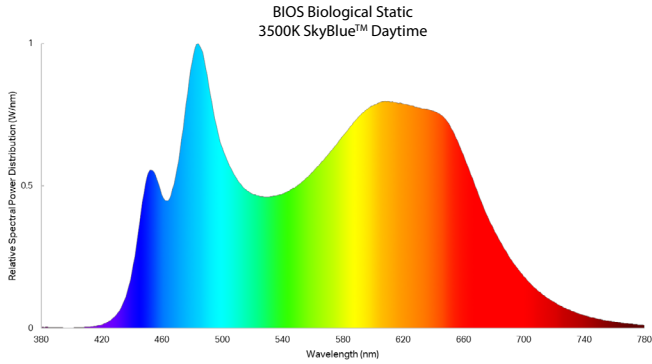

www.kenall.com | P: 800-4-Kenall | F: 262-891-9701 | 10200 55th Street Kenosha, Wisconsin 53144, USA

This product complies with the Buy American Act: manufactured in the United States with more than 50% of the component cost of US origin. It may be covered by patents found at [www.kenall.com/patents](http://www.kenall.com/patents). Content of specification sheets is subject to change; please consult [www.kenall.com](http://www.kenall.com) for current product details. ©2022 Kenall Mfg. Co.

A brand of **legand**

# MEDMASTER™

## MPWUD SERIES with BIOS SkyBlue™

### PERFORMANCE

Model	Mode	Lamp Power	Initial Delivered Lumens, by CCT (lm)		Efficacy (lm/W)	Input Power (W)	Drive Current (mA)	Estd. L <sub>70</sub> LED Life (Hrs)
			35K8	40K8				
MPWUD-24	Up Only	25B	2,524	2,741	90 - 97	28	117	80,000
	Down Only		2,459	2,670	87 - 95	28		
	Up & Down		4,911	5,332	88 - 95	56		
MPWUD-48	Up Only	45B	4,586	4,980	98 - 106	47	100	80,000
	Down Only		4,468	4,851	95 - 104	47		
	Up & Down		8,923	9,689	95 - 104	93		

Information subject to change without notice. Visit [www.kenall.com](http://www.kenall.com) for ies files additional information.

Model: MPWUD-48-yy-FA-45B-35K8-DIM1-zzz-DV

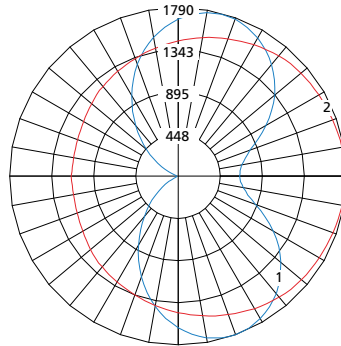

Maximum Candela = 2225 Located At Horizontal Angle = 0, Vertical Angle = 20

- 1 - Vertical Plane Through Horizontal Angles (0-180) (Through Max. Cd.)
- 2 - Horizontal Cone Through Vertical Angle (20) (Through Max. Cd.)

### DIMENSIONAL DATA

#### CROSS SECTION

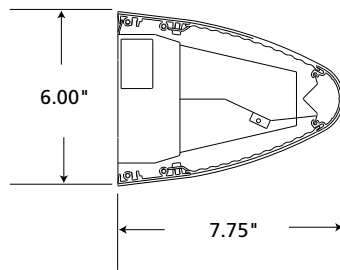

#### DIMENSIONAL DATA (IN INCHES)

	A	B	C	D	E	F
24"	3.25	n/a	n/a	21.00	25.61	6.00
48"	3.25	19.38	2.63	44.00	49.61	6.00

#### BACK VIEW

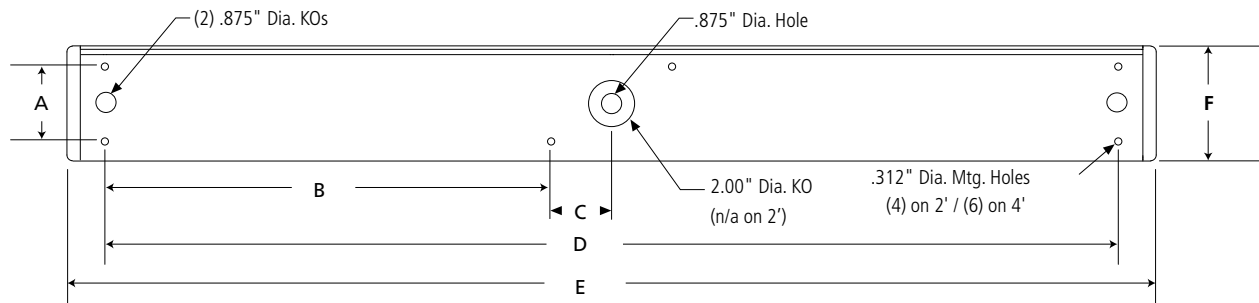

[www.kenall.com](http://www.kenall.com) | P: 800-4-Kenall | F: 262-891-9701 | 10200 55th Street Kenosha, Wisconsin 53144, USA

This product complies with the Buy American Act: manufactured in the United States with more than 50% of the component cost of US origin. It may be covered by patents found at [www.kenall.com/patents](http://www.kenall.com/patents). Content of specification sheets is subject to change; please consult [www.kenall.com](http://www.kenall.com) for current product details. ©2022 Kenall Mfg. Co.

A brand of Legrand

MPWUD-B-082222