

MILLENIUM STRETCH™

MLRS5 SERIES – CONTINUOUS ROW

PRODUCT FEATURES:

- » Surface mount – ceiling or wall; 5" x 48"
- » Extruded aluminum housing with decorative end caps
- » Low-profile –ADA compliant

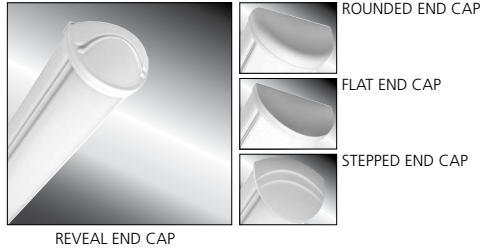

PROJECT INFORMATION	
Job Name	_____
Fixture Type	_____
Catalog Number	_____
Approved by	_____

SPECIFICATIONS

HOUSING: Marine grade aluminum. Extruded body with die-cast end caps. Housing, with end caps, post assembly TGIC polyester powder coat finished – 5-step pre-treatment. See Ordering Information for standard, optional, architectural and custom finishes. Each linear run of luminaires consists of one Beginning of Run Luminaire (B), one or multiple Middle Luminaire(s) (M), and one End of Run Luminaire (E). Specify and/or order systems per linear run (i.e. (1)B48, (5)M48, (1)E48). NOTE: Contact factory for custom lengths.

REFLECTOR: Full reflector/wire cover – 92% reflectivity.

LENS: UV-stabilized, high impact extruded clear acrylic. Smooth exterior, linear prismatic interior. Nominal thickness .156". Lens securely positioned in body channels and end caps. Lens locked in place with tamper-resistant stainless steel Torx® with center pin fasteners and sealed with closed cell gaskets.

END CAPS/JOINER BANDS: Marine grade die-cast aluminum. Four end cap styles available: Flat, Rounded, Reveal and Stepped. Conduit/Wiremold™ knockout visible only from interior of end cap (Flat and Rounded styles only).

SOCKETS: Shock-resistant sockets with internal locking collar to ensure positive lamp retention.

HARDWARE: Four stainless steel, tamper-resistant Torx® with center pin fasteners secure lens in housing body's lens channel.

ELECTRICAL: Available 3500K, 4000K and 5000K color temperatures, 82 CRI. 120-277VAC, 50/60Hz electrical input with serviceable high power factor electronic, constant-current driver (<20% THD, >0.95 PF). Standard 0-10V dimming with 3-100% range, maximum driver source of 250 µA. Consult factory for fluorescent option.

INSTALLATION: Standard four-point mounting per fixture recommended.

WARRANTY: limited ten (10) year LED warranty.

LISTINGS: Damp Location Listed to UL 1598 – corner, horizontal wall, vertical wall and pendant mount installation. See Options for Wet Location – covered ceiling mount. ADA compliant.



ORDERING INFORMATION (Ex: MLRS5S-B48-2/M48-E48-R-MW-CIA-1-54-RS-1-120-FS)

Model	Begin. Hsg.	Mid. Hsg.	End. Hsg.	End Cap	Finish	Lens	Lamp Type	Driver	Voltage	Options	
MLRS5S	B48	/M48	E48								
Beginning of Run Housing Style				Lens			Options				
B48	Nominal 48" housing			PIA	Pearlescent High Impact Acrylic			(90 Minutes; 32°F Starting Temperature)			
Middle Fixture(s) Housing Style				Lamp Type			CDF				
(replace "x" with qty)				45L35K 45 Watt 3500K LED			Captive Diffuser Fasteners				
(x)/M48 Nominal 48" housing(s)				45L40K 45 Watt 4000K LED			FS Single Fuse & Holder				
Ending of Run Housing Style				45L50K 45 Watt 5000K LED			PH Phillips Head Fasteners				
E48	Nominal 48" housing						PM§ Pendant Mount (stems by others; damp only)				
End Caps				Driver Type			WL Wet Location Rating (covered ceiling only)				
R	Rounded			DCC Dimming Constant Current			Accessories				
F	Flat			Voltage			CMB§ Corner Mount Bracket (Must be ordered with DL Option)				
RV	Reveal			120 120 Volts			9500 Torx® Screwdriver				
SP	Stepped			277 277 Volts			D-0552 Torx® Driver Bit (Required for CMB Option)				
Finish				347 347 Volts (Consult Factory)							
MW	Matte White			DV 120-277 Volts							
MB	Matte Black										
LG	Light Gray										
CC	Custom Color (Consult Factory)										



www.kenall.com | P: 800-4-Kenall | F: 262-891-9701 | 10200 55th Street Kenosha, Wisconsin 53144, USA

A brand of **legrand**

This product complies with the Buy American Act: manufactured in the United States with more than 50% of the component cost of US origin. It may be covered by patents found at www.kenall.com/patents. Content of specification sheets is subject to change; please consult www.kenall.com for current product details. ©2019 Kenall Mfg. Co.

MILLENNIUM STRETCH™

MLR55 SERIES – CONTINUOUS ROW

PERFORMANCE

Lamp Type	Initial Delivered Lumens		Input Power (W)	Drive Current (mA)	Estd. L70 LED Life (Hrs)
	@ 25°C	Efficacy (lm/W)			
45L35K	4246	85	50	94	150,000
45L40K	4526	90	50	94	150,000
45L50K	4707	94	50	94	150,000

Displayed information is for selected luminaires only. Additional wattages and color temperatures are also available. Visit www.kenall.com for additional information.

Model: MLR55-48-F-MW-PP-1-45L40K-DCC-1-DV

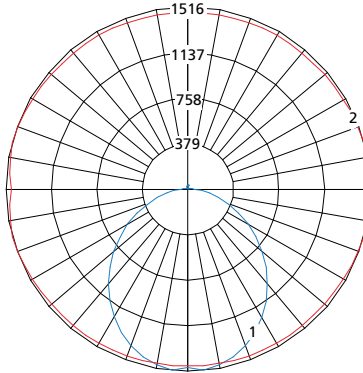

Maximum Candela = 1241 Located At Horizontal Angle = 15, Vertical Angle = 5

- 1 - Vertical Plane Through Horizontal Angles (15-195) (Through Max. Cd.)
- 2 - Horizontal Cone Through Vertical Angle (5) (Through Max. Cd.)

DIMENSIONAL DATA

CROSS SECTION/DETAILS

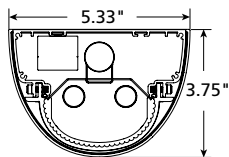

CORNER MOUNT BRACKET

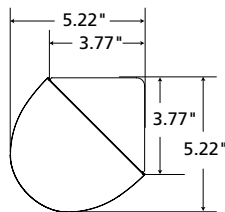

Nominal Four Foot Fixture Legend

End Cap	A	B	C	D	E1	E2	F
R	49.93	49.34	49.93	46.25	3.00	6.00	44.48
F	49.32	49.34	49.32	46.25	3.00	6.00	44.48
SP	50.73	49.34	50.73	46.25	3.00	6.00	44.48
RV	50.50	49.34	50.50	46.25	3.00	6.00	44.48

MOUNTING HOLES

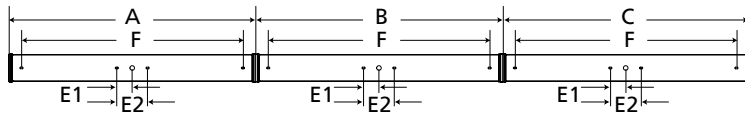

PM OPTION ONLY

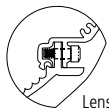
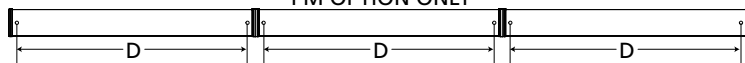

Lens Lockup Detail

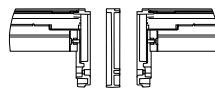

Joiner Band
(Required for row mounting - supplied)



www.kenall.com | P: 800-4-Kenall | F: 262-891-9701 | 10200 55th Street Kenosha, Wisconsin 53144, USA

A brand of Legrand

This product complies with the Buy American Act: manufactured in the United States with more than 50% of the component cost of US origin. It may be covered by patents found at www.kenall.com/patents. Content of specification sheets is subject to change; please consult www.kenall.com for current product details. ©2019 Kenall Mfg. Co.