

HELOS™ HPG14

Luminaires for Parking Garages



PRODUCT FEATURES

- Textured tertiary lens for glare reduction and up-light feature to eliminate “cave-effect”
- Outputs ranging from 3,086 lm to 12,943 lm
- Compatible with TekLink™ lighting control technology and Wattstopper FSP-600 Series



SPECIFICATIONS

HOUSING: Die-cast aluminum and UV-stabilized polycarbonate construction. Standard TGIC polyester powder coat finish on aluminum components with five-step pre-treatment to withstand 1,000 hour salt spray test per ASTM B117. See Ordering Information for available finishes. Closed-cell gasketing seals all housing component interfaces.

MOUNTING: Direct-to-Surface (DTS) mounts over recessed electrical box to ceiling, Quick-Mount (QM) mounts to either surface or recessed electrical box, Trunion Mount (TK) or pendant-mounted (PM) via ¾" rigid sealed conduit (conduit and pendant components by others). See Ordering Information for selection. Fixture weight is 7 lbs.

OPTICAL: Type V-Wide (5W), Rectangular Wide (RW) and Drive Lane (DL) optical distribution options. Light guide outer lens constructed of clear UV-stabilized polycarbonate.

ELECTRICAL: Edge-lit mid-power LED light source. See Ordering Information for color temperature options. 80 CRI minimum. Available 590nm native amber. 120-277 VAC, 347VAC and 480VAC 50/60Hz input; constant-current dimming driver; <20% THD, >0.90 PF. Minimum 83% electrical efficiency. 0-10V dimming protocol with 1-100% range and dim-to-dark capabilities, 0.2mA source current (90L lamp is 10-100% dimming with dim-to-dark capabilities, 0.45mA source current). Surge and transient protection rated at 6kV per ANSI C62.41-2002 and 10kV per ANSI C82.77-5 2015. 20kA max. transient protection (L-N). Replaceable surge suppressor. Driver is EMC compliant with FCC 47 CFR Part 15, Class B. Passes IEC 61000-4-4 EFT and IEC 61000-4-5 (Class 4) surge evaluation.

CONTROLS & SENSOR: Optional TekLink lighting control system. Optional sensor available with compatible Wattstopper or other third party controls. To see the full list of compatible controls, [click here](#).

PHOTOMETRICS: Photometry tested to the IESNA LM-79-08 standard by an ILAC/ISO17025 accredited laboratory. For additional photometric data, please go to www.kenall.com.

WARRANTY: Limited five (5) year warranty. Peace of Mind Guarantee® when ordered and installed with direct-to-surface (DTS) mounting.

LISTINGS: Luminaire is certified to UL Standards by Intertek Testing Laboratory for Wet Location. IP66 rating per IEC 60598 standard. Suitable for installation into -35°C to 40°C ambient environments, unless otherwise noted. Passes 3G vibration test per ANSI C136.31-2001. DesignLights Consortium® (DLC) Premium qualified product and DLC qualified product. Not all versions of this product may be DLC Premium qualified or DLC qualified. Visit <https://qpl.designlights.org/> to confirm qualification.

ORDERING INFORMATION (EX: HPG14-PM-MW-5W-CP-50L-40K8-DIM1-DV-FS-TL200M)

Model	Mounting	Finish	Optic	Lens Type	Lamp Power	Lamp Color	Driver Type	Voltage	Options	Accessories	Controls	Controls Kit
HPG14				CP								< >
Mounting			Lamp Color ▽			Options						
DTS	Direct-to-Surface		30K8	3000K/80CRI min	LEL* Integral 10W Emergency Battery Backup (0°C min. ambient)							
PM	Pendant Mount (by others)		35K8	3500K/80CRI min	CEL* Integral 10W Cold Weather Battery Backup (-20°C min ambient, requires separate housing enclosure - see Dimensional Data)							
TK	Trunion Kit		40K8	4000K/80CRI min	GTDU* UL924 and UL1008 Listed Switch Bypass/Lighting Transfer Switch with 0-10V Dimming Override (not available with LEL/CEL Option)							
QM	Quick Mount System		50K8	5000K/80CRI min	FS Single Fuse & Holder							
Finish			Driver Type			BG Bird Guard (DTS and QM Mounting only)						
MW	Matte White (STD)		DIM1	0-10V Dimming to 1% with Dim-to-Dark (70L max.)	Accessories							
LG	Light Gray		DIM10 ▲	0-10V Dimming to 10% with Dim-to-Dark	BD Bird Deterrent (PM and TK Mounting only)							
CC	Custom Color (consult factory)		Voltage			Controls - TekLink						
Optic Type			DV	120-277 VAC, 50/60Hz	TL50M* Non-Networked Control - Motion Only Click here for specifications							
5W	Type V - Wide Circular		347	347VAC, 60Hz	TL50DM* Non-Networked Control -Daylight Harvesting and Motion Sensing Click here for specifications							
RW	Rectangular - Wide		480	480VAC, 60Hz	TL200M* Wireless Networked Control - Motion Only Click here for specifications							
DL	Drive Lane / Type 4					TL200DM* Wireless Networked Control -Daylight Harvesting and Motion Sensing Click here for specifications						
Lens Type						TL1000* Wired Network Control - Advanced Click here for specifications						
CP	Clear Polycarbonate					TL2000* Wireless Network Control - Advanced Click here for specifications						
Lamp Power						Controls Kit						
30L	30W LED (DL optic only)					< > Factory Assigned Internal Code						
35L ^	35W LED					▲ Not available with DL optic						
40L ^	40W LED					* Not available with DL and RW optic						
50L ^	50W LED					+ DV input voltage only. Not available with 90L lamp power.						
70L *	70W LED					▲ 90L lamp only. DV input voltage only.						
90L *	90W LED					▽ Leave blank for 36NA lamp code						
36NA	36W Native Amber (5W optic only)											

PERFORMANCE

Optic		Lamp Power	Initial Delivered Lumens, By Lamp Color (lm)					Efficacy (lm/W)	Input Power (W)	TM-21 Reported L70 (hrs)	Delivered Output in LEL Battery Mode (lm)
Distribution	Lens Type		30K8	35K8	40K8	50K8	Amber				
5W	CP	35L	5,083	5,257	5,380	5,414	-	127 - 135	40	>102,000	1,350
		40L	5,741	5,938	6,076	6,116	-	126 - 135	45		
		50L	7,004	7,245	7,414	7,462	-	125 - 133	56		
		70L	9,287	9,797	10,025	10,090	-	118 - 129	78		
		90L	11,559	11,652	11,923	12,000	-	119 - 123	97		
		36NA	-	-	-	-	1,321	29	45	>60,000	290
RW	CP	35L	5,015	5,187	5,308	5,342	-	123 - 131	41	>102,000	1,310
		40L	5,642	5,836	5,971	6,010	-	122 - 130	46		
		50L	6,821	7,055	7,219	7,266	-	119 - 127	57		
DL	CP	30L	3,941	4,077	4,172	4,199	-	110 - 117	36	>102,000	1,170

 Information above is subject to change without notice. Visit www.kenall.com for IES files and additional information.

Model: HPG14-www-xx-5W-CP-70L-40K8-DIM1-yyy-zzzz

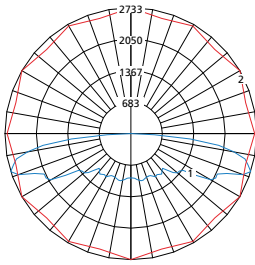
 Max Candela = 2733 Located At Horizontal Angle = 30, Vertical Angle = 72.5
 1 - Vertical Plane Through Horizontal Angles (30 - 210) (Through Max. Cd.)
 2 - Horizontal Cone Through Vertical Angle (72.5) (Through Max. Cd.)

Model: HPG14-www-xx-RW-CP-50L-40K8-DIM1-yyy-zzzz

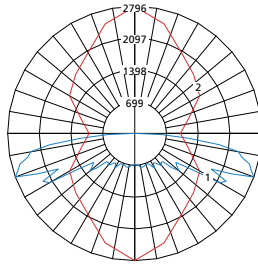
 Max Candela = 2796 Located At Horizontal Angle = 90, Vertical Angle = 70
 1 - Vertical Plane Through Horizontal Angles (90 - 270) (Through Max. Cd.)
 2 - Horizontal Cone Through Vertical Angle (70) (Through Max. Cd.)

Model: HPG14-www-xx-DL-CP-30L-40K8-DIM1-www-zzzz

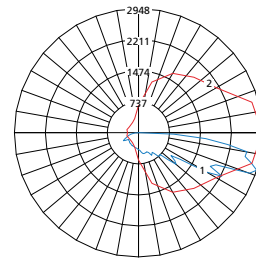

 Max Candela = 2948 Located At Horizontal Angle = 0, Vertical Angle = 72.5
 1 - Vertical Plane Through Horizontal Angles (0 - 180) (Through Max. Cd.)
 2 - Horizontal Cone Through Vertical Angle (72.5) (Through Max. Cd.)

LUMEN AMBIENT TEMPERATURE (LAT) FACTORS

Avg. Ambient Temperature	10°C	15°C	20°C	25°C	30°C	35°C	40°C
Lumen Output Factor	1.03	1.02	1.01	1	0.99	0.98	0.97

MOUNTING DIMENSIONAL DATA

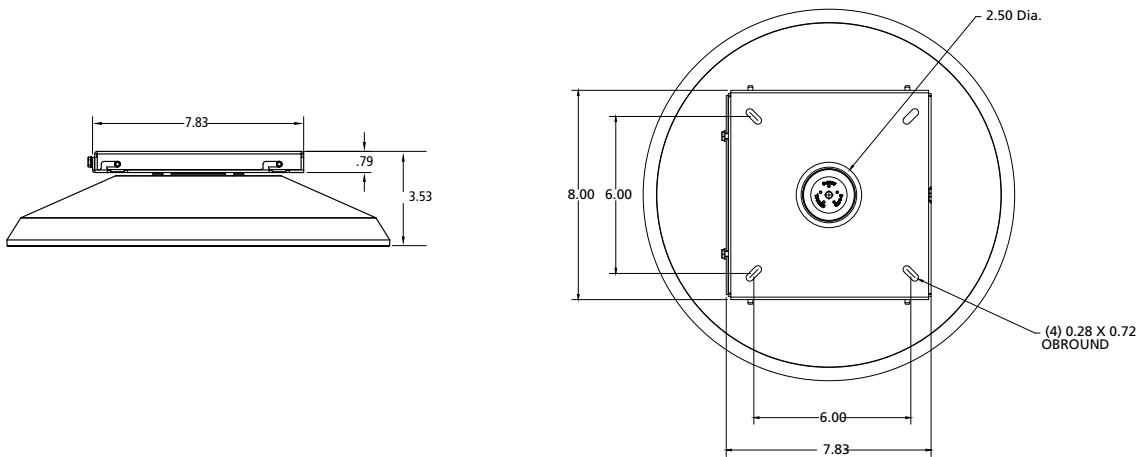
Direct-to-Surface



Quick Mount System

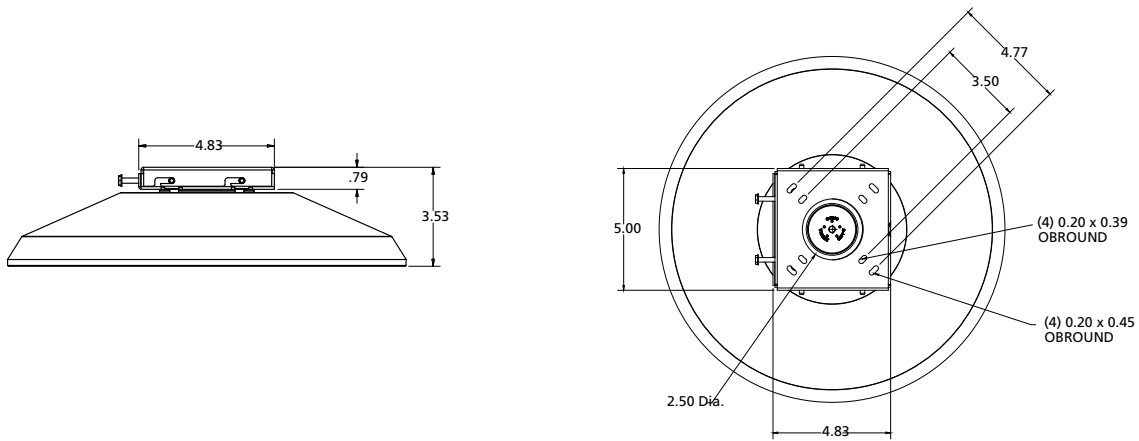

Pendant Mount

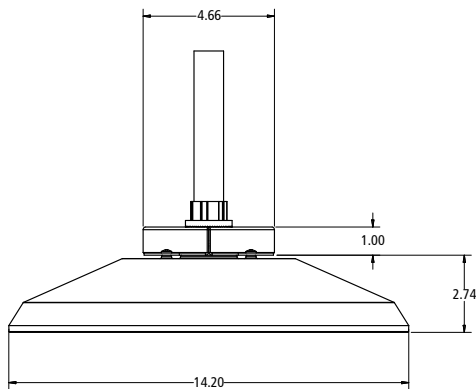

Trunnion Kit

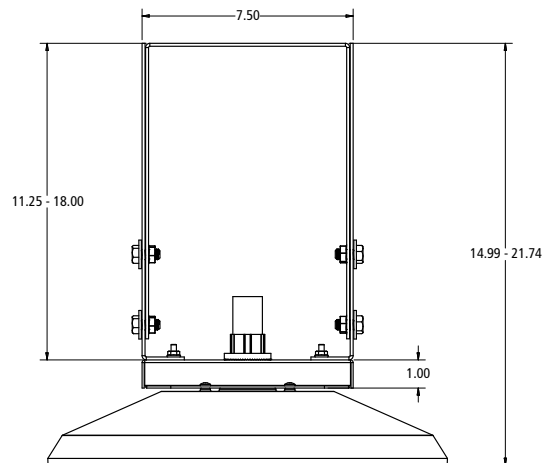

OPTIONS DIMENSIONAL DATA

Direct-to-Surface with CEL Option

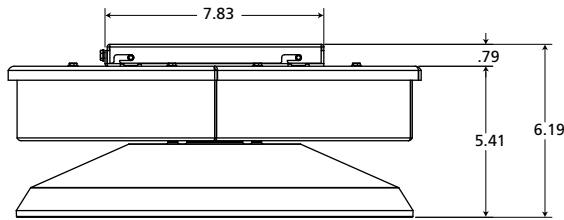

Quick Mount with CEL Option

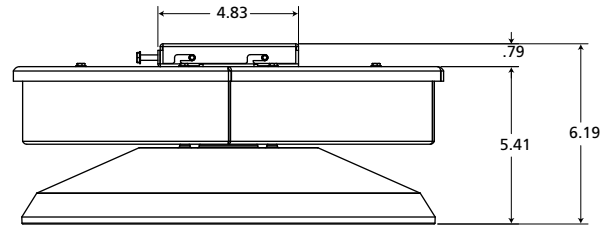

Pendant Mount with CEL Option

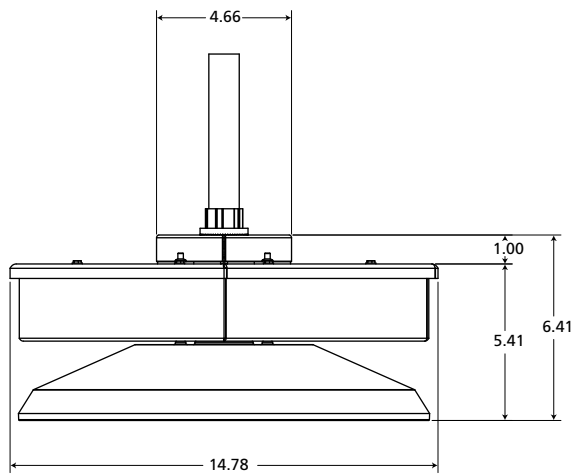

Trunnion Kit with CEL Option

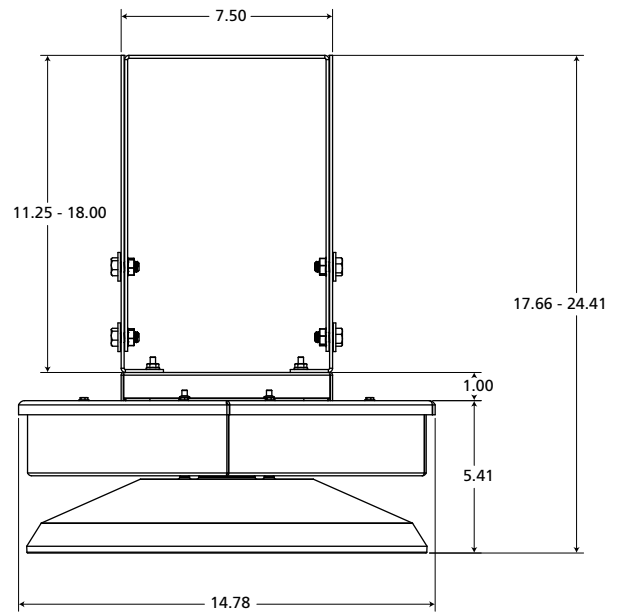

OPTIONS WATTSTOPPER CONTROLS

Wireless System: Smart and Simple
Wattstopper PLUS

The FSP-600 series by Wattstopper PLUS is an integrated, luminaire level lighting controller and sensor for indoor/outdoor lighting applications that require networked wireless control. The FSP-600 series is designed to integrate directly into exterior, high bay, parking garage, and general site lighting solutions. Each FSP-600 supports 0-10V continuous dimming, occupancy sensing and daylight control.

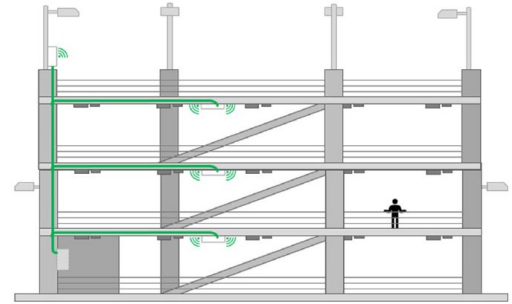

Ideal Wireless Manager Locations in Parking Structure



HPG14 SERIES

Other Available Products



SPG SERIES



MOS SERIES



TD SERIES



TES SERIES

Coverage Patterns

FSP-L2 top and side coverage patterns

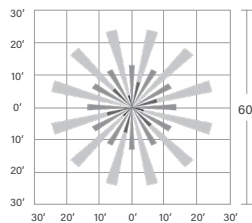

Wattstopper PLUS FSP-600 series Wireless Sensor

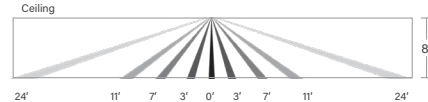

FSP-L3 top and side coverage patterns

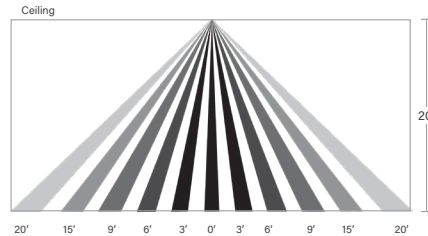
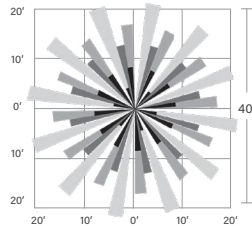

FSP-L7 top and side coverage patterns

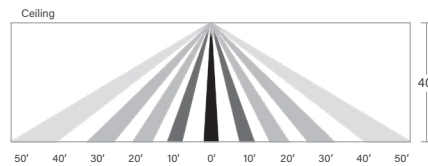
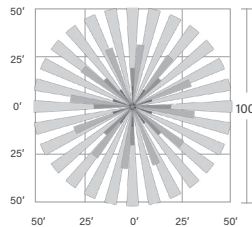

FSP-600 series by Wattstopper PLUS Features and Benefits

- High- and low-mounted solution designed for industrial & outdoor environments
- All-in-one control with 0-10V continuous dimming, occupancy and daylighting
- Load and zone-based control to meet advanced energy codes
- Multiple lens options to meet a variety of mounting heights and coverage needed
- Programmable parameters include scheduling, grouping, time delay, high/low/off, time clock, and many more.
- Seamless integration into the Wattstopper PLUS lighting control platform
- Out-of-the-box functionality
- Data insights via Polaris Monitor software
- Included in Wattstopper's OEM Partner Program
- End-of-line testing features make install easy and 'touchless' on the factory floor

For additional FSP-600 resources [click here](#).

OPTIONS WATTSTOPPER CONTROLS

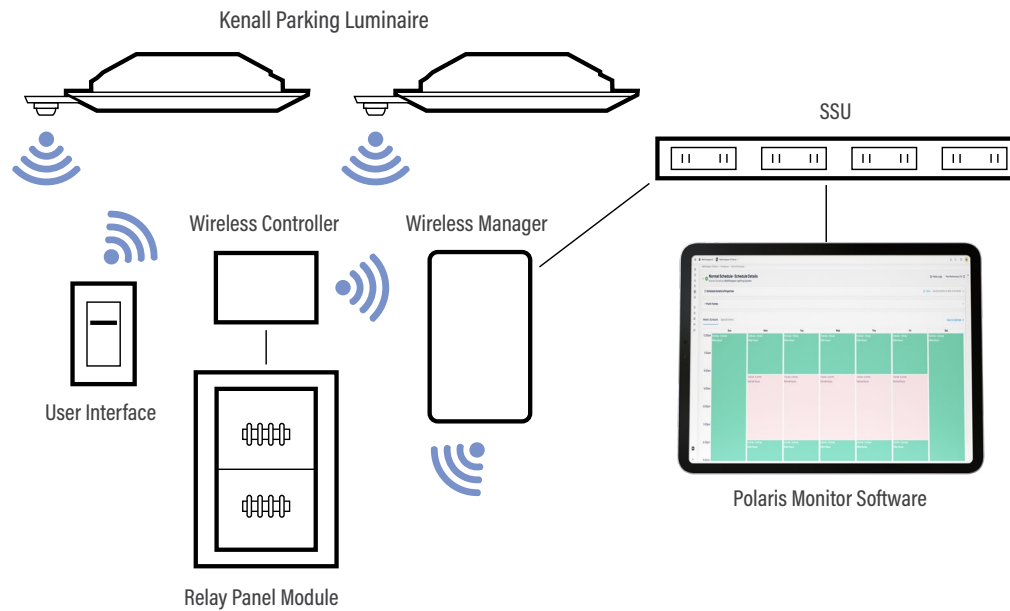

Initial Power Up and Other Settings

Factory default setting is 100% light output until the FSP-600 is commissioned into the Wattstopper Plus network.

The FSP-600 series commissioning process is similar to existing PLUS devices, Polaris config software supports the following capabilities:

- Control loads individually or as a group
- Event scheduling using astronomical or time of day
- Occupancy sensing to turn loads on or off and dim to a level using ramp up or fade down timers.

Polaris software supports the ability to monitor power and energy calculations based on schedules, occupancy, and load usage.

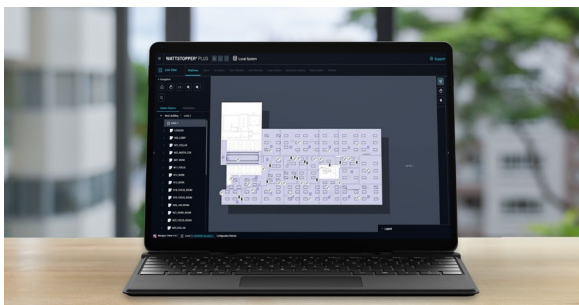

Bringing Visibility & Control to Wattstopper PLUS

Polaris software is at the core of Wattstopper PLUS — empowering facility managers and enabling the Wattstopper Experience. The advanced Polaris Monitor software is intuitive and easy to use thanks to new workflows, multi-device access, and other enhancements.