

# MILLENIUM FREESCALE™

## FS1212 SERIES

### PRODUCT FEATURES:

- » Surface mount – wall or ceiling; 15"W×15"H×8"D
- » Marine grade aluminum baseplate
- » Round or Triangle 100% DR acrylic lens options with multiple Lens Frames
- » UL certified IP65 per IEC 60598



FS1212R



FS1212T

### PROJECT INFORMATION

Job Name \_\_\_\_\_

Fixture Type \_\_\_\_\_

Catalog Number \_\_\_\_\_

Approved by \_\_\_\_\_

### SPECIFICATIONS

**BASEPLATE:** Die-formed marine grade aluminum; welded corners. Baseplate provided with four-point mounting holes, one wireway hole – see cross section at right. TGIC Polyester powder coat – 5-stage pre-treatment; Salt spray test: 1,000 hours.

**REFLECTOR:** Die-formed marine grade aluminum. Full reflector/wire cover – 92% reflectivity.

**LENS:** UV-stabilized, high impact resistant, pressure formed pearlescent 100% DR/acrylic. Nominal thickness .125". Lens secured in place by lens frame and sealed to baseplate with closed cell silicone gasket.

**LENS FRAME/CROSS BARS:** Marine grade aluminum; secured to baseplate with tamper-resistant stainless steel Torx® fasteners. Cross bars nominal thickness .25". Post assembly TGIC polyester powder coat – 5-stage pre-treatment; Salt spray test: 1,000 hours. Optional perf insert 30% open, stainless steel. See Ordering Information for finishes.

**HARDWARE:** Four stainless steel Torx® fasteners. Internal brackets and fasteners are non-corrosive. Surface Conduit Adapter (SCA) accessory – stainless steel trim frame assembly with integral J-box; finished to match lens frame (not available with CA finish). Watertight conduit fittings supplied by others. Rough Service Adapter (RSA) accessory – stainless steel plate (adds .625" height) finished to match lens frame (not available with CA finish). Stainless steel fasteners provided for mounting fixture to RSA or SCA.

**ELECTRICAL:** Available 3500K, 4000K and 5000K color temperatures, 82 CRI. 120-277VAC, 50/60Hz electrical input with serviceable high power factor electronic, constant-current driver (<20% THD, >0.95 PF). Standard 0-10V dimming with 10-100% range, maximum driver source of 500 µA.

**INSTALLATION:** Standard four-point mounting required for Peace of Mind Guarantee®.

**PHOTOMETRICS:** Photometry tested to the IESNA LM-79-08 standard by an ILAC/ISO17025 accredited laboratory. For photometric information, go to [www.kenall.com](http://www.kenall.com).

**WARRANTY:** Limited five (5) year LED warranty.

**LISTINGS:** UL and CUL listed for Wet Location. UL certified IP65 per IEC 60598.



### ORDERING INFORMATION (Ex: FS1212R-2M-PIA-BR-25L40K-1-120-FS)

Model	Lens Frame	Lens Type	Finish	Lamp Type	Lamp Qty	Voltage	Options	Accessories
					<b>1</b>			
<b>Model</b>				<b>Lamp Type</b>			<b>Options</b>	
FS1212R Round				25L35K 25 Watt 3500K LED			FS Single Fuse & Holder (n/a w/347V)	
FS1212T Triangle				25L40K 25 Watt 4000K LED			PH Phillips Head Fasteners	
				25L50K 25 Watt 5000K LED			PC▼ Photo Control with deep housing surface adapter (120V or 277V only)	
<b>Lens Frame</b>				<b>Lamp Quantity</b>			<b>Accessories</b>	
0 No Bars				1 One Lamp			SCA▼ Surface Conduit Adapter	
1M One Bar – Middle							RSA▼ Rough Surface Adapter	
2M Two Bars – Middle							9500 Torx® Screwdriver	
2TB Two Bars – Top & Bottom				<b>Voltage</b>			D-0552 Torx® Driver Bit	
2TBP Two Horizontal Bars w/Perf				120 120 Volts				
3E Three Bars – Even Spaced				277 277 Volts				
				347 347 Volts				
<b>Lens Type</b>				DV 120-277 Volts, electronic ballasts only				▼ n/a with option(s) that require deep housing surface adapter
PIA Pearlescent High Impact 100% DR Acrylic								
MPA Matte Pearlescent High Impact 100% DR Acrylic								
<b>Finish</b>								
BR Bronze								
CS Cool Satin Aluminum								
DB Dark Bronze								
FG Forest Green								
LG Light Gray								
MB Matte Black								
MW Matte White								
WS Warm Satin Aluminum								
CC Custom Color (Consult factory)								

### LENS FRAME

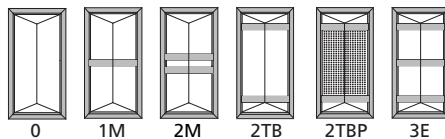

[www.kenall.com](http://www.kenall.com) | P: 800-4-Kenall | F: 262-891-9701 | 10200 55th Street Kenosha, Wisconsin 53144, USA

A brand of **legrand**

This product complies with the Buy American Act: manufactured in the United States with more than 50% of the component cost of US origin. It may be covered by patents found at [www.kenall.com/patents](http://www.kenall.com/patents). Content of specification sheets is subject to change; please consult [www.kenall.com](http://www.kenall.com) for current product details. ©2019 Kenall Mfg. Co.

# MILLENNIUM FREESCALE™

## FS1212 SERIES – Technical Data

### PERFORMANCE

Lamp Type	Initial Delivered Lumens		Input Power (W)	Drive Current (mA)	Estd. L70 LED Life (Hrs)
	@ 25°C	Efficacy (lm/W)			
25L35K	1848	64	29	94	80,000
25L40K	1970	68	29	94	80,000
25L50K	2049	71	29	94	80,000

Displayed info is for PIA lens only. Infor subject to change. Visit [www.kenall.com](http://www.kenall.com) for IES files and additional information.

Model: FS1212T-2TB-PIA-MB-25L40K-DV

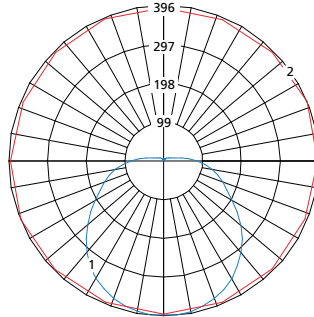

Maximum Candela = 396 Located At Horizontal Angle = 22.5, Vertical Angle = 5

- 1 - Vertical Plane Through Horizontal Angles (22.5-202.5) (Through Max. Cd.)
- 2 - Horizontal Cone Through Vertical Angle (5) (Through Max. Cd.)

### DIMENSIONAL DATA

#### FS1212R CROSS SECTION

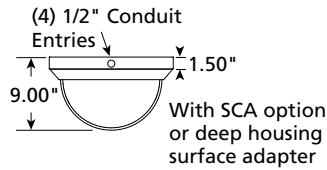
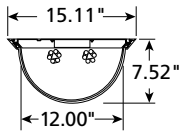

#### FS1212T CROSS SECTION

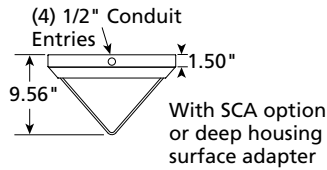
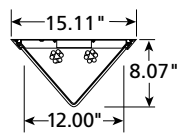

#### BACK VIEW

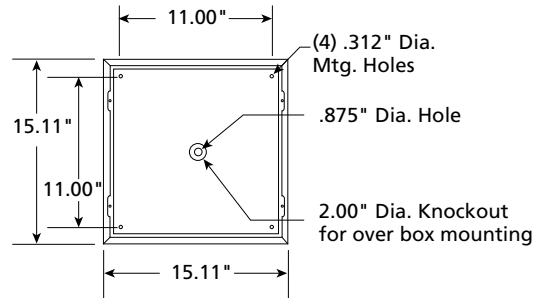

[www.kenall.com](http://www.kenall.com) | P: 800-4-Kenall | F: 262-891-9701 | 10200 55th Street Kenosha, Wisconsin 53144, USA

A brand of **Legrand**

This product complies with the Buy American Act: manufactured in the United States with more than 50% of the component cost of US origin. It may be covered by patents found at [www.kenall.com/patents](http://www.kenall.com/patents). Content of specification sheets is subject to change; please consult [www.kenall.com](http://www.kenall.com) for current product details. ©2019 Kenall Mfg. Co.