

MILLENIUM FINITE™

FNL6S SERIES – CONTINUOUS ROW

PRODUCT FEATURES:

- » Surface mount – wall; 6" x 48"
- » Extruded aluminum housing with die-cast end caps
- » Peace of Mind Guarantee® against breakage



PROJECT INFORMATION

Job Name _____

Fixture Type _____

Catalog Number _____

Approved by _____



Continuous Row End cap

SPECIFICATIONS

HOUSING: Marine grade aluminum. Extruded body with die-cast end caps. Post assembly TGIC polyester powder coat finished – 5-step pre-treatment. Each linear run of luminaires consists of one Beginning of Run Luminaire (B), Zero, one or multiple Middle Luminaire(s) (M), and one End of Run Luminaire (E). Specify and/or order systems per linear run (i.e. (1)B48, (5)M48, (1)E48).
NOTE: Contact factory for custom lengths.

REFLECTOR: Full reflector/wire cover – 92% reflectivity.

LENS: UV-stabilized high impact pearlescent polycarbonate. Symmetric optic includes diffuse, impact-resistant acrylic lens. Smooth exterior. Nominal thickness 0.125". Sealed with closed cell gaskets.

SOCKETS: Shock-resistant sockets with internal locking collar to ensure positive lamp retention.

Electrical: Available 3500K, 4000K and 5000K color temperatures, 82 CRI. 120-277VAC, 50/60Hz electrical input with serviceable high power factor electronic, constant-current driver (<20% THD, >0.95 PF). Standard 0-10V dimming with 1-100% range and dim-to-dark capabilities; 165 µA max. source current per 48" section. Optional embedded microwave motion sensor (MS) has factory default settings of 20 minute time out, dims down to 30%. Consult factory for fluorescent option.

INSTALLATION: 16-gauge stainless steel quick mount plate bolts to wall (fasteners by other), fixture attaches to mounting plate with quick mounting hook-and-lock mechanism and locked into place with captive Torx® (or optional Phillips head) screws, which are concealed but accessible from bottom.

PHOTOMETRICS: Photometry tested to the IESNA LM-79-08 standard by an ILAC/ISO17025 accredited laboratory. For additional photometric information, go to www.kenall.com.

WARRANTY: Limited five (5) year LED warranty.

LISTINGS: Luminaire is certified to UL Standards by Intertek Testing Laboratory for Wet Location. ETL certified IP64 per IEC 60598. IESNA-designated full cut-off.



ORDERING INFORMATION (Ex: FNL6S-B48-1M48-E48-MB-PP-1-45L40K-DCC-1-DV-FS)

Model	Begin. Hsg	Mid. Hsg	End. Hsg	Finish	Lens	Lamp Type	Driver	Voltage	Options	Accessories
FNL6S	B48	/M48	E48				DCC			

Beginning of Run Housing Style

B48 Nominal 48" housing

Middle Fixture(s) Housing Style

(replace "x" with qty)

(x)/M48 Nominal 48" housing(s)

Ending of Run Housing Style

E48 Nominal 48" housing

Finish

- MW** Matte White
- MB** Matte Black
- DB** Dark Bronze
- CC** Custom Color
(Consult Factory)

Lens

- PP** Pearlescent Polycarbonate
- SYM** Symmetric, Diffused DR Acrylic

Lamp Type (Cross Section)

- 1-45L35K** 45 Watt 3500K LED
- 1-45L40K** 45 Watt 4000K LED
- 1-45L50K** 45 Watt 5000K LED

Driver Type

- DCC** Dimming Constant Current Driver)

Voltage

- 120** 120 Volts
- 277** 277 Volts

Options

- LEL**† LED Emergency Battery Backup
- BPC** Button Photocell
- FS** Single Fuse & Holder
- PH** Phillips Head Fasteners
- MS** Motion Sensor

Accessories

- 9500** Torx® Screwdriver
- D-0552** Torx® Driver Bit

† LEL option adds 13.78" to length of fixture

‡ Peace of Mind Guarantee not included



www.kenall.com | P: 800-4-Kenall | F: 262-891-9701 | 10200 55th Street Kenosha, Wisconsin 53144, USA

A brand of **legrand**

This product complies with the Buy American Act: manufactured in the United States with more than 50% of the component cost of US origin. It may be covered by patents found at www.kenall.com/patents. Content of specification sheets is subject to change; please consult www.kenall.com for current product details. ©2019 Kenall Mfg. Co.

MILLENIUM FINITE™

FNL SERIES – Technical Data

PERFORMANCE

Length	Lamp Type	Initial Delivered Lumens		Input Power (W)	Drive Current (mA)	Estd. L70 LED Life (Hrs)
		@ 25°C (lm)	Efficacy (lm/W)			
48	45L35K	4138	84	49	94	80,000
	45L40K	4412	90	49	94	80,000
	45L50K	4588	94	49	94	80,000

Displayed information above is for PP Lens type only. Info subject to change. Visit www.kenall.com for IES files and additional information.

Model: FNL6-48-MW-SYM-45L40K-DCC-DV

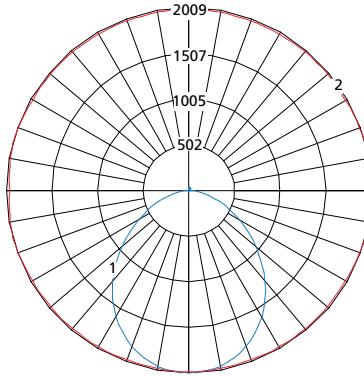

Maximum Candela = 2009 Located At Horizontal Angle = 15, Vertical Angle = 2.5

- 1 - Vertical Plane Through Horizontal Angles (15-195) (Through Max. Cd.)
- 2 - Horizontal Cone Through Vertical Angle (2.5) (Through Max. Cd.)

DIMENSIONAL DATA

CROSS SECTION/DETAILS

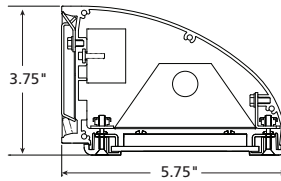

CROSS SECTION/JOINER ENDCAP

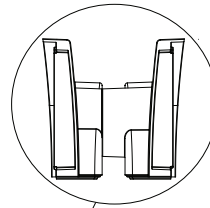

MOUNTING HOLES

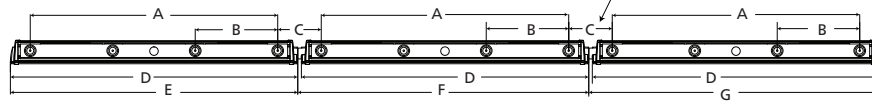

Nominal Four Foot Fixture Legend

A	B	C	D	E	F	G
40.50	42.00	14.00	7.50	48.88	48.90	49.50
	13.50	7.13	47.00	47.03	47.62	47.58

EL Housing T8 - Beginning

Standard T8 - Middle

Standard T8 - End

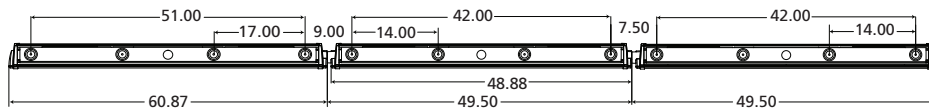

www.kenall.com | P: 800-4-Kenall | F: 262-891-9701 | 10200 55th Street Kenosha, Wisconsin 53144, USA

A brand of **legrand**

This product complies with the Buy American Act: manufactured in the United States with more than 50% of the component cost of US origin. It may be covered by patents found at www.kenall.com/patents. Content of specification sheets is subject to change; please consult www.kenall.com for current product details. ©2019 Kenall Mfg. Co.