

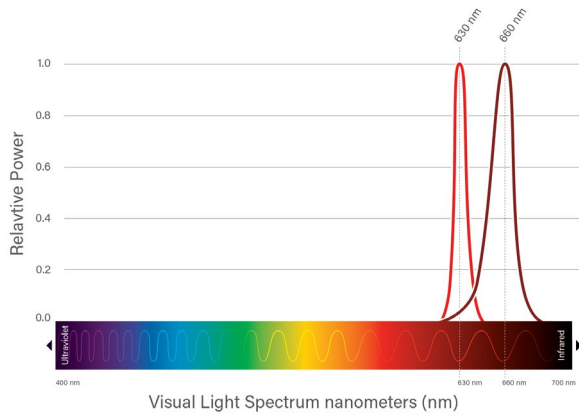

**PERFORMANCE**

Size	Lamp Code	Lamp Description	Color Lamp Types Initial Delivered Performance			Tunable White Initial Delivered Performance at 4000K Tuning			TM-21 Reported L70 (hrs)
			Lumen Output (lm)	Efficacy (lm/W)	Input Power (W)	Lumen Output (lm)	Efficacy (lm/W)	Input Power (W)	
1 x 4	22R/44T	630 nm Native Red / TW	1,425	52	27	6,174	119	52	>60K / >102K
	22R/63T		1,425	52	27	8,790	119	74	
2 x 2	22R/44T	630 nm Native Red / TW	1,451	54	27	6,267	121	52	>60K / >102K
	22R/63T		1,451	54	27	8,922	119	75	
2 x 4	22R/44T	630 nm Native Red / TW	1,565	58	27	6,917	134	52	>60K / >102K
	22R/63T		1,565	58	27	9,847	133	74	
	22R/80T		1,565	58	27	12,289	132	93	
	54DR/44T	660 nm Native Deep Red / TW	1,103	18	62	6,917	134	52	>54K / >102K
	54DR/63T		1,103	18	62	9,847	133	74	
	54DR/80T		1,103	18	62	12,289	132	93	

**NOTE:** Information subject to change without notice. All testing conducted by an ILAC/ISO17025 accredited laboratory. Please visit [www.kenall.com](http://www.kenall.com) for IES files and additional information.

**Narrow Spectrum Performance Chart**

Model: CSEDI-14-pp-22R\_qq-27\_50K9-ATW-DV-uu-vv-SYM-xx-yy-zz Native Red on

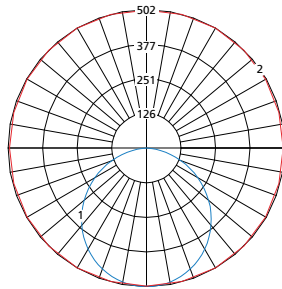

Max Candela = 498 Located At Horizontal Angle = 60, Vertical Angle = 2.5  
 1 - Vertical Plane Through Horizontal Angles (60 - 240) (Through Max. Cd.)  
 2 - Horizontal Cone Through Vertical Angle (2.5) (Through Max. Cd.)

Model: CSEDI-22-pp-22R\_qq-27\_50K9-ATW-DV-uu-vv-SYM-xx-yy-zz Native Red on

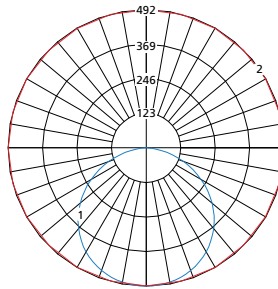

Max Candela = 490 Located At Horizontal Angle = 0, Vertical Angle = 2.5  
 1 - Vertical Plane Through Horizontal Angles (0 - 180) (Through Max. Cd.)  
 2 - Horizontal Cone Through Vertical Angle (2.5) (Through Max. Cd.)

Model: CSEDI-24-pp-54DR\_qq-27\_50K9-ATW-DV-uu-vv-SYM-xx-yy-zz Native Deep Red on

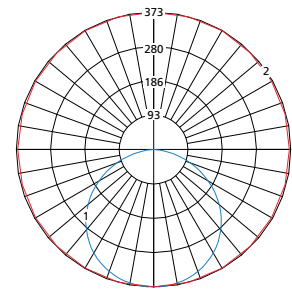

Max Candela = 366 Located At Horizontal Angle = 90, Vertical Angle = 2.5  
 1 - Vertical Plane Through Horizontal Angles (90 - 270) (Through Max. Cd.)  
 2 - Horizontal Cone Through Vertical Angle (2.5) (Through Max. Cd.)

Model: CSEDI-14-pp-qq\_63T-27\_50K9-ATW-DV-uu-vv-SYM-xx-yy-zz TW on

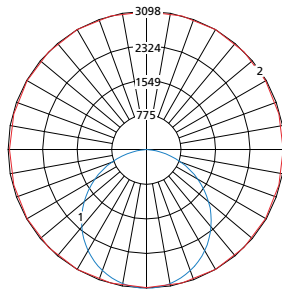

Max Candela = 3098 Located At Horizontal Angle = 60, Vertical Angle = 2.5  
 1 - Vertical Plane Through Horizontal Angles (60 - 240) (Through Max. Cd.)  
 2 - Horizontal Cone Through Vertical Angle (2.5) (Through Max. Cd.)

Model: CSEDI-22-pp-qq\_63T-27\_50K9-ATW-DV-uu-vv-SYM-xx-yy-zz TW on

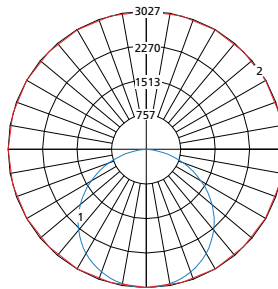

Max Candela = 3015 Located At Horizontal Angle = 0, Vertical Angle = 2.5  
 1 - Vertical Plane Through Horizontal Angles (0 - 180) (Through Max. Cd.)  
 2 - Horizontal Cone Through Vertical Angle (2.5) (Through Max. Cd.)

Model: CSEDI-24-pp-qq\_80T-27\_50K9-ATW-DV-uu-vv-SYM-xx-yy-zz TW on

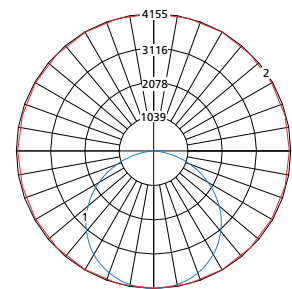

Max Candela = 4076 Located At Horizontal Angle = 90, Vertical Angle = 2.5  
 1 - Vertical Plane Through Horizontal Angles (90 - 270) (Through Max. Cd.)  
 2 - Horizontal Cone Through Vertical Angle (2.5) (Through Max. Cd.)

**DIMENSIONAL DATA**

**GASKET PROFILE**

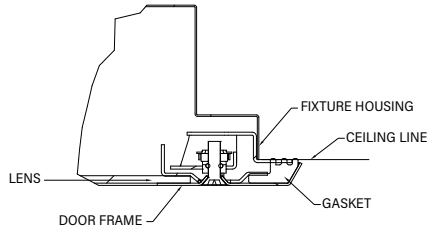

**CROSS SECTION**

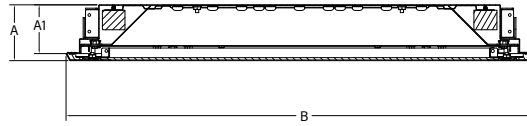

**CEILING CUTOUT**

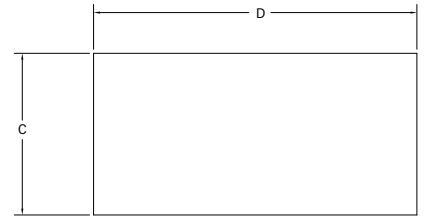

**DIMENSIONAL DATA (IN INCHES)**

	A	A1	B	C*	D*
1x4	2.82	2.50	11.94 x 47.94	10.85	46.85
2x2	2.82	2.50	23.94 x 23.94	22.85	22.85
2x4	2.82	2.50	23.94 x 47.94	22.85	46.85

\* Add .375" to ceiling cut out dimensions when IF Option is specified