

SHERIFF™

SH8 SERIES

PRODUCT FEATURES:

- » Surface mount – wall or ceiling; 8"×24", 8"×36", 8"×48"
- » ADA Compliant
- » 16-gauge cold rolled steel baseplate with seam welded end caps
- » P12 polycarbonate wraparound lens
- » Peace of Mind Guarantee® against breakage



PROJECT INFORMATION

Job Name _____

Fixture Type _____

Catalog Number _____

Approved by _____

SPECIFICATIONS

BASEPLATE: One-piece, seam welded 16-gauge CRS baseplate and end caps. Baseplate provided with four-point (2 or 3 foot) or six-point (4 foot) mounting holes and one wireway hole – see Cross Section/Details. TGIC polyester powder coat – 5-stage pre-treatment. Salt spray test: 1,000 hours; Reflectance: 92%. Lens is positioned in baseplate channels and retained with stainless steel Torx® fasteners (two fasteners/2 and 3 foot; six fasteners/4 foot). Baseplate/end caps mount flush to ceiling or wall surface.

LENS: Cold formed .156" P12 polycarbonate lens. See Options for alternate lenses.

ELECTRICAL: LED: Available 3000K, 3500K, 4000K and 5000K color temperatures, 82 CRI. 120-277VAC and 347VAC, 50/60Hz electrical input with serviceable high power factor electronic, constant-current driver (<20% THD, >0.95 PF). Standard 0-10V dimming with 1-100% range and dim-to-dark capabilities. 0.2mA max. source current. Optional embedded microwave motion sensor (MS) has factory default settings of 20 minute time out, dims down to 30%. LE: Class P ballasts. Fluorescent electronic 120/277/347 and dual voltage ballasts high power factor.

SENSOR & CONTROLS: Optional sensor available with compatible third party controls. To see the full list of compatible controls, [click here](#).

SOCKETS: Shock-resistant sockets with internal locking collar to ensure positive lamp retention.

HARDWARE: Stainless steel Torx® T-20 with center pin fasteners secure lens in baseplate channel.

INSTALLATION: Four-point (2 foot and 3 foot) or six-point (4 foot) mounting required for Peace of Mind Guarantee®.

WARRANTY: Limited five (5) year warranty. [Peace of Mind Guarantee against breakage](#).

LISTINGS: UL and CUL listed for Wet Location – covered ceilings only. UL and CUL listed for Damp Locations – wall mount. ADA Compliant. Suitable for installation into -40°C to 40°C ambient environments, unless otherwise noted. Luminaire tested to an IK10 impact protection rating per IEC 60068-2-75:1997-08.



ORDERING INFORMATION (Ex: SH8-48-45L35K-DCC-DV-MS)

Model	Nom. Length	Lamp Qty	Lamp Type	Ballast/Driver	Ballast Qty	Voltage	Options
SH8							
Nominal Length	Lamp Type	Ballast/Driver Type		Options			
24 2'	2' Lengths	DCC	0-10V Dimming LED Driver (LED only)	EL*	Standard Lumen Battery Pack (32°F one-lamp operation)		
36 3'	17 F17T8	IS	Instant Start Electronic <10% THD (T8)	PEL*	High Lumen Battery Pack (32°F one-lamp operation, 4-foot only)		
48 4'	3' Lengths	RS	Rapid Start Electronic <10% THD (T8, T5, T5HO)	.187	.187" P12 Polycarbonate Lens		
Lamp Quantity*	21 F21T5	SB	Specified Ballast	AL	Marine Grade Aluminum Housing		
2 Two Lamps	25 F25T8	Ballast Quantity*		BSS	Brush Stainless Steel Housing		
	39 F39T5HO	1 One		FS	Single Fuse & Holder		
	4' Lengths	2 Two		KO	Two 1/2" EMT Conduit Entry Knockouts (one per end cap)		
	45L30K 45 Watt 3000K LED	Voltage		OP	Opal Polycarbonate Lens		
	45L35K 45 Watt 3500K LED	DV	120-277VAC, 50/60Hz	PM	Pendant Mount		
	45L40K 45 Watt 4000K LED	347	347VAC, 60Hz	PSS	Painted Stainless Steel Housing		
	45L50K 45 Watt 5000K LED			MS	Motion Sensor (4' LED Only; n/a with 347V)		
	67L30K 67 Watt 3000K LED				* n/a with LED Lamp Type		
	67L35K 67 Watt 3500K LED						
	67L40K 67 Watt 4000K LED						
	67L50K 67 Watt 5000K LED						
	28 F28T5						
	32 F32T8						
	54 F54T5HO						



www.kenall.com | P: 800-4-Kenall | F: 262-891-9700 | 10200 55th Street Kenosha, Wisconsin 53144, USA
 This product is able to comply with the latest domestic preference legislation, such as the Buy American Act (BAA), Trade Agreement Act (TAA), Build America, Buy America Act (BABA), and others. It may be covered by patents found at www.kenall.com/patents. Content of specification sheets is subject to change; please consult www.kenall.com for current product details. ©2024 Kenall Mfg. Co.

A brand of **Legrand**

SHERIFF™

SH8 SERIES

PERFORMANCE

Lamp Type	Initial Delivered Lumens		Input Power (W)	Drive Current (mA)	Estd. L70 LED Life (Hrs)
	@ 25°C	Efficacy (lm/W)			
45L30K	4,595	96	48	100	80,000
45L35K	4,737	99			
45L40K	4,899	102			
45L50K	5,234	109			
67L30K	7,020	97	72	75	80,000
67L35K	7,237	101			
67L40K	7,484	104			
67L50K	7,996	111			

Information subject to change without notice. Photometry tested to the IESNA LM-79-08 standard by an ILAC/ISO17025 accredited laboratory. For photometric data, please go to www.kenall.com

Model: SH8-48-67L40K-DCC-DV

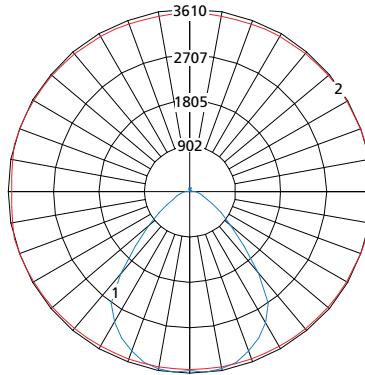

Maximum Candela = 3610 Located At Horizontal Angle = 15, Vertical Angle = 5

- 1 - Vertical Plane Through Horizontal Angles (15-195) (Through Max. Cd.)
- 2 - Horizontal Cone Through Vertical Angle (5) (Through Max. Cd.)

DIMENSIONAL DATA

CROSS SECTION

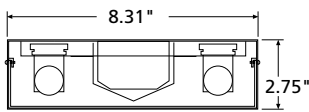

BASEPLATE

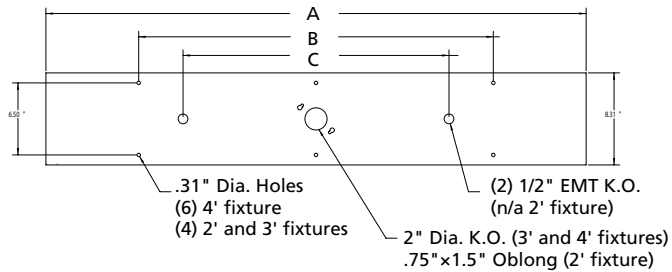

DIMENSIONAL DATA (IN INCHES)

	A	B	C
8x24	24.75	16.00	n/a
8x36	36.75	24.00	24.00
8x48	48.75	32.00	24.00



www.kenall.com | P: 800-4-Kenall | F: 262-891-9700 | 10200 55th Street Kenosha, Wisconsin 53144, USA
 This product is able to comply with the latest domestic preference legislation, such as the Buy American Act (BAA), Trade Agreement Act (TAA), Build America, Buy America Act (BABA), and others. It may be covered by patents found at www.kenall.com/patents. Content of specification sheets is subject to change; please consult www.kenall.com for current product details. ©2024 Kenall Mfg. Co.

A brand of **legrand**