

IMPORTANT SAFEGUARDS

When using electrical equipment, basic safety precautions should always be followed, including the following:

THIS PRODUCT MUST BE INSTALLED IN ACCORDANCE WITH THE APPLICABLE INSTALLATION CODE BY A PERSON FAMILIAR WITH THE CONSTRUCTION AND OPERATION OF THE PRODUCT AND THE HAZARDS INVOLVED. DISCONNECT POWER TO ALL CIRCUITS BEFORE WIRING FIXTURE. INSTALL IN ACCORDANCE WITH ALL NATIONAL, STATE, AND LOCAL CODES. DO NOT CONNECT TO AN UNGROUNDED SUPPLY. READ ALL FIXTURE MARKINGS AND LABELS TO ENSURE CORRECT INSTALLATION OF FIXTURE. SUPPLEMENTAL INSTRUCTIONS MAY BE LOCATED ON THE FIXTURE, IN ADDITION TO THIS INSTRUCTION SHEET, REGARDING ORIENTATION, OR MOUNTING RESTRICTIONS.

SAVE THESE INSTRUCTIONS

INSTALLATION INSTRUCTIONS

LIGHTING CONTROL INSTALLATION

1. Open housing using supplied key.
2. Place housing at the intended mounting location (wall or ceiling installation is acceptable). Locate and drill (4) pilot holes in mounting surface using housing as template or see Figure 1 below. Using 1/4-20 fasteners and anchors appropriate to the mounting surface (supplied by others), mount housing to surface.

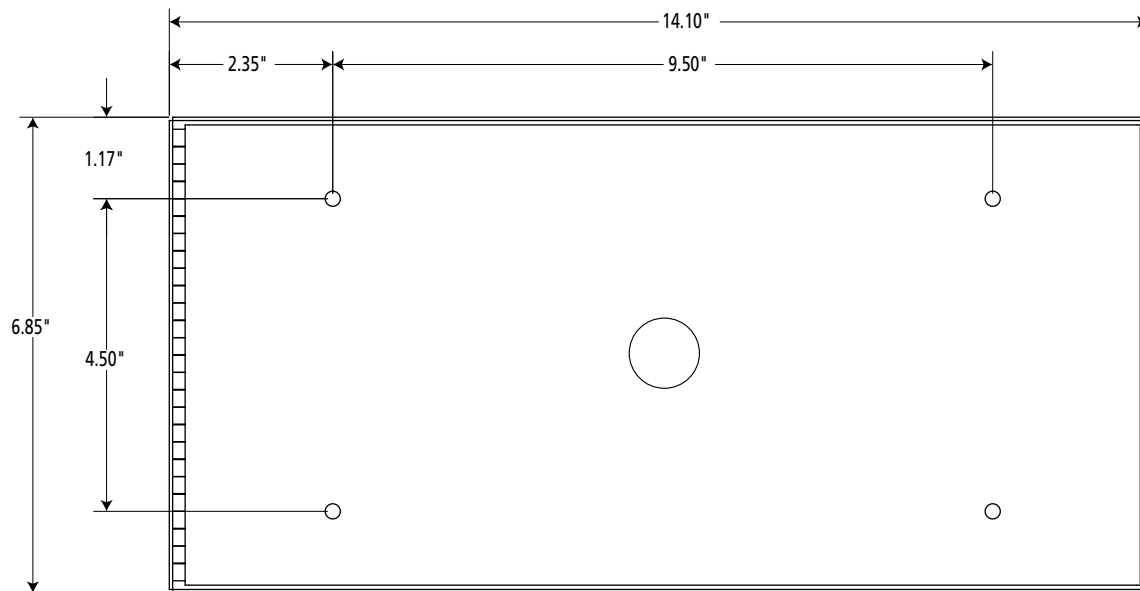

Figure 1

3. Install junction boxes for low-voltage occupancy sensors at designated locations. See "PIR SENSOR INSTALLATION" section for further details.
4. Determine layout of line voltage supply and low-voltage control wiring, including occupancy sensors. See Figure 2. Allowable input supply is 120-277VAC, 50/60Hz. All low-voltage control wiring shall be wired Class I with 18AWG, 600V TFFN wire.
5. Remove conduit knock-outs within controller housing as required and run conduit using 1/2" and 3/4" NPT fittings as appropriate.
6. Complete all line and control wiring for the IC150 controller, occupancy sensors and all luminaires, following all national and local electrical codes. Verify correct DIP switch setting (see Figure 3). Apply power to verify system performance. See "IC150 OPERATION VERIFICATION" section for details.



FIGURE 2: WIRING DIAGRAM

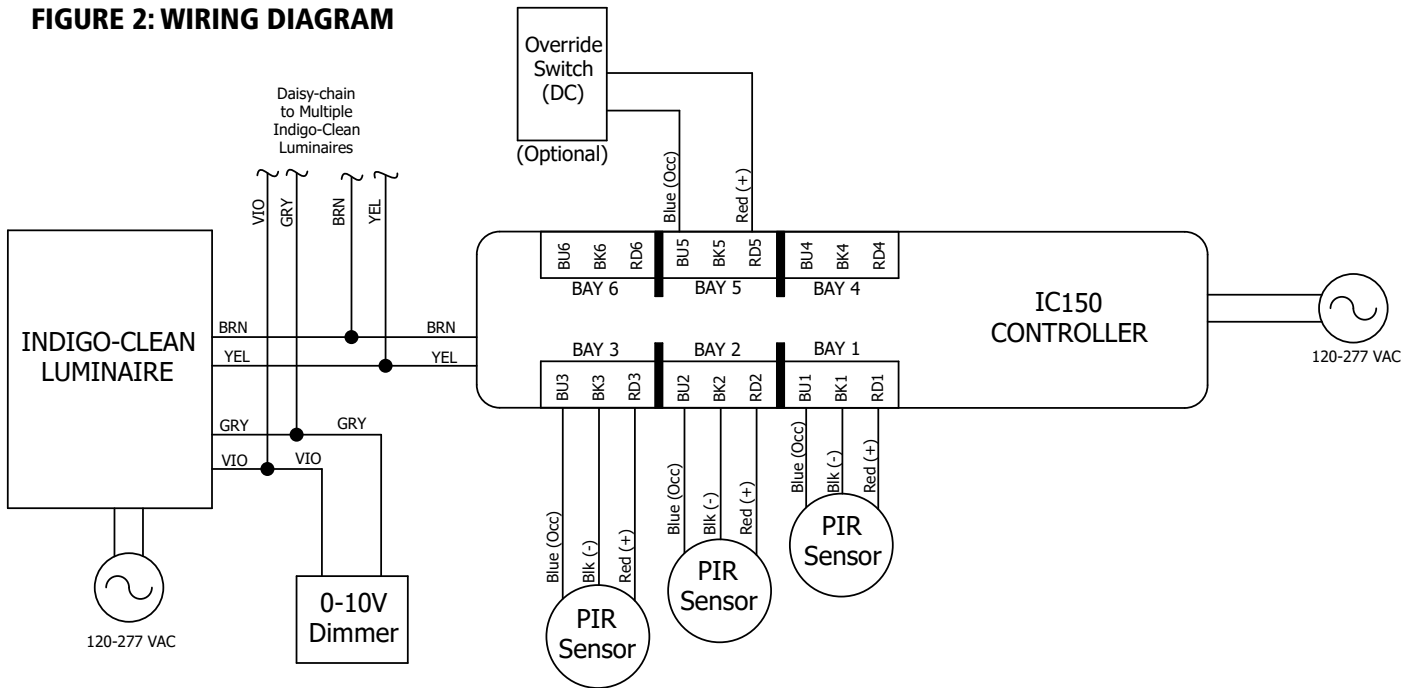
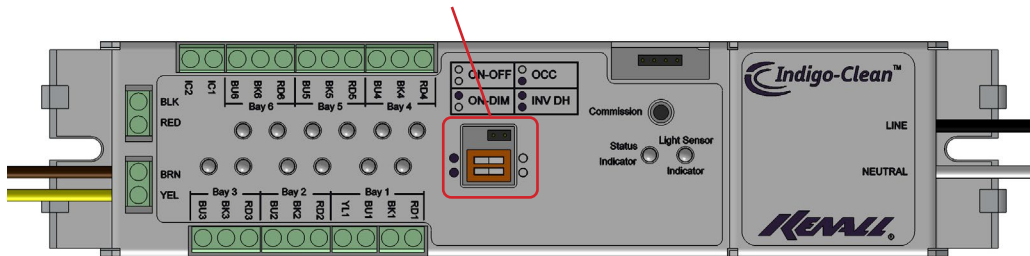
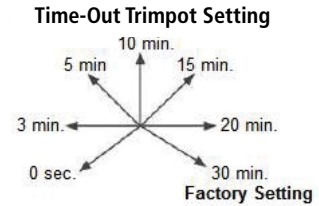
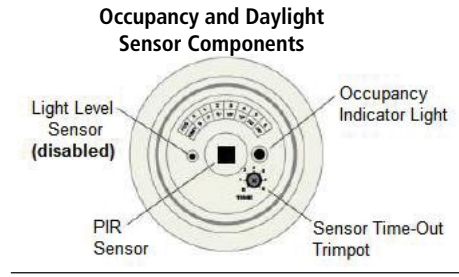
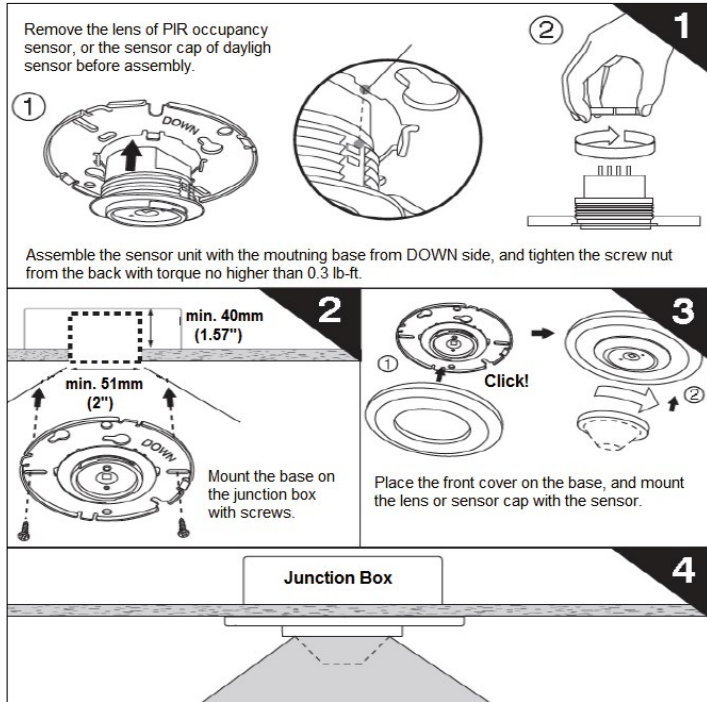

FIGURE 3: IC150 CONTROLLER DIP SWITCH SETTING

Verify the dipswitches are set to "OCC" position



PIR SENSOR INSTALLATION USING A 4" OCTAGONAL J-BOX



IC150 OPERATION VERIFICATION

The sensors are factory preset to 30 minutes, which allows for quick installation. Verification of system performance can be done through the following procedure:

1. Remove the lens from each PIR sensor and turn the Time-Out trimpot to 0 seconds:

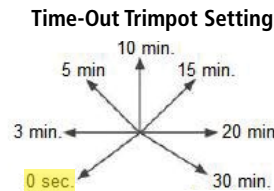
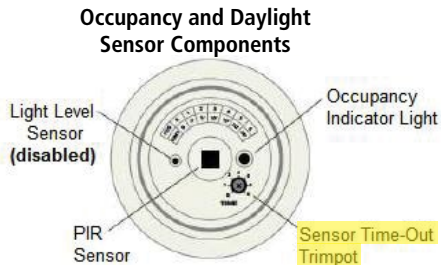

2. Remain still or exit the room. The Indigo-Clean luminaires should emit an indigo-colored light within 15 seconds of no movement within the room, indicating the system is in Indigo Disinfection mode.
3. Move about the room. The Indigo-Clean luminaires should return to emitting a white light, indicating the system is in White Disinfection mode.
4. Reset the PIR time-out settings to 30 minutes for all sensors, and reinstall PIR lenses.

Important Note – If optional override switch (See IC150 wiring diagram) is installed and connected to the controller, ensure the switch is on the 'OFF' (i.e. open) position for verification test. If Optional override switch is in the 'ON' (i.e. short) position, then the Indigo-Clean luminaires will stay White Disinfection mode indefinitely.

CUSTOMER SERVICE

For technical assistance, call 1-800-4KENALL (1-800-453-6255).

WARRANTY

For warranty information visit www.kenall.com/Resources/Certified-Performance-Warranties



www.kenall.com | P: 800-4-Kenall | F: 262-891-9701 | 10200 55th Street Kenosha, Wisconsin 53144, USA

This product complies with the Buy American Act: manufactured in the United States with more than 50% of the component cost of US origin. It may be covered by patents found at www.kenall.com/patents. Content of specification sheets is subject to change; please consult www.kenall.com for current product details. ©2019 Kenall Mfg. Co.

A brand of Legrand