

TekLink at a Glance

TL50 SERIES

TL50 Examples:

- » Occupancy Detection
- » Bi-level Dimming
- » Adjustable Non-Occupancy Dim Level*
- » Adjustable Timeout Setting



High Bay MaxTM



TopDekTM



MilleniumTM OS

TekLinkTM TL50 systems are individual LED luminaires containing an intelligent sensor, which enables each luminaire to operate as a stand-alone system. The control features and sensor type are fitted into specific luminaires based on the needs of the application. For example, stairwell luminaires would use sensors which implement Doppler principles (microwave or ultrasonic) to detect occupancy when obstructions are present. Luminaires for general area illumination could implement passive infrared. And still other lighting fixtures may utilize two sensor technologies as required by the application. The list above displays the various TL50 features available with select Kenall luminaires. Please see luminaire spec sheets for additional TL50 system details tailored for the application.

* Only Available with Select TL50 Luminaires

TL100 SERIES

- » Patented Self Commissioning
- » Occupancy Detection
- » Daylight Harvesting
- » Adjustable Time-Out
- » Sweep-Off
- » Override-On
- » Patented L₇₀ Lifetime Indication



Control System



Sensor



Luminaire

TekLinkTM TL100 is a zonal, wired system with local, centralized system control. TL100 coordinates luminaire light output based on daylight contribution and occupancy detection by employing a single concept: mount sensors at vehicular and pedestrian entry/egress points, run sensor wires to the lighting control module(s), and run 0-10V dimming signal wires to the luminaires. It is Kenall's most cost-effective control system that meets new ASHRAE 90.1 and Title 24 requirements. It features multiple sensing technologies, closed-loop daylight harvesting and our patented L₇₀ lifetime detection. Please see above for the list of TL100 features. Reference the TL100 Operation Manual for complete system details.

TekLink at a Glance

TL1000/2000 SERIES



- » Light Load Scheduling
- » Reporting
- » Text & Email Alerts
- » 3-D Graphical User Interface
- » System Configurable from Cloud
- » Tablet System Commissioning
- » Luminaire Zone Configuration
- » Power Measurement
- » Occupancy Detection
and much more...

TekLink™ TL1000 and TL2000 are adaptive lighting control systems that utilize wired and wireless (respectively) communication between system nodes. In addition to occupancy detection and daylight harvesting, the TL1000/2000 systems feature advanced scheduling and energy management capabilities with cloud-based control of system settings, reporting and notifications. For more information on this cloud-based system, please see the TL1000/2000 Application Guide or contact a Kenall representative. Listed above are select features of the adaptive control system.

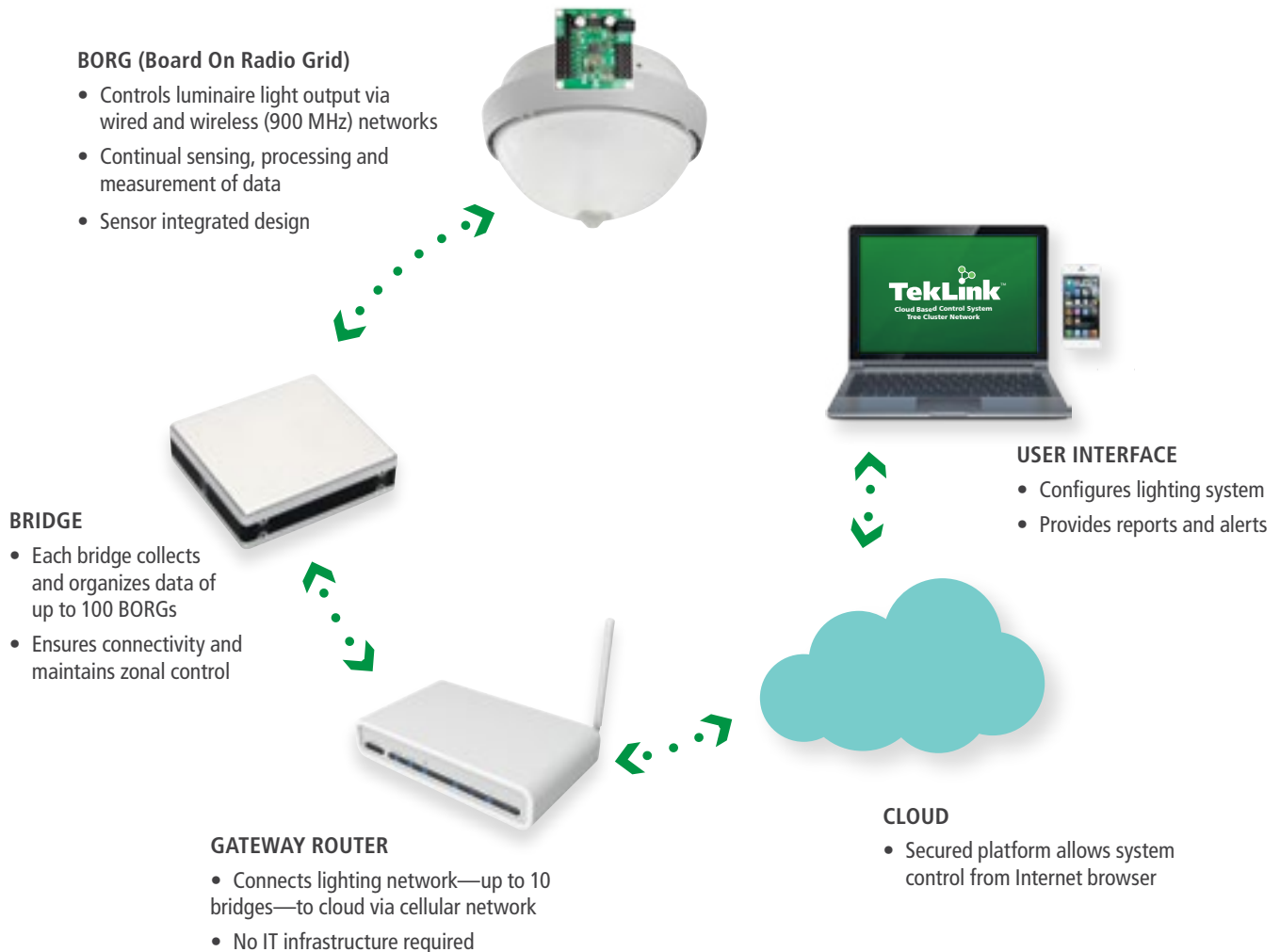

www.kenall.com | P: 800-4-Kenall | F: 262-891-9701 | 10200 55th Street Kenosha, Wisconsin 53144, USA

This product complies with the Buy American Act: manufactured in the United States with more than 50% of the component cost of US origin. It may be covered by patents found at www.kenall.com/patents. Content of specification sheets is subject to change; please consult www.kenall.com for current product details. ©2019 Kenall Mfg. Co.

A brand of Legrand