



# MedMaster Auracyl™ Sconce

MRI SUITES • PATIENT ROOMS • NURSES' STATIONS • WAITING ROOMS • CORRIDORS • PUBLIC AREAS



## The Kenall MedMaster Auracyl™ Sconce

Kenall's MedMaster Auracyl Sconce is an attractive, wall mounted luminaire that meets the aesthetic and functional challenges often encountered in healthcare settings.

With its clean, simple lines and gentle curves, the Auracyl's timeless styling complements a wide range of architectural and interior designs. Available in 1', 2', 3', and 4' lengths, the Auracyl can be scaled to any room, from intimate patient room settings and medium-sized waiting areas to large public spaces such as lobbies and atriums. This allows the designer to use the MedMaster Auracyl as an element of design consistency throughout the facility.

In terms of certified performance, the Auracyl is without equal. Designed for areas requiring the utmost protection from Healthcare Acquired Infections (HAI) and Electromagnetic Interference (EMI), this advanced luminaire is NSF2/Splash Zone listed for corrosion resistance, cleanability, and lack of toxicity. The MRI version meets Military Standard 461E for radiated and conducted EMI. The Sconce is also available with an optional IP64 rating to IEC 60598, to protect the luminaire interior from moisture, contaminants, and environmental debris. These listings are your assurance that Auracyl meets the most stringent requirements for infection control and electromagnetic compatibility with sensitive medical equipment.

The Auracyl is available in standard, optional, and custom colors – including white or black antimicrobial finishes – along with a selection of textures and patterns that give the designer an extensive palette of aesthetic options. Plus, the Auracyl features backlighting that creates a pleasing visual accent by highlighting the sconce's frame, reduces contrast, and adds soft, diffuse illumination to the space.

This highly efficient lighting system is available with LED, incandescent, linear fluorescent, and compact fluorescent lamps. State-of-the-art electrical components and engineering allow the Auracyl with LEDs to be dimmed, even in MRI and related imaging suites.



## PRODUCT FEATURES

- Non-ferrous, marine grade extruded aluminum housing with die-cast end caps; antimicrobial finish available
- Frosted, high transmission extruded acrylic lens with excellent impact resistance and maximum uniformity
- Incandescent and high efficiency dimmable linear and compact fluorescent, and LED lamp sources
- Sealed construction keeps out contaminants, dirt, and liquid for patient safety, high optical efficiency, and aesthetics
- Smooth exterior facilitates cleaning
- Durable double wall construction resists breakage from cleaning, rough handling, and accidental impact
- UL and CUL damp location listed, NSF2/Splash Zone listed, optional IP64 certified, U.S. Patent No. 7,029,139
- Non-ferrous dimmable MRI; 50,000 hour compatible LED low signal to noise ratio electronic design meets machine standards

## PHOTOMETRICS

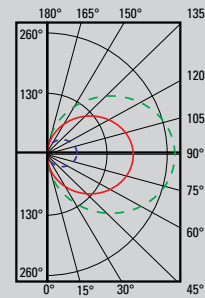

0-deg: - - - -  
 45-deg: ———  
 90-deg: - - - -

Auracy™ Sconces are ideal for both accent lighting and contributing to ambient levels. IES formatted photometrics are available for standard lens. Translucence data for optional lens materials is provided for photometric calculations specific to lens selection.

## SIZES

Available in 1', 2', 3', and 4' lengths, the Auracyl Sconce looks equally at home in large atrium spaces and patient rooms.

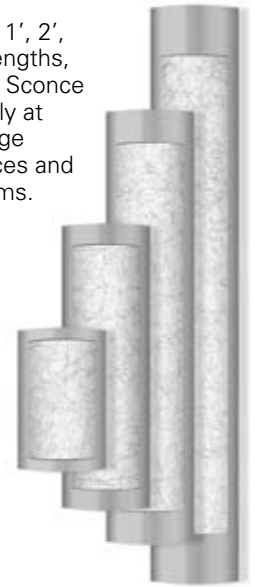

## DECORATIVE OUTER LENS

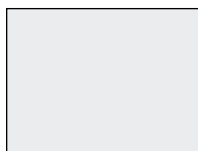

AS Frosted Acrylic (Standard)

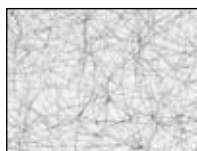

SS Silver Spun



CAP Clear Acrylic with Inner Perforation



OL Oyster Linen



NL Natural Leaf

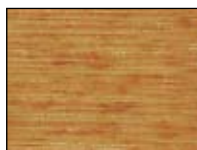

ST Saffron Taipei



PL Paper Leaf

## FRAME FINISH



MB Matte Black Antimicrobial



CS Cool Satin Painted Anodized



MW Matte White Antimicrobial

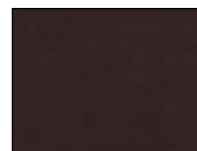

BR Bronze (Architectural)



WS Warm Satin Painted Anodized

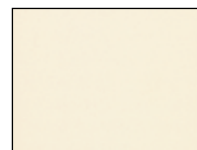

BE Beige



The clean lines and gentle curves of the luminaire are highlighted by the standard backlighting component. U.S. Patent Pending.

# MedMaster Auracyl™ Sconce

## MAS813 SERIES



**WALL MOUNT**  
Lamps: CFL, Biaxial, Incandescent, LED  
ADA Compliant

**Dimensions**  
Nominal 8" x 13" (8" x 15" for 13 Watt Twin)  
Nominal Luminous Opening 6" x 11"  
(6" x 13.3" for 13 Watt Twin)

## PROJECT INFORMATION

|                |  |
|----------------|--|
| Job Name       |  |
| Fixture Type   |  |
| Catalog Number |  |
| Approved by    |  |

## SPECIFICATIONS

**HOUSING:** Marine grade extruded aluminum. Marine grade die-cast aluminum end caps. TGIC polyester powder coat – 5-stage pre-treatment; Salt spray test: 1,000 hours. Antimicrobial finish standard on external aluminum surfaces of installed luminaire.

**REFLECTOR:** Die-formed marine grade aluminum. Full reflector/wire cover – 92% reflectivity.

**DECORATIVE OUTER LENS:** Acrylic translucent white lens standard. Nominal thickness .125". Optional decorative Lumicor® resins – see Ordering Information.

**INNER LENS:** UV stabilized, high impact resistant, extruded 100% DR/acrylic frost lens. Nominal thickness .100". Lens secured in place by lens frame.

**OUTER LENS:** Refer to optional Decorative Outer Lens selections below.

**HARDWARE:** One stainless steel Phillips head fastener standard. Four stainless steel Phillips head fasteners with IP64 option. Internal brackets and fasteners are non-corrosive.

**ELECTRICAL:** 120/277V or 347V high power factor electronic fluorescent ballast (<10~25% THD). 3,000 or 4,100K white LED light source with integral 120V electronic driver; input power 8, 14, 18, or 22 watts. Dimming capability controlled through compatible 0-10V dimmer (supplied by others).

**INSTALLATION:** Standard four-point mounting required.

**PHOTOMETRICS:** For photometric information, go to [www.kenall.com](http://www.kenall.com).

**PATENT:** U.S. Patent No. 7,029,139.

**LISTINGS:** UL and CUL listed for Damp Location – covered ceiling and wall mount. NSF2 Splash and Non-Food Zone. ADA Compliant. Optional IP64 certified to IEC 60598.



\*Kenall certifies product by both Underwriters and Intertek Testing Laboratories

## DIMENSIONAL DATA

### Cross Section and Installation Details

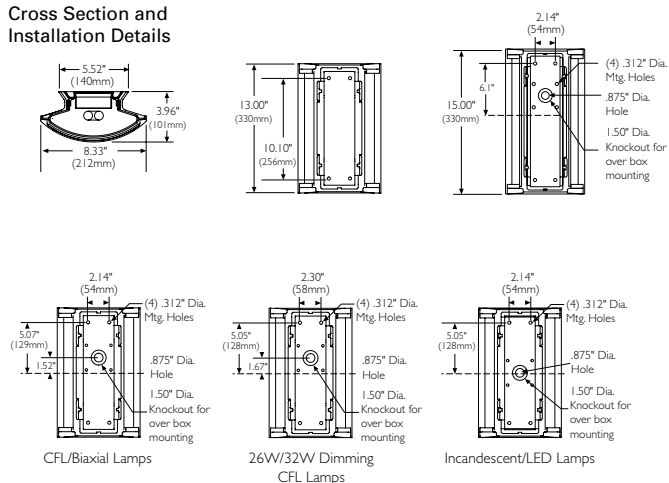

## DECORATIVE OUTER LENS



\*Lumicor® Lumiclear™ Acrylic Resin  
\*\*Lumicor® Lumiform™ PETG Resin

Lumicor® is a registered trademark of Lumicor, Inc., the leader in encapsulated resin technology. All Rights Reserved.

## FRAME FINISH



## ORDERING INFORMATION

| Series                | Frame Type  | Decorative Outer Lens             | Finish                            | Lamp Quantity                                    | Lamp & Ballast Type                            | Options  |
|-----------------------|---|-----------------------------------|-----------------------------------|--|--|--|
| <b>MAS813</b>         | <b>PAN</b>  |                                   |                                   |  |  |  |
| Frame Type            | PAN Pane  | Finish                            | MB Matte Black                    | Lamp & Ballast Type (Quantity, Ballast, Voltage) | 13E-PRS-DV<br>13 Watt Twin (2, PRS, 120/277V)  | Lamp & Ballast Type (Cont.)<br>8L4K-120 8 Watt 4100K LED (120V)        |
| Decorative Outer Lens | AS Frosted Acrylic (Standard)   | CS Cool Satin Painted Anodized    | MW Matte White                    | 13Q-PRS-DV<br>13 Watt Quad (1, PRS, 120/277V)    | 13 Watt Quad (1, PRS, 347V)                    | 14L3K-120 14 Watt 3000K LED (120V)                                     |
|                       | CAP Clear Acrylic w/Inner Perforation that is painted to match housing/frame finish | BR Bronze (Architectural)         | BE Beige                          | 18Q-PRS-DV<br>18 Watt Quad (1, PRS, 120/277V)    | 18 Watt Quad (1, PRS, 347V)                    | 14L4K-120 14 Watt 4000K LED (120V)                                     |
|                       | NL* Acrylic Natural Leaf  | CC Custom Color (Consult factory) | CC Custom Color (Consult factory) | 26Q-PRS-DV<br>26 Watt Quad (1, PRS, 120/277V)    | 26 Watt Quad (1, PRS, 347V)                    | 18L3K-DM-120 18 Watt 3000K LED (Dimming, 120V)                         |
|                       | SS* Acrylic Silver Spun   | Lamp Quantity                     |                                   | 26Q-PS-347<br>26 Watt Quad (1, PRS, 347V)        | 26 Watt Quad (1, Dimming, 120V)                | 18L4K-DM-120 18 Watt 4000K LED (Dimming, 120V)                         |
|                       | OL* Acrylic Oyster Linen  | 1 One Lamp                        |                                   | 26Q-DM-120<br>26 Watt Quad (1, Dimming, 120V)    | 26 Watt Quad (1, Dimming, 277V)                | 22L3K-DM-120 22 Watt 3000K LED (Dimming, 120V)                         |
|                       | ST* Acrylic Saffron Taipei  | 2 Two Lamp                        |                                   | 26Q-DM-277<br>26 Watt Quad (1, Dimming, 277V)    | 32 Watt PLT (1, PRS, 120/277V)                 | 22L4K-DM-120 22 Watt 4100K LED (Dimming, 120V)                         |
|                       | PL** PETG Paper Leaf  |                                   |                                   | 32P-PRS-DV<br>32 Watt PLT (1, PRS, 347V)         | 32 Watt PLT (1, Dimming, 120V)                 |  |
|                       | CD Custom Decorative Lens (Consult factory)   |                                   |                                   | 32P-PRS-347<br>32 Watt PLT (1, PRS, 347V)        | 32 Watt PLT (1, Dimming, 120V)                 |  |
|                       |   |                                   |                                   | 32P-DM-120<br>32 Watt PLT (1, Dimming, 120V)     | 32 Watt PLT (1, Dimming, 277V)                 |  |
|                       |   |                                   |                                   | 32P-DM-277<br>32 Watt PLT (1, Dimming, 277V)     | F18TT BiAx (1, PRS, 120/277V)                  |  |
|                       |   |                                   |                                   | 18B-PRS-DV<br>18 Watt Incandescent T10 (1, 120V) | 25IT-120<br>25 Watt Incandescent T10 (1, 120V) | Options<br>IP64 IP64 certified to IEC 60598<br>FS Single Fuse & Holder |
|                       |   |                                   |                                   | 40IT-120<br>40 Watt Incandescent T10 (1, 120V)   | 8L3K-120<br>8 Watt 3000K LED (120V)            |  |

\*Lumicor® Lumiclear™ Acrylic Resin  
\*\*Lumicor® Lumiform™ PETG Resin

MAS813-051810



The Kenall product shown or described on this page is manufactured in the USA with components purchased from US suppliers. Kenall has not determined the origin of its domestically purchased components or the subcomponents thereof.

www.kenall.com  
P: 847-360-8200 F: 847-360-1781  
1020 Lakeside Drive Gurnee, Illinois 60031  
© 2010 Kenall Mfg. Co. All rights reserved.

# MedMaster Auracyl™ Sconce

## MAS826 SERIES



Wall Mount  
Lamps: T8, T5, T5HO, Biaxial, LED  
ADA Compliant

Dimensions  
Nominal 8" x 26"  
Nominal Luminous Opening 6" x 22"

### PROJECT INFORMATION

|                |  |
|----------------|--|
| Job Name       |  |
| Fixture Type   |  |
| Catalog Number |  |
| Approved by    |  |

**HOUSING:** Marine grade extruded aluminum. Marine grade die-cast aluminum end caps. TGIC polyester powder coat – 5-stage pre-treatment; Salt spray test: 1,000 hours. Antimicrobial finish standard on external aluminum surfaces of installed luminaire.

**REFLECTOR:** Die-formed marine grade aluminum. Full reflector/wire cover – 92% reflectivity.

**DECORATIVE OUTER LENS:** Acrylic translucent white lens standard. Nominal thickness .125". Optional decorative Lumicor® resins – see Ordering Information.

**INNER LENS:** UV stabilized, high impact resistant, extruded 100% DR/acrylic frost lens. Nominal thickness .100". Lens secured in place by lens frame.

**OUTER LENS:** Refer to optional Decorative Outer Lens selections below.

**HARDWARE:** One stainless steel Phillips head fastener standard. Four stainless steel Phillips head fasteners with IP64 option. Internal brackets and fasteners are non-corrosive.

**ELECTRICAL:** 120/277V or 347V high power factor electronic fluorescent ballast (<10~25% THD). 3,000 or 4,100K white LED light source with integral 120/277V electronic high power factor driver (<20% THD); input power 24, 27, or 42 watts. Dimming capability controlled through compatible 0-10V dimmer (supplied by others).

**INSTALLATION:** Standard four-point mounting required.

**PHOTOMETRICS:** For photometric information, go to [www.kenall.com](http://www.kenall.com).

**PATENT:** U.S. Patent No. 7,029,139.

**LISTINGS:** UL and CUL listed for Damp Location – covered ceiling and wall mount. NSF2 Splash and Non-Food Zone. ADA Compliant. Optional IP64 certified to IEC 60598.



\*Kenall certifies product by both Underwriters and Intertek Testing Laboratories

SPECIFICATIONS

### Cross Section

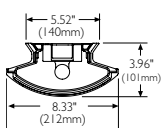

### Installation Details

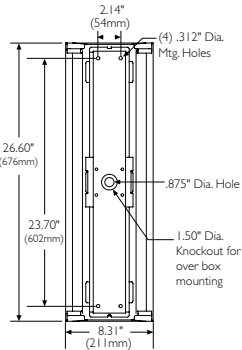

### DECORATIVE OUTER LENS



\*Lumicor® Lumiclear™ Acrylic Resin  
\*\*Lumicor® Lumiform™ PETG Resin

### FRAME FINISH



DIMENSIONAL DATA

| Series                | Frame Type  | Decorative Outer Lens          | Finish                            | Lamp Quantity                                    | Lamp & Ballast Type         | Options  |
|-----------------------|---|--------------------------------|-----------------------------------|--|-----------------------------|--|
| <b>MAS826</b>         | <b>PAN</b>  |                                |                                   | <b>1</b>   |                             |  |
| Frame Type            | PAN Pane  | Finish                         | MB Matte Black                    | Lamp & Ballast Type (Quantity, Ballast, Voltage) | F14T5 (1,IS,120V)           | Lamp & Ballast Type (Cont.)                      |
|                       |   | MW Matte White                 | WS Warm Satin Painted Anodized    | 14-PS-277  | F14T5 (1,PS,277V)           | 24L4K-120 24 Watt 4000K LED (120V)               |
| Decorative Outer Lens | AS Frosted Acrylic (Standard)   | CS Cool Satin Painted Anodized | BR Bronze (Architectural)         | 14-DM-120  | F14T5 (1,Dimming,120V)      | 27L3K-DM-DV 27 Watt 3000K LED (Dimming,120/277V) |
|                       | CAP Clear Acrylic w/Inner Perforation that is painted to match housing/frame finish | BE Beige                       | CC Custom Color (Consult factory) | 17-IS-DV   | F17T8 (1,IS,120/277V)       | 27L4K-DM-DV 27 Watt 4000K LED (Dimming,120/277V) |
|                       | NL* Acrylic Natural Leaf  | Lamp Quantity                  |                                   | 17-PRS-347                                       | F17T8 (1,PRS,347V)          | 42L3K-DM-DV 42 Watt 3000K LED (Dimming,120/277V) |
|                       | SS* Acrylic Silver Spun   | 1 One Lamp                     |                                   | 17-DM-120  | F17T8 (1,Dimming,120V)      | 42L4K-DM-DV 42 Watt 4100K LED (Dimming,120/277V) |
|                       | OL* Acrylic Oyster Linen  |                                |                                   | 17-DM-277  | F17T8 (1,Dimming,277V)      |  |
|                       | ST* Acrylic Saffron Taipei  |                                |                                   | 24-PRS-DV  | F24T5HO (1,PRS,120/277V)    |  |
|                       | PL** PETG Paper Leaf  |                                |                                   | 40B-PRS-DV                                       | F40TT Biax (1,PRS,120/277V) |  |
|                       | CD Custom Decorative Lens (Consult factory)   |                                |                                   | 40B-DM-120                                       | F40TT Biax (1,Dimming,120V) |  |
|                       |   |                                |                                   | 40B-DM-277                                       | F40TT Biax (1,Dimming,277V) | Options  |
|                       |   |                                |                                   | 55B-PRS-DV                                       | F55TT Biax (1,PRS,120/277V) | IP64 IP64 certified to IEC 60598                 |
|                       |   |                                |                                   | 55B-PS-347                                       | F55TT Biax (1,PS,347V)      | FS Single Fuse & Holder                          |
|                       |   |                                |                                   | 55B-DM-120                                       | F55TT Biax (1,Dimming,120V) |  |
|                       |   |                                |                                   | 55B-DM-277                                       | F55TT Biax (1,Dimming,277V) |  |
|                       |   |                                |                                   | 24L3K-120  | 24 Watt 3000K LED (120V)    |  |

\*Lumicor® Lumiclear™ Acrylic Resin  
\*\*Lumicor® Lumiform™ PETG Resin

MAS826-051810

ORDERING INFORMATION



The Kenall product shown or described on this page is manufactured in the USA with components purchased from US suppliers. Kenall has not determined the origin of its domestically purchased components or the subcomponents thereof.

www.kenall.com  
P: 847-360-8200 F: 847-360-1781  
1020 Lakeside Drive Gurnee, Illinois 60031  
© 2010 Kenall Mfg. Co. All rights reserved.

# MedMaster Auracyl™ Sconce

MAS838 SERIES

WALL MOUNT  
Lamps: T8, T5, T5HO, LED  
ADA Compliant

Dimensions  
Nominal 8" x 38"  
Nominal Luminous Opening 6" x 32"

## PROJECT INFORMATION

|                |  |
|----------------|--|
| Job Name       |  |
| Fixture Type   |  |
| Catalog Number |  |
| Approved by    |  |

## SPECIFICATIONS



**HOUSING:** Marine grade extruded aluminum. Marine grade die-cast aluminum end caps. TGIC polyester powder coat – 5-stage pre-treatment; Salt spray test: 1,000 hours. Antimicrobial finish standard on external aluminum surfaces of installed luminaire.

**REFLECTOR:** Die-formed marine grade aluminum. Full reflector/wire cover – 92% reflectivity.

**DECORATIVE OUTER LENS:** Acrylic translucent white lens standard. Nominal thickness .125". Optional decorative Lumicor® resins – see Ordering Information.

**INNER LENS:** UV stabilized, high impact resistant, extruded 100% DR/acrylic frost lens. Nominal thickness .100". Lens secured in place by lens frame.

**OUTER LENS:** Refer to optional Decorative Outer Lens selections below.

**HARDWARE:** One stainless steel Phillips head fastener standard. Six stainless steel Phillips head fasteners with IP64 option. Internal brackets and fasteners are non-corrosive.

**ELECTRICAL:** 120/277V or 347V high power factor electronic fluorescent ballast (<10~25% THD). 3,000 or 4,100K white LED light source with integral 120/277V electronic high power factor driver (<20% THD); input power 32, 34, or 60 watts. Dimming capability controlled through compatible 0-10V dimmer (supplied by others).

**INSTALLATION:** Standard six-point mounting required.

**PHOTOMETRICS:** For photometric information, go to [www.kenall.com](http://www.kenall.com).

**PATENT:** U.S. Patent No. 7,029,139.

**LISTINGS:** UL and CUL listed for Damp Location – covered ceiling and wall mount. NSF2 Splash and Non-Food Zone. ADA Compliant. Optional IP64 certified to IEC 60598.



\* Kenall certifies product by both Underwriters and Intertek Testing Laboratories

## DIMENSIONAL DATA

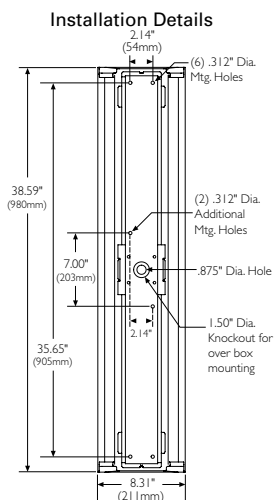
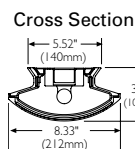

## DECORATIVE OUTER LENS



\*Lumicor® Lumiclear™ Acrylic Resin  
\*\*Lumicor® Lumiform™ PETG Resin

## FRAME FINISH



## ORDERING INFORMATION

| Series                | Frame Type | Decorative Outer Lens   | Finish                             | Lamp Quantity                                    | Lamp & Ballast Type                   | Options              |
|-----------------------|------------|---|------------------------------------|--|---------------------------------------|----------------------|
| <b>MAS838</b>         | <b>PAN</b> |   |                                    | <b>1</b>   |                                       |                      |
| Frame Type            | PAN        | Pane  | Finish                             | Lamp & Ballast Type (Quantity, Ballast, Voltage) |                                       | Options              |
| Decorative Outer Lens | AS         | Frosted Acrylic (Standard)  | MB                                 | 21-PRS-DV  | F21T5 (1, PRS, 120/277V)              | IP64                 |
|                       | CAP        | Clear Acrylic w/Inner Perforation that is painted to match housing/frame finish | MW                                 | 21-DM-DV   | F21T5 (1, Dimming, 120/277V)          | FS                   |
|                       | NL*        | Acrylic Natural Leaf  | WS                                 | 25-IS-DV   | F25T8 (1, IS, 120/277V)               | Single Fuse & Holder |
|                       | SS*        | Acrylic Silver Spun   | CS                                 | 25-IS-347  | F25T8 (1, IS, 347V)                   |                      |
|                       | OL*        | Acrylic Oyster Linen  | BR                                 | 25-DM-120  | F25T8 (1, Dimming, 120V)              |                      |
|                       | ST*        | Acrylic Saffron Taipei  | BE                                 | 25-DM-277  | F25T8 (1, Dimming, 277V)              |                      |
|                       | PL**       | PETG Paper Leaf   | CC                                 | 39-PRS-DV  | F39T5HO (1, PRS, 120/277V)            |                      |
|                       | CD         | Custom Decorative Lens (Consult factory)  |                                    | 32L3K-120  | 32 Watt 3000K LED (120V)              |                      |
|                       |            |   | Lamp Quantity                      | 32L4K-120  | 32 Watt 4000K LED (120V)              |                      |
|                       |            |   | 1 One Lamp                         | 34L3K-DM-DV                                      | 34 Watt 3000K LED (Dimming, 120/277V) |                      |
|                       |            |   |                                    | 34L4K-DM-DV                                      | 34 Watt 4000K LED (Dimming, 120/277V) |                      |
|                       |            |   | *Lumicor® Lumiclear™ Acrylic Resin | 60L3K-DM-DV                                      | 60 Watt 3000K LED (Dimming, 120/277V) |                      |
|                       |            |   | **Lumicor® Lumiform™ PETG Resin    | 60L4K-DM-DV                                      | 60 Watt 4100K LED (Dimming, 120/277V) |                      |

MAS838-051810



The Kenall product shown or described on this page is manufactured in the USA with components purchased from US suppliers. Kenall has not determined the origin of its domestically purchased components or the subcomponents thereof.

www.kenall.com  
P: 847-360-8200 F: 847-360-1781  
1020 Lakeside Drive Gurnee, Illinois 60031  
© 2010 Kenall Mfg. Co. All rights reserved.

# MedMaster Auracyl™ Sconce

MAS850 SERIES



WALL MOUNT  
Lamps: T8, T5, T5HO, LED  
ADA Compliant

Dimensions  
Nominal 8" x 50"  
Nominal Luminous Opening 6" x 41"

## PROJECT INFORMATION

|                |  |
|----------------|--|
| Job Name       |  |
| Fixture Type   |  |
| Catalog Number |  |
| Approved by    |  |

**HOUSING:** Marine grade extruded aluminum. Marine grade die-cast aluminum end caps. TGIC polyester powder coat – 5-stage pre-treatment; Salt spray test: 1,000 hours. Antimicrobial finish standard on external aluminum surfaces of installed luminaire.

**REFLECTOR:** Die-formed marine grade aluminum. Full reflector/wire cover – 92% reflectivity.

**DECORATIVE OUTER LENS:** Acrylic translucent white lens standard. Nominal thickness .125". Optional decorative Lumicor® resins – see Ordering Information.

**INNER LENS:** UV stabilized, high impact resistant, extruded 100% DR/acrylic frost lens. Nominal thickness .100". Lens secured in place by lens frame.

**OUTER LENS:** Refer to optional Decorative Outer Lens selections below.

**HARDWARE:** One stainless steel Phillips head fastener standard. Six stainless steel Phillips head fasteners with IP64 option. Internal brackets and fasteners are non-corrosive.

**ELECTRICAL:** 120/277V or 347V high power factor electronic fluorescent ballast (<10~25% THD). 3,000 or 4,100K white LED light source with integral 120/277V electronic high power factor driver (<20% THD); input power 40, 42, or 76 watts. Dimming capability controlled through compatible 0-10V dimmer (supplied by others).

**INSTALLATION:** Standard six-point mounting required.

**PHOTOMETRICS:** For photometric information, go to [www.kenall.com](http://www.kenall.com).

**PATENT:** U.S. Patent No. 7,029,139.

**LISTINGS:** UL and CUL listed for Damp Location – covered ceiling and wall mount. NSF2 Splash and Non-Food Zone. ADA Compliant. Optional IP64 certified to IEC 60598.



\* Kenall certifies product by both Underwriters and Intertek Testing Laboratories

SPECIFICATIONS

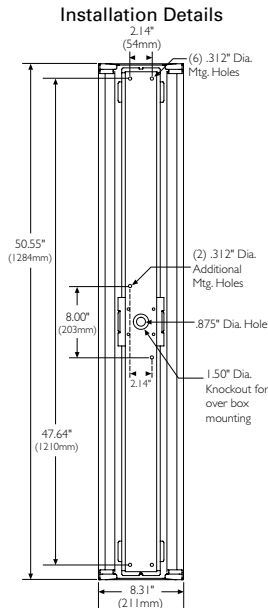
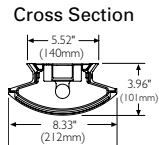

## DECORATIVE OUTER LENS



\*Lumicor® Lumiclear™ Acrylic Resin  
\*\*Lumicor® Lumiform™ PETG Resin

## FRAME FINISH



DIMENSIONAL DATA

| Series  | Frame Type | Decorative Outer Lens             | Finish | Lamp Quantity                                    | Lamp & Ballast Type               | Options |
|---|------------|-----------------------------------|--------|--|-----------------------------------|---------|
| <b>MAS850</b>   | <b>PAN</b> |                                   |        | <b>1</b>   |                                   |         |
| Frame Type  | PANE       | Finish                            |        | Lamp & Ballast Type (Quantity, Ballast, Voltage) | Lamp & Ballast Type (Cont.)       |         |
| PAN   | PANE       | MB Matte Black                    |        | 28-PRS-DV F28T5 (1,PRS,120/277V)                 | 42L4K-DM-DV 42 Watt 4000K LED     |         |
|   |            | MW Matte White                    |        | 28-DM-DV F28T5 (1,Dimming,120/277V)              | (Dimming,120/277V)                |         |
| Decorative Outer Lens   |            | WS Warm Satin Painted Anodized    |        | 32-IS-DV F32T8 (1,IS,120/277V)                   | 76L3K-DM-DV 76 Watt 3000K LED     |         |
| AS Frosted Acrylic (Standard)   |            | CS Cool Satin Painted Anodized    |        | 32-DM-120 F32T8 (1,Dimming,120V)                 | (Dimming,120/277V)                |         |
| CAP Clear Acrylic w/Inner Perforation that is painted to match housing/frame finish |            | BR Bronze (Architectural)         |        | 32-DM-277 F32T8 (1,Dimming,277V)                 | 76L4K-DM-DV 76 Watt 4100K LED     |         |
| NL* Acrylic Natural Leaf  |            | BE Beige                          |        | 32-IS-347 F32T8 (1,IS,347V)                      | (Dimming,120/277V)                |         |
| SS* Acrylic Silver Spun   |            | CC Custom Color (Consult factory) |        | 54-PRS-DV F54T5HO (1,PRS,120/277V)               |                                   |         |
| OL* Acrylic Oyster Linen  |            | Lamp Quantity                     |        | 54-DM-120 F54T5HO (1,Dimming,120V)               | Options                           |         |
| ST* Acrylic Saffron Taipei  |            | 1 One Lamp                        |        | 54-DM-277 F54T5HO (1,Dimming,277V)               | EL One Lamp Emergency Pack (32°F) |         |
| PL** PETG Paper Leaf  |            |                                   |        | 54-PS-347 F54T5HO (1,PS,347V)                    | (N/A with LED lamp)               |         |
| CD Custom Decorative Lens (Consult factory)   |            |                                   |        | 40L3K-120 40 Watt 3000K LED (120V)               | IP64 IP64 certified to IEC 60598  |         |
|   |            |                                   |        | 40L4K-120 40 Watt 4000K LED (120V)               | FS Single Fuse & Holder           |         |
|   |            |                                   |        | 42L3K-DM-DV 42 Watt 3000K LED (Dimming,120/277V) |                                   |         |

MAS850-051310

ORDERING INFORMATION



The Kenall product shown or described on this page is manufactured in the USA with components purchased from US suppliers. Kenall has not determined the origin of its domestically purchased components or the subcomponents thereof.

www.kenall.com  
P: 847-360-8200 F: 847-360-1781  
1020 Lakeside Drive Gurnee, Illinois 60031  
© 2010 Kenall Mfg. Co. All rights reserved.

# MedMaster Auracyl™ Sconce for MRI Suites

MRIMAS813 SERIES



WALL MOUNT  
Lamps: Incandescent, LED  
ADA Compliant  
Non-Ferrous

Dimensions  
Nominal 8" x 13"  
Nominal Luminous Opening 6" x 11"

## PROJECT INFORMATION

|                |  |
|----------------|--|
| Job Name       |  |
| Fixture Type   |  |
| Catalog Number |  |
| Approved by    |  |

## SPECIFICATIONS

**HOUSING:** Non-ferrous marine grade extruded aluminum. Non-ferrous marine grade die-cast aluminum end caps. TGIC polyester powder coat finish – 5-stage pre-treatment; Salt spray test: 1,000 hours.

**REFLECTOR:** Die-formed non-ferrous marine grade aluminum. Full reflector/wire cover – 92% reflectivity.

**DECORATIVE OUTER LENS:** Acrylic translucent white lens standard. Nominal thickness .125". Optional decorative Lumicor® resins – see Ordering Information.

**INNER LENS:** UV stabilized, high impact resistant, extruded 100% DR/acrylic frost lens. Nominal thickness .100". Lens secured in place by lens frame.

**OUTER LENS:** Refer to optional Decorative Outer Lens selections below.

**ELECTRICAL:** High brightness 3000K or 4000K LED light source. Luminaire input 24V DC from remote-mounted, 120-240V AC, high power factor power supply (MRIPS-312 ordered separately). Dimming capability controlled through compatible 0-10V dimmer (supplied by others). MRI room EMI filter required (supplied by others).

**HARDWARE:** One non-ferrous stainless steel Phillips head fastener standard; six fasteners with IP64 option. Internal brackets and fasteners are non-ferrous and non-corrosive.

**INSTALLATION:** Standard four-point mounting required. All power and signal wiring must be completely shielded in grounded conduit.

**PHOTOMETRICS:** For photometric information, go to [www.kenall.com](http://www.kenall.com).

**PATENT:** U.S. Patent No. 7,029,139.

**WARRANTY:** One year warranty on mechanical defects. Three year warranty on LED lamps and internal power regulation components for defects resulting in a fixture lumen depreciation of 30% or greater. Warranty is void if all wiring is not completely shielded in grounded conduit.

**LISTINGS:** UL and CUL listed for Damp Location – covered ceiling and wall mount. NSF2 Splash Non-Food Zone. ADA compliant. Optional ETL certified IP64 in compliance with IEC 60598.



Kenall certifies product by both Underwriters and Intertek Testing Laboratories

## DIMENSIONAL DATA

Cross Section

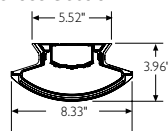

Installation Details

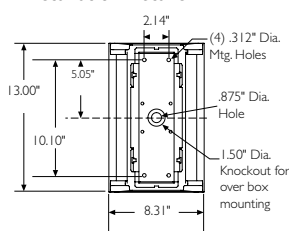

## DECORATIVE OUTER LENS

|                               |                                       |                  |   |
|-------------------------------|---------------------------------------|------------------|---|
|                               |                                       |                  |   |
| AS Frosted Acrylic (Standard) | CAP Clear Acrylic w/Inner Perforation | NL Natural Leaf* | SS Silver Spun*   |
|                               |                                       |                  | * Lumicor® Lumiclear™ Acrylic Resin<br>** Lumicor® Lumiform™ PETG Resin |
| OL Oyster Linen*              | ST Saffron Taipei*                    | PL Paper Leaf**  |   |

## FRAME FINISH

|                           |                |                                |                                |
|---------------------------|----------------|--------------------------------|--------------------------------|
|                           |                |                                |                                |
| MB Matte Black            | MW Matte White | WS Warm Satin Painted Anodized | CS Cool Satin Painted Anodized |
|                           |                |                                |                                |
| BR Bronze (Architectural) | BE Beige       |                                |                                |

## ORDERING INFORMATION

| Series                | Frame Type  | Decorative Outer Lens  | Finish   | Lamp Quantity  | Lamp Type  | Voltage | Option  |
|-----------------------|---|--|--|--|--|---------|---|
| <b>MRIMAS813</b>      | <b>PAN</b>  |  |  | <b>1</b>   |  |         |   |
| Frame Type            | PAN Pane  | Finish   | MB Matte Black (Antimicrobial finish on exposed surfaces of installed luminaire) | Lamp Qty   | 1 One Lamp   | Voltage | 120 120V (Incandescent only)<br>24 24 Volts DC (MRIPS-312 Power Supply required – order separately) |
| Decorative Outer Lens | AS Frosted Acrylic (Standard)   | MW Matte White (Antimicrobial finish on exposed surfaces of installed luminaire) | WS Warm Satin Painted Anodized   | Lamp Type  | 25IT 25 Watt Incandescent (T10)<br>40IT 40 Watt Incandescent (T10)<br>9L3K 9 Watt LED (3000K)<br>9L4K 9 Watt LED (4000K) | Options | IP64 IP64 certified to IEC 60598  |
|                       | CAP Clear Acrylic w/Inner Perforation that is painted to match housing/frame finish | CS Cool Satin Painted Anodized   | BR Bronze (Architectural)  | 16L3K 16 Watt LED (3000K)<br>16L4K 16 Watt LED (4000K) |  |         |   |
|                       | NL* Acrylic Natural Leaf  | BE Beige   |  |  |  |         |   |
|                       | SS* Acrylic Silver Spun   | CC Custom Color (Consult factory)  |  |  |  |         |   |
|                       | OL* Acrylic Oyster Linen  |  |  |  |  |         |   |
|                       | ST* Acrylic Saffron Taipei  |  |  |  |  |         |   |
|                       | PL** PETG Paper Leaf  |  |  |  |  |         |   |
|                       | CD Custom Decorative Lens (Consult factory)   |  |  |  |  |         |   |

| MRI LUMINAIRE CONNECTION PER POWER SUPPLY |                       |                           |
|---|-----------------------|---------------------------|
| Luminaire Number                          | Amps/ Luminaire Power | Max. Luminaires/ per room |
| MRIMAS813 (9W)                            | 0.4                   | 28                        |
| MRIMAS813 (16W)                           | 0.7                   | 16                        |

MRIMAS813-051810



The Kenall product shown or described on this page is manufactured in the USA with components purchased from US suppliers. Kenall has not determined the origin of its domestically purchased components or the subcomponents thereof.

www.kenall.com  
P: 847-360-8200 F: 847-360-1781  
1020 Lakeside Drive Gurnee, Illinois 60031  
© 2010 Kenall Mfg. Co. All rights reserved.



# MedMaster Auracyl™ Sconce for MRI Suites

## MRIMAS826 SERIES



### WALL MOUNT

Lamps: LED  
ADA Compliant  
Non-Ferrous

### Dimensions

Nominal 8" x 26"  
Nominal Luminous Opening 6" x 22"

## PROJECT INFORMATION

|                |  |
|----------------|--|
| Job Name       |  |
| Fixture Type   |  |
| Catalog Number |  |
| Approved by    |  |

**HOUSING:** Non-ferrous marine grade extruded aluminum. Non-ferrous marine grade die-cast aluminum end caps. TGIC polyester powder coat finish – 5-stage pre-treatment; Salt spray test: 1,000 hours.

**REFLECTOR:** Die-formed non-ferrous marine grade aluminum. Full reflector/wire cover – 92% reflectivity.

**DECORATIVE OUTER LENS:** Acrylic translucent white lens standard. Nominal thickness .125". Optional decorative Lumicor® resins – see Ordering Information.

**INNER LENS:** UV stabilized, high impact resistant, extruded 100% DR/acrylic frost lens. Nominal thickness .100". Lens secured in place by lens frame.

**OUTER LENS:** Refer to optional Decorative Outer Lens selections below.

**ELECTRICAL:** High brightness 3000K or 4000K LED light source. Luminaire input 24V DC from remote-mounted, 120-240V AC, high power factor power supply (MRIPS-312 ordered separately). Dimming capability controlled through compatible 0-10V dimmer (supplied by others). MRI room EMI filter required (supplied by others).

**HARDWARE:** One non-ferrous stainless steel Phillips head fastener standard; four fasteners with IP64 option. Internal brackets and fasteners are non-ferrous and non-corrosive.

**INSTALLATION:** Standard four-point mounting required. All power and signal wiring must be completely shielded in grounded conduit.

**PHOTOMETRICS:** For photometric information, go to [www.kenall.com](http://www.kenall.com)

**PATENT:** U.S. Patent No. 7,029,139.

**WARRANTY:** One year warranty on mechanical defects. Three year warranty on LED lamps and internal power regulation components for defects resulting in a fixture lumen depreciation of 30% or greater. Warranty is void if all wiring is not completely shielded in grounded conduit.

**LISTINGS:** Luminaire is certified to UL 1598 and UL 8750 standards by Intertek Testing Services – covered ceiling and wall mount. NSF2 Splash Non-Food Zone. ADA compliant. Optional ETL certified IP64 in compliance with IEC 60598.



SPECIFICATIONS

Cross Section

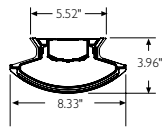

Installation Details

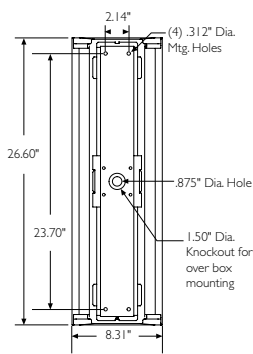

## DECORATIVE OUTER LENS

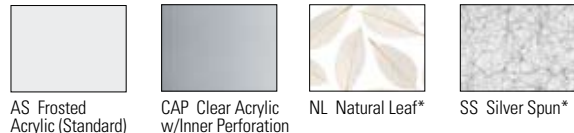

AS Frosted Acrylic (Standard)

CAP Clear Acrylic w/Inner Perforation

NL Natural Leaf\*

SS Silver Spun\*

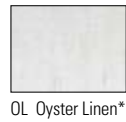

OL Oyster Linen\*



ST Saffron Taipei\*



PL Paper Leaf\*\*

\*Lumicor® Lumiclear™ Acrylic Resin  
\*\*Lumicor® Lumiform™ PETG Resin

## FRAME FINISH

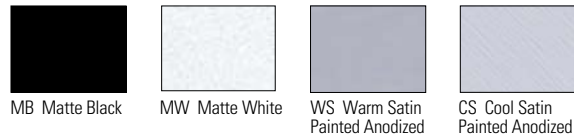

MB Matte Black

MW Matte White

WS Warm Satin Painted Anodized

CS Cool Satin Painted Anodized



BR Bronze (Architectural)

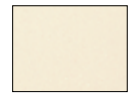

BE Beige

DIMENSIONAL DATA

| Series                | Frame Type  | Decorative Outer Lens  | Finish   | Lamp Quantity | Lamp Type   | Voltage   | Option                           |
|-----------------------|---|--|--|---------------|---|-----------|----------------------------------|
| <b>MRIMAS826</b>      | <b>PAN</b>  |  |  | <b>1</b>      |   | <b>24</b> |                                  |
| Frame Type            | PAN Pane  | Finish   | MB Matte Black (Antimicrobial finish on exposed surfaces of installed luminaire) | Lamp Qty      | 1 One Lamp  | Option    | IP64 IP64 certified to IEC 60598 |
| Decorative Outer Lens | AS Frosted Acrylic (Standard)   | MW Matte White (Antimicrobial finish on exposed surfaces of installed luminaire) | WS Warm Satin Painted Anodized   | Lamp Type     | 25L3K 25 Watt LED (3000K)<br>25L4K 25 Watt LED (4000K)              |           |                                  |
| CAP                   | Clear Acrylic w/Inner Perforation that is painted to match housing/frame finish | CS Cool Satin Painted Anodized   | BR Bronze (Architectural)  | Voltage       | 24 24 Volts DC (MRIPS-312 Power Supply required – order separately) |           |                                  |
| NL*                   | Acrylic Natural Leaf  | BE Beige   | CC Custom Color (Consult factory)  |               |   |           |                                  |
| SS*                   | Acrylic Silver Spun   |  |  |               |   |           |                                  |
| OL*                   | Acrylic Oyster Linen  |  |  |               |   |           |                                  |
| ST*                   | Acrylic Saffron Taipei  |  |  |               |   |           |                                  |
| PL**                  | PETG Paper Leaf   |  |  |               |   |           |                                  |
| CD                    | Custom Decorative Lens (Consult factory)  |  |  |               |   |           |                                  |

| MRI LUMINAIRE CONNECTION PER POWER SUPPLY |                |                                       |
|---|----------------|---------------------------------------|
| Luminaire Number                          | Amps/Luminaire | Max. Luminaires/Power Supply/per room |
| MRIMAS826                                 | 1.0            | 10                                    |

MRIMAS826-051810

ORDERING INFORMATION



The Kenall product shown or described on this page is manufactured in the USA with components purchased from US suppliers. Kenall has not determined the origin of its domestically purchased components or the subcomponents thereof.

www.kenall.com  
P: 847-360-8200 F: 847-360-1781  
1020 Lakeside Drive Gurnee, Illinois 60031  
© 2010 Kenall Mfg. Co. All rights reserved.

# MedMaster Auracyl™ Sconce for MRI Suites

MRIMAS838 SERIES

Wall Mount  
Lamps: LED  
ADA Compliant  
Non-Ferrous

Dimensions  
Nominal 8" x 38"  
Nominal Luminous Opening 6" x 32"

## PROJECT INFORMATION

|                |  |
|----------------|--|
| Job Name       |  |
| Fixture Type   |  |
| Catalog Number |  |
| Approved by    |  |

## SPECIFICATIONS



**HOUSING:** Non-ferrous marine grade extruded aluminum. Non-ferrous marine grade die-cast aluminum end caps. TGIC polyester powder coat finish – 5-stage pre-treatment; Salt spray test: 1,000 hours.

**REFLECTOR:** Die-formed non-ferrous marine grade aluminum. Full reflector/wire cover – 92% reflectivity.

**DECORATIVE OUTER LENS:** Acrylic translucent white lens standard. Nominal thickness .125". Optional decorative Lumicor® resins – see Ordering Information.

**INNER LENS:** UV stabilized, high impact resistant, extruded 100% DR/acrylic frost lens. Nominal thickness .100". Lens secured in place by lens frame.

**OUTER LENS:** Refer to optional Decorative Outer Lens selections below.

**ELECTRICAL:** High brightness 3000K or 4000K LED light source. Luminaire input 24V DC from remote-mounted, 120-240V AC, high power factor power supply (MRIPS-312 ordered separately). Dimming capability controlled through compatible 0-10V dimmer (supplied by others). MRI room EMI filter required (supplied by others).

**HARDWARE:** One non-ferrous stainless steel Phillips head fastener standard; six fasteners with IP64 option. Internal brackets and fasteners are non-ferrous and non-corrosive.

**INSTALLATION:** Standard six-point mounting required. All power and signal wiring must be completely shielded in grounded conduit.

**PHOTOMETRICS:** For photometric information, go to [www.kenall.com](http://www.kenall.com).

**PATENT:** U.S. Patent No. 7,029,139.

**WARRANTY:** One year warranty on mechanical defects. Three year warranty on LED lamps and internal power regulation components for defects resulting in a fixture lumen depreciation of 30% or greater. Warranty is void if all wiring is not completely shielded in grounded conduit.

**LISTINGS:** Luminaire is certified to UL 1598 and UL 8750 standards by Intertek Testing Services – covered ceiling and wall mount. NSF2 Splash Non-Food Zone. ADA compliant. Optional ETL certified IP64 in compliance with IEC 60598.



## DIMENSIONAL DATA

Cross Section

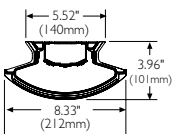

Installation Details

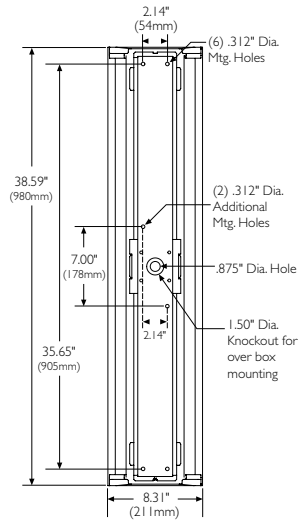

## DECORATIVE OUTER LENS



\*Lumicor® Lumiclear™ Acrylic Resin  
\*\*Lumicor® Lumiform™ PETG Resin

## FRAME FINISH



## ORDERING INFORMATION

| Series                | Frame Type  | Decorative Outer Lens  | Finish   | Lamp Quantity | Lamp Type                 | Voltage   | Options   |
|-----------------------|---|--|--|---------------|---------------------------|-----------|---|
| <b>MRIMAS838</b>      | <b>PAN</b>  |  |  | <b>1</b>      |                           | <b>24</b> |   |
| Frame Type            | PAN Pane  | Finish   | MB Matte Black (Antimicrobial finish on exposed surfaces of installed luminaire) | Lamp Quantity | 1 One Lamp                | Voltage   | 24 24 Volts DC (MRIPS-312 Power Supply required – order separately) |
| Decorative Outer Lens | AS Frosted Acrylic (Standard)   | MW Matte White (Antimicrobial finish on exposed surfaces of installed luminaire) | WS Warm Satin Painted Anodized   | Lamp Type     | 32L3K 32 Watt LED (3000K) | Options   | IP64 IP64 certified to IEC 60598                                    |
|                       | CAP Clear Acrylic w/Inner Perforation that is painted to match housing/frame finish | CS Cool Satin Painted Anodized   | BR Bronze (Architectural)  |               | 32L4K 32 Watt LED (4000K) |           |   |
|                       | NL* Acrylic Natural Leaf  | BE Beige   | CC Custom Color (Consult factory)  |               |                           |           |   |
|                       | SS* Acrylic Silver Spun   |  |  |               |                           |           |   |
|                       | OL* Acrylic Oyster Linen  |  |  |               |                           |           |   |
|                       | ST* Acrylic Saffron Taipei  |  |  |               |                           |           |   |
|                       | PL** PETG Paper Leaf  |  |  |               |                           |           |   |
|                       | CD Custom Decorative Lens (Consult factory)   |  |  |               |                           |           |   |

| Luminaire Number | Amps/ Luminaire | Max. Luminaires/ Power Supply/per room |
|------------------|-----------------|--|
| MRIMAS838        | 1.3             | 8                                      |

MRIMAS838-051810



The Kenall product shown or described on this page is manufactured in the USA with components purchased from US suppliers. Kenall has not determined the origin of its domestically purchased components or the subcomponents thereof.

www.kenall.com  
P: 847-360-8200 F: 847-360-1781  
1020 Lakeside Drive Gurnee, Illinois 60031  
© 2010 Kenall Mfg. Co. All rights reserved.

# MedMaster Auracyl™ Sconce for MRI Suites

MRIMAS850 SERIES

Wall Mount  
Lamps: LED  
ADA Compliant  
Non-Ferrous

Dimensions  
Nominal 8" x 50"  
Nominal Luminous Opening 6" x 41"

## PROJECT INFORMATION

|                |       |
|----------------|-------|
| Job Name       | _____ |
| Fixture Type   | _____ |
| Catalog Number | _____ |
| Approved by    | _____ |



**HOUSING:** Non-ferrous marine grade extruded aluminum. Non-ferrous marine grade die-cast aluminum end caps. TGIC polyester powder coat finish – 5-stage pre-treatment; Salt spray test: 1,000 hours.

**REFLECTOR:** Die-formed non-ferrous marine grade aluminum. Full reflector/wire cover – 92% reflectivity.

**DECORATIVE OUTER LENS:** Acrylic translucent white lens standard. Nominal thickness .125". Optional decorative Lumicor® resins – see Ordering Information.

**INNER LENS:** UV stabilized, high impact resistant, extruded 100% DR/acrylic frost lens. Nominal thickness .100". Lens secured in place by lens frame.

**OUTER LENS:** Refer to optional Decorative Outer Lens selections below.

**ELECTRICAL:** High brightness 3000K or 4000K LED light source. Luminaire input 24V DC from remote-mounted, 120-240V AC, high power factor power supply (MRIPS-312 ordered separately). Dimming capability controlled through compatible 0-10V dimmer (supplied by others). MRI room EMI filter required (supplied by others).

**HARDWARE:** One non-ferrous stainless steel Phillips head fastener standard; six fasteners with IP64 option. Internal brackets and fasteners are non-ferrous and non-corrosive.

**INSTALLATION:** Standard six-point mounting required. All power and signal wiring must be completely shielded in grounded conduit.

**PHOTOMETRICS:** For photometric information, go to [www.kenall.com](http://www.kenall.com).

**PATENT:** U.S. Patent No. 7,029,139.

**WARRANTY:** One year warranty on mechanical defects. Three year warranty on LED lamps and internal power regulation components for defects resulting in a fixture lumen depreciation of 30% or greater. Warranty is void if all wiring is not completely shielded in grounded conduit.

**LISTINGS:** Luminaire is certified to UL 1598 and UL 8750 standards by Intertek Testing Services – covered ceiling and wall mount. NSF2 Splash Non-Food Zone. ADA compliant. Optional ETL certified IP64 in compliance with IEC 60598.



SPECIFICATIONS

Cross Section

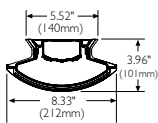

Installation Details

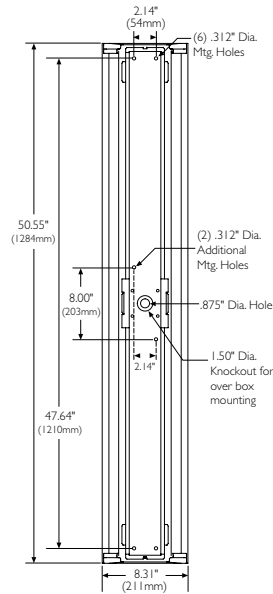

## DECORATIVE OUTER LENS

|                               |                                       |                  |                 |
|-------------------------------|---------------------------------------|------------------|-----------------|
| AS Frosted Acrylic (Standard) | CAP Clear Acrylic w/Inner Perforation | NL Natural Leaf* | SS Silver Spun* |
| OL Oyster Linen*              | ST Saffron Taipei*                    | PL Paper Leaf**  |                 |

\*Lumicor® Lumiclear™ Acrylic Resin  
\*\*Lumicor® Lumiform™ PETG Resin

## FRAME FINISH

|                           |                |                                |                                |
|---------------------------|----------------|--------------------------------|--------------------------------|
| MB Matte Black            | MW Matte White | WS Warm Satin Painted Anodized | CS Cool Satin Painted Anodized |
| BR Bronze (Architectural) | BE Beige       |                                |                                |

DIMENSIONAL DATA

| Series                | Frame Type  | Decorative Outer Lens   | Finish  | Lamp Quantity | Lamp Type  | Voltage   | Option   |
|-----------------------|---|---|---|---------------|--|-----------|--|
| <b>MRIMAS850</b>      | <b>PAN</b>  |   |   | <b>1</b>      |  | <b>24</b> |  |
| Frame Type            | PAN Pane  | Finish  | MB Matte Black<br>(Antimicrobial finish on exposed surfaces of installed luminaire) | Lamp Quantity | 1 One Lamp   | Voltage   | 24 24 Volts DC<br>(MRIPS-312 Power Supply required – order separately) |
| Decorative Outer Lens | AS Frosted Acrylic (Standard)   | MW Matte White<br>(Antimicrobial finish on exposed surfaces of installed luminaire) | WS Warm Satin Painted Anodized  | Lamp Type     | 41L3K 41 Watt LED (3000K)<br>41L4K 41 Watt LED (4000K) | Options   | IP64 IP64 certified to IEC 60598                                       |
|                       | CAP Clear Acrylic w/Inner Perforation that is painted to match housing/frame finish | CS Cool Satin Painted Anodized  | BR Bronze (Architectural)   |               |  |           |  |
|                       | NL* Acrylic Natural Leaf  | BE Beige  | CC Custom Color (Consult factory)   |               |  |           |  |
|                       | SS* Acrylic Silver Spun   |   |   |               |  |           |  |
|                       | OL* Acrylic Oyster Linen  |   |   |               |  |           |  |
|                       | ST* Acrylic Saffron Taipei  |   |   |               |  |           |  |
|                       | PL** PETG Paper Leaf  |   |   |               |  |           |  |
|                       | CD Custom Decorative Lens (Consult factory)   |   |   |               |  |           |  |

MRI LUMINAIRE CONNECTION PER POWER SUPPLY

| Luminaire Number | Amps/ Luminaire | Max. Luminaires/ Power Supply/per room |
|------------------|-----------------|--|
| MRIMAS850        | 1.7             | 6                                      |

ORDERING INFORMATION

MRIMAS850-051810



The Kenall product shown or described on this page is manufactured in the USA with components purchased from US suppliers. Kenall has not determined the origin of its domestically purchased components or the subcomponents thereof.

www.kenall.com  
P: 847-360-8200 F: 847-360-1781  
1020 Lakeside Drive Gurnee, Illinois 60031  
© 2010 Kenall Mfg. Co. All rights reserved.

# External Power Supply for MRI MedMaster™ Downlight, Auracyl™ Sconce, and Stratalume™ Undercabinet

MRIPS-312

REMOTE MOUNT

PROJECT INFORMATION

Dimensions

Nominal 13.5" x 8.5"

Job Name

Fixture Type

Catalog Number

Approved by

## SPECIFICATIONS

**HOUSING:** Die formed marine grade extruded aluminum. Black TGIC polyester powder coat finish – 5-stage pre-treatment; Salt spray test: 1,000 hours.

### ELECTRICAL:

Input: 120~240 VAC, 50/60 Hz.  
Active PFC Function, PF>0.95.  
Output: Constant-voltage DC output.  
Factory preset at 24VDC, adjustable range 20~26.4VDC.  
Maximum current load 13ADC.

**WARRANTY:** This product is warranted by Kenall Manufacturing to be free of defects in workmanship and materials for a period of one year from the date of invoice. The DC power supply contained in the enclosure carries a three year warranty from the date of invoice. Warranty is void if all wiring is not completely shielded in grounded conduit.

**LISTINGS:** Power supply is certified to UL1012 and CSA C22.2 No. 107.1 by Intertek Testing Services. Dry Location only.

**NOTE:** See Kenall luminaire specifications that utilize remote power supplies for use with this unit.

## INSTALLATION

**WIRING/CONDUIT:** All power and signal wiring must be completely shielded in grounded conduit. Total length of low-voltage supply wires, at least 18AWG, from power supply to filter to luminaires, should not exceed 50 feet (15m).

**EMI FILTERS:** All MRI room EMI filters must be sized as suitable for power supply load (supplied by others).

**AMBIENT TEMPERATURE/HUMIDITY:** The surrounding ambient temperature must remain below 104°F (40°C). The working temperature is between -20~+65°C. Allowable relative humidity is 20~90% non-condensing.

**PRODUCT LOCATION:** The MRIPS-312 power supply must be installed outside the shielded MRI environment. It contains ferrous components that can damage or interfere with MRI equipment. A minimum free-air spacing must exist of 3" around all sides and 6" over exhaust fan. Location should not allow excessive dirt/dust to clog ventilation holes and prevent internal air circulation.

### MRI LUMINAIRE CONNECTION PER POWER SUPPLY

| Luminaire Number | Amps/Luminaire | Max. Luminaires/per Power Supply/per room |
|------------------|----------------|---|
| CSMRI22          | .75            | 16  |
| CSMRI24          | 1.5            | 8   |
| CSMRI44          | 3.5            | 3   |
| MRIDL6VL2        | 1.4            | 8   |
| MRIMAS813 (9W)   | 0.4            | 28  |
| MRIMAS813 (16W)  | 0.7            | 16  |
| MRIMAS826        | 1.0            | 10  |
| MRIMAS838        | 1.3            | 8   |
| MRIMAS850        | 1.7            | 6   |
| MRIAUC 18        | 0.7            | 16  |
| MRIAUC 36        | 1.4            | 8   |

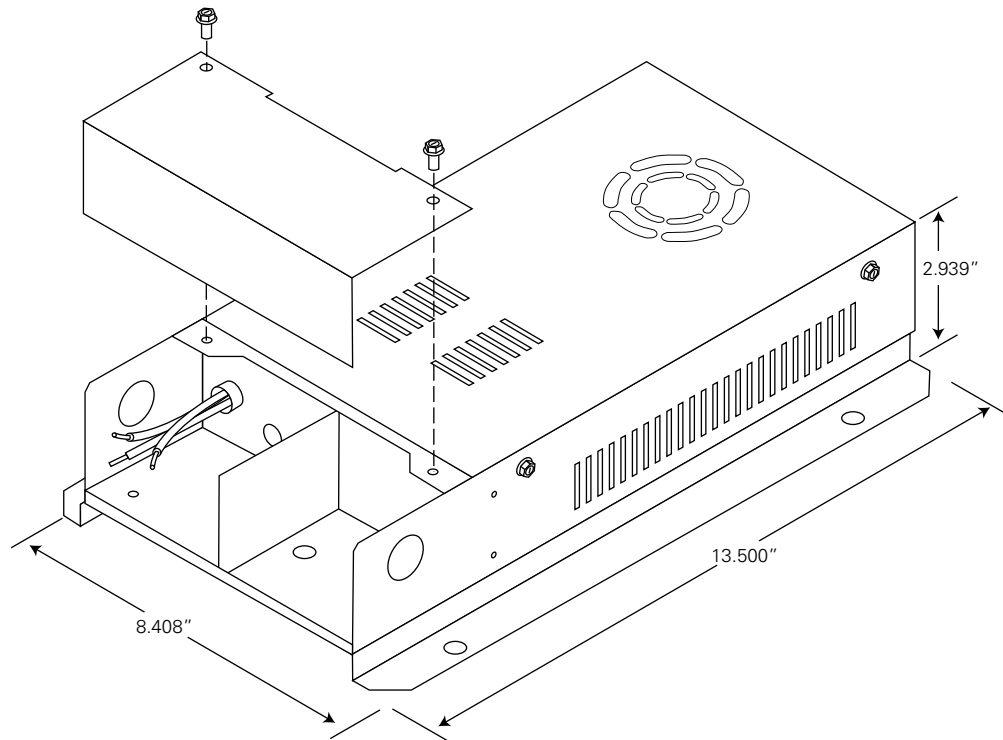

MRIPS-312-043010



The Kenall product shown or described on this page is manufactured in the USA with components purchased from US suppliers. Kenall has not determined the origin of its domestically purchased components or the subcomponents thereof.

www.kenall.com  
P: 847-360-8200 F: 847-360-1781  
1020 Lakeside Drive Gurnee, Illinois 60031  
© 2010 Kenall Mfg. Co. All rights reserved.

## ELECTROMAGNETIC INTERFERENCE (EMI) TESTING / MILITARY STANDARD 461E / NSF LISTINGS

Electromagnetic Interference (EMI) has long been a critical concern in scientific and healthcare facilities where it can cause the malfunction of life support and monitoring systems, surgical devices, and other electrically sensitive medical and scientific equipment. In recent years, concern over EMI has become widespread due to its potential impact on security systems, communications, manufacturing equipment, and a variety of sensitive electronic devices.

### LIMITATIONS OF REQUIRED EMI STANDARDS

Unlike the European Community, the U.S. has no comprehensive standard for lighting-based EMI. Because high-frequency electronic ballasts operate within radio, television, and other established communications bandwidths, the Federal Communications Commission (FCC) issues standards for Electromagnetic Compatibility (EMC) between certain devices as well as maximum radiated electromagnetic emissions levels for some equipment, including electronic ballasts.

FCC listings do not, however, provide a standard for fluorescent lamps – also radiators of EMI – or for complete luminaires. Further, the FCC does not issue standards for conducted emissions. The Food & Drug Administration (FDA) issues EMC standards for certain medical devices operating outside the FCC's jurisdiction, but these standards typically do not apply to light luminaires.

### MILITARY STANDARD 461E

The most comprehensive, widely recognized and acknowledged domestic EMI standard is Military Standard, MIL-STD-461E, a mandatory standard for military hospitals and other EMI sensitive military facilities and a voluntary standard for public and private facilities applications. MIL-STD testing measurements cover both radiated and conducted emissions in addition to maximum allowable amounts of emitted energy based on both frequency range and field strength. The MIL-STD-461E testing procedures and requirements appropriate to light luminaires are found under Navy and Air Force Limits for Electronic Devices, with the specific testing information

for conducted emissions outlined in CE 102-1 and for radiated emissions in RE 102-4. While both are designed to emulate worst case operating conditions, both the test procedures and the standards themselves are logical and reasonable.

Because MIL-STD-461E standards are harder to meet than either the FCC or European Community standards, luminaires meeting them pose the lowest possible likelihood of causing EMI-related problems.

### APPROPRIATE STANDARDS & GOVERNMENT CERTIFIED LABS

There are some particularly important things to consider when evaluating or specifying luminaires for EMI sensitive applications.

First, in order to make sure the tests have been performed correctly and with procedural exactness, verify that the testing laboratory is accredited by either the National Institute of Standards and Technology (NIST) or the U.S. Dept. of Commerce (DOC).

Second, check to see that the electromagnetic emissions have been measured from an application distance of one meter, as some labs incorrectly take these measurements from as far as 10 meters from the source.

Third, do not accept any manufacturer's assurance that because the luminaire's ballast carries an FCC listing, it meets safety requirements, since the ballast is only one potential source of EMI.

### MedMaster™ LUMINAIRES & EMI

Kenall MedMaster luminaires have been tested and proven to be in compliance with MIL-STD-461E by an independent laboratory (DLS Electronic Systems, Inc.) accredited by both NIST and the U.S. DOC. Copies of test reports are available from Kenall Manufacturing Co.

### MRI EQUIPMENT

While MIL-STD-461E is the best assurance that equipment produces low noise, all lighting products should be designed and evaluated to operate within an acceptable MRI machine signal to noise ratio.

### NSF — NATIONAL SANITATION FOUNDATION LISTINGS

Kenall lighting luminaires for use in food processing, handling and preparation areas have been investigated and listed by the National Sanitation Foundation (NSF) as conforming to the requirements in their criteria C2.

The purpose of criteria C2 is to ensure that equipment located in a food storage, handling, or preparation area will not compromise the sanitation requirements for those areas. Equipment listed to criteria C2 has been evaluated as to its corrosion resistance, its cleanability, and its exposed material.

Specifically, exposed materials shall withstand normal wear, the corrosive action of foods, beverages, and cleaning compounds, and the material itself shall not impart an odor, color, taste, or toxic material to any food that would come in contact with it.

Within this category, NSF defines the surfaces of equipment as Food Contact or Non-Food Contact surfaces. The Food Contact surfaces are further divided into areas as Food Zone, Splash Zone, and Non-Food Zone, with Food Zone requirements being the most stringent and Non-Food Zone being the least stringent.

### SPLASH ZONES (SN)

All exposed sheet metal will be painted CRS, painted aluminum, or anodized aluminum. Fasteners will be stainless steel, and lenses can be acrylic, polycarbonate, or tempered glass, all with prisms on inside.

Kenall cannot recommend which level of construction is suitable for your specific application as the final decision will rest with the local inspector.



With its NSF2 listing, the Kenall Auracyl™ Sconce will stand up to cleaning (non-abrasive) protocols in demanding environments.

**INGRESS PROTECTION RATINGS**

**LIMITATIONS OF WET & HOSEDOWN RATINGS – UL STANDARDS**

UL standards for “wet” type ratings only offer a wet location rating, which simulates an outdoor rain condition. UL standards for a type 4 or NEMA 4 “hosedown” rating use a 1 inch diameter nozzle on a fire hose delivering 65 gallons of water per minute. Various conditions exist where a luminaire requires a rating better than a wet location label but not NEMA 4. These conditions typically exist in washdown applications where hose directed water or cleaning agents will be directed at the luminaire.

**INGRESS PROTECTION FOR LIGHTING LUMINAIRES – IEC60598**

IP water rating of “4” (IP\_4) means the luminaire will withstand splashing water. The luminaire is switched on, then sprayed from every direction for 10 minutes. Then it is switched off and allowed to cool naturally while the water spray is continued for an additional 10 minutes.

**DUST-TIGHT PROTECTION**

An additional test criterion that can be applied to luminaires is the ability to exclude solid matter. The IP solid rating of “6” (IP6\_) means the fixture will be dust tight. The specified test requires that the fixture be placed in a circulating talc atmosphere for 3 hours. The particle size of the talc is a range of one to 75 microns and the fixture is placed under negative pressure in an attempt to draw the talc into the fixture. No talc shall be found inside the fixture after this test.

**THE IMPORTANCE OF RECOGNIZED STANDARDS & INDEPENDENT TESTING**

Other lighting manufacturers that claim a hosedown rating other than NEMA or IP are not testing to recognized standards and cannot have the tests confirmed or audited by an independent outside testing agency.

Beware of statements such as “Tested to 75psi at 1 inch.” No reference is made to the volume of water that is leaving the nozzle and impacting the product.

In fact, high nozzle pressures typically have low water volumes because the nozzle is restricting the flow of water causing the pressure in the hose to increase, minimizing the amount of water leaving the nozzle.

**WHAT ARE IEC STANDARDS?**

IEC Standards are international standards adopted by many European countries. North America has traditionally adopted UL (Underwriters Laboratories) standards as the source for standards. U.S. product manufacturers designed their products to IEC standards initially for sale overseas but are finding them increasingly useful here in North America.

IP ratings also provide an internationally accepted standard which can be used to evaluate luminaires or any other electrical equipment, and the tests can be performed by an independent third party testing agency for verification. Underwriters Laboratories in Northbrook, Illinois investigates products and tests to the IEC standard.

**IP64 RATING – NUMERAL ASSIGNMENTS AND EXPLANATIONS**

| Numeral     | Short Description                                      | Excluded from Enclosure  |
|-------------|--|--|
| <b>IP64</b> | <b>6</b> = Dust tight                                  | No ingress of dust   |
| <b>IP64</b> | <b>4</b> = Protected against splashing water enclosure | Water splashed against the enclosure from any direction shall have no harmful effect |

With Kenall’s ongoing product improvement program, technical specifications are subject to change without notice. Please consult Kenall or your local authorized Kenall representative to verify you have the most current specifications for this and other selected Kenall products.

# LED LIGHTING FACTS

## DEPARTMENT OF ENERGY SSL QUALITY ADVOCATE PROGRAM FOR LED LUMINAIRES

As a member of the Department of Energy's SSL Quality Advocates, Kenall Manufacturing has pledged to include the Lighting Facts label in conjunction with our LED luminaires. The label reports product performance results in five areas from actual test data\* in accordance with industry standards measuring photometric performance of LEDs:

- Luminaire light output
- Efficacy (lumens per watt)
- Measured power (watts)
- Correlated Color Temperature
- Color Rendering Index

\* Luminaire measurements have been standardized with the issuance of the IESNA Standard LM-79-2008 test procedure.

**Light Output/Lumens**  
Measures light output. The higher the number, the more light is emitted.  
Reported as "Total Integrated Flux (Lumens)" on LM-79 test report.

**Watts**  
Measures energy required to light the product. The lower the wattage, the less energy used.  
Reported as "Input Power (Watts)" on LM-79 test report.

**Lumens per Watt/Efficacy**  
Measures efficiency. The higher the number, the more efficient the product.  
Reported as "Efficacy" on LM-79 test report.

**IESNA LM-79-2008**  
Industry standardized test procedure that measures performance qualities of LED luminaires and integral lamps. It allows for a true comparison of luminaires regardless of the light source.

**Lighting Facts™  
SAMPLE LABEL**

---

- **Light Output (Lumens)** **725**
- **Watts** **21**
- **Lumens per Watt (Efficacy)** **34**

---

**Color Accuracy** **87**  
Color Rendering Index (CRI)

---

**Light Color**  
Correlated Color Temperature (CCT) **2980K**

2600K    3200K    4500K    6500K

---

Visit [www.lighting-facts.com](http://www.lighting-facts.com) for the **Label Reference Guide**.

All results are according to IESNA LM-79-2008: Approved Method for the Electrical and Photometric Testing of Solid-State Lighting.

**Kenall Manufacturing, XXX813AS22L3K**

**Color Rendering Index (CRI)**  
Measures color accuracy.  
Color rendition is the effect of the lamp's light spectrum on the color appearance of objects.

**Correlated Color Temperature (CCT)**  
Measures light color.  
"Cool" colors have higher Kelvin temperatures (3600-5500K); "warm" colors have lower color temperatures (2700-3500K).

**Brand & Model Number**

# EASE OF MAINTENANCE



The Medmaster Auracyl™ Sconce was designed with ease of maintenance in mind. To change the lamp, simply remove one fastener and lift off frame/lens assembly. (Please see installation instruction sheet for IP64 version.)

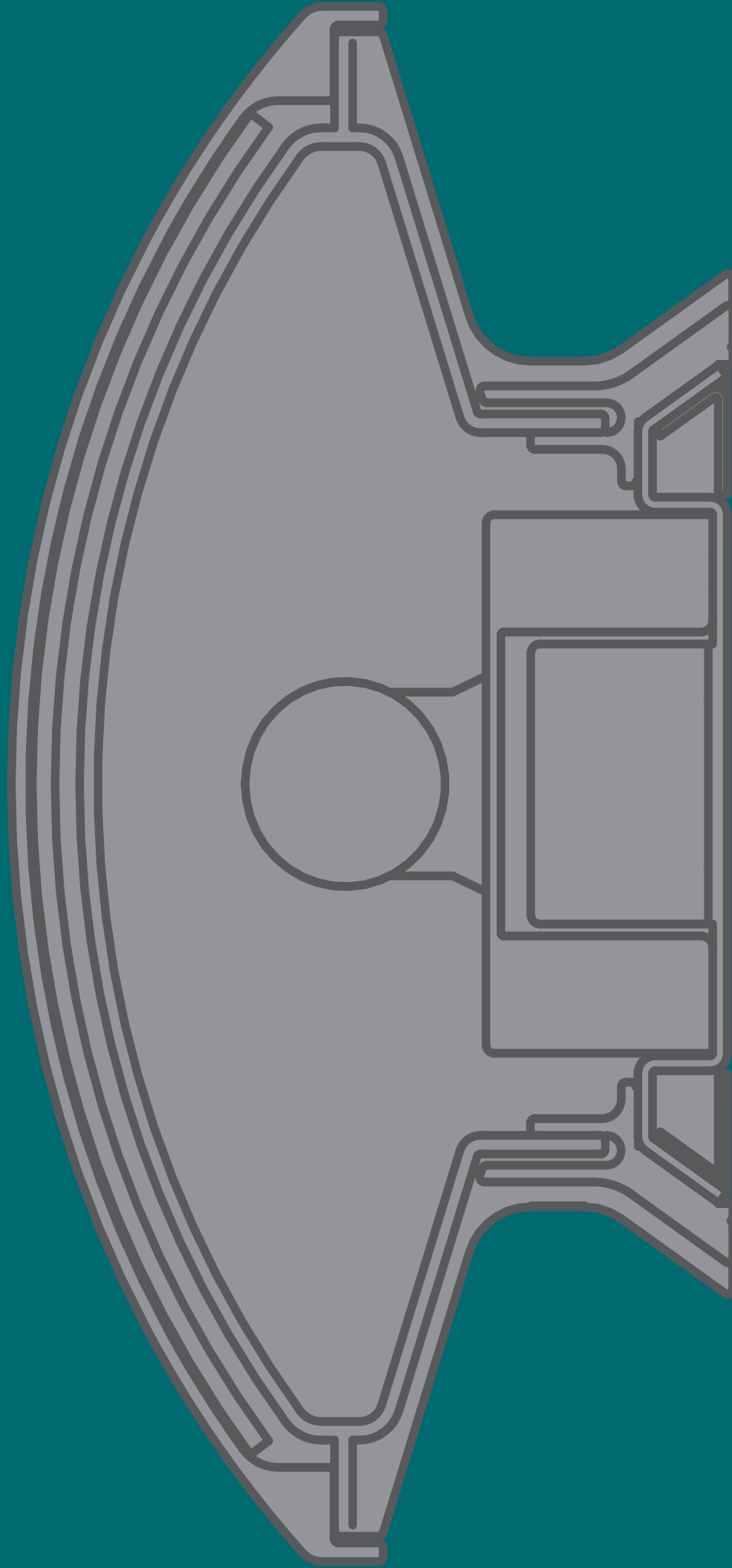

1020 Lakeside Drive  
Gurnee, Illinois 60031

847-360-8200 FAX 847-360-1781

[www.kenall.com](http://www.kenall.com)

©2009 Kenall Mfg. Co. All rights reserved.