

MILLENIUM™ SQUARE

MS11 SERIES – SEMI-RECESSED

PRODUCT FEATURES:

- » Semi-recessed mount – ceiling (FSR & CSR only) or wall mount; 12"W×12W"×3"D (CSR, ESR, FSR) 16"W×16W"×3"D (DSR)
- » Peace of Mind Guarantee®
- » Dust and water protected to IP64 standards
- » ADA Compliant

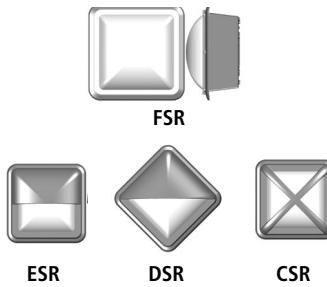

PROJECT INFORMATION

Job Name _____

Fixture Type _____

Catalog Number _____

Approved by _____

SPECIFICATIONS

HOUSING (SERIES PP, ND, CO): Marine grade die-cast aluminum housing with integral heat sinks. Housing interlocks to lens base producing maximum moisture deflection and resistance to prying. Standard dark bronze exterior TGIC polyester powder coat – 5-step pre-treatment.

HOUSING (SERIES NL, CC): 18-gauge CRS housing. Housing interlocks to lens base producing maximum moisture deflection and resistance to prying. Standard matte white exterior TGIC polyester powder coat – 5-step pre-treatment.

REFLECTOR: Full reflector/wire cover – 92% reflectivity.

LENS: UV-stabilized, high impact resistant, virgin injection molded polycarbonate or acrylic. High efficiency blondel fluted lens maximizes uniformity. Lens secured with four concealed captive Torx® with center pin fasteners. Exclusive water channeling lens design provides 360° ingress protection.

LENS BASE: Marine grade die-cast aluminum. Lens base shields lamp from viewing angles. Standard matte black, dark bronze or matte white exterior TGIC polyester powder coat finished – 5-step pre-treatment. See Ordering Information for optional finishes.

EYELID/GRILLE: High impact resistant, injection molded matte black, dark bronze or matte white polycarbonate. Optional Light Gray, Silver, Forest Green or Custom Color (see Ordering Information below) are chemically bonded, impact resistant finishes.

GASKETING: Closed cell, silicone "O" ring gaskets positioned in gasket channels of lens base and in Series PP, ND, CO housing.

HARDWARE: Four stainless steel Torx® with center pin fasteners.

ELECTRICAL: Available in 3500K, 4000K, and 5000K color temperatures, 80 CRI. 120-277VAC, 50/60Hz electrical input with high power factor electronic, constant-current driver (>.90 PF). Standard 0-10V dimming with 1-100% range; maximum driver source of 200 µA.

SENSOR & CONTROLS: Optional sensor available with compatible third party controls. To see the full list of compatible controls, [click here](#).

INSTALLATION: See [Technical Data Sheets](#) for semi-recessed installation details, mounting options and rough-in box part number.

PHOTOMETRICS: Photometry tested to the IESNA LM-79-08 standard by an ILAC/ISO17025 accredited laboratory. For additional photometric information, go to www.kenall.com.

WARRANTY: Limited five (5) year LED warranty. [Peace of Mind Guarantee against breakage](#).

LISTINGS: UL and CUL listed for Wet Location (listing includes Emergency Battery Pack "LEL" option). UL certified IP64 per IEC 60598.



ORDERING INFORMATION (Ex: MS11ESR-ND-PP-MB-20L40K-DV)

Model	Mounting	Lens Type	Finish	Lamp Type	Voltage	Options	Accessories
		PP					
Model			Finish			Options	
MS11CSR	Crossbar		MB Matte Black			LEL† LED Emergency Battery Backup (n/a with 347V)	
MS11DSR	Diamond Eyelid		MW Matte White			20KV 20KV/KA Surge Protection per IEEE/ANSI C62.41.2 Cat. A	
MS11ESR	Eyelid		DB Dark Bronze			FS Single Fuse & Holder	
MS11FSR	Full Face		LG Light Gray			NAT Natatorium Environment Option	
			SL Silver				
			FG Forest Green				
			CC Custom Color (Consult factory)				
Mounting Type			Lamp Type			Accessories	
PP	Pour-in-Place or Masonry		10L35K	10 Watt 3500K LED		9500 Torx® Screwdriver	
ND	Non IC (Deep Profile)		10L40K	10 Watt 4000K LED			
NL	Non IC (Low Profile)		10L50K	10 Watt 5000K LED			
CC*	Canopy (Covered Top)		20L35K	20 Watt 3500K LED		* Ceiling mounting only (MS11CSR, MS11FSR only)	
CO*	Canopy (Open Top)		20L40K	20 Watt 4000K LED		† LEL and 20KV options not available in conjunction	
			20L50K	20 Watt 5000K LED			
Lens Type			Voltage				
PP	Pearlescent Polycarbonate		347	347 Volts			
			DV	120-277 Volts			



www.kenall.com | P: 800-4-Kenall | F: 262-891-9701 | 10200 55th Street Kenosha, Wisconsin 53144, USA

This product complies with the Buy American Act: manufactured in the United States with more than 50% of the component cost of US origin. It may be covered by patents found at www.kenall.com/patents. Content of specification sheets is subject to change; please consult www.kenall.com for current product details. ©2022 Kenall Mfg. Co.

A brand of Legrand

MILLENIUM™ SQUARE

MS11 SERIES – SEMI-RECESSED

PERFORMANCE

Model	Lamp Type	Initial Delivered Lumens		Input Power (W)	Drive Current (mA)	Estd. L70 LED Life (hrs)
		@ 25°C (lm)	Efficacy (lm/W)			
MS11FSR	10L35K	1,307	102	13	94	130,000
	10L40K	1,307	102	13	94	130,000
	10L50K	1,425	111	13	94	130,000
	20L35K	2,523	106	24	94	130,000
	20L40K	2,523	106	24	94	130,000
	20L50K	2,750	116	24	94	130,000
MS11CSR	10L35K	1,050	82	13	94	130,000
	10L40K	1,050	82	13	94	130,000
	10L50K	1,144	89	13	94	130,000
	20L35K	2,026	85	24	94	130,000
	20L40K	2,026	85	24	94	130,000
	20L50K	2,208	93	24	94	130,000
MS11DSR	10L35K	1,070	84	13	54	130,000
	10L40K	1,070	84	13	54	130,000
	10L50K	1,167	91	13	54	130,000
	20L35K	2,067	87	24	94	130,000
	20L40K	2,067	87	24	94	130,000
	20L50K	2,253	95	24	94	130,000
MS11ESR	10L35K	1,023	80	13	94	130,000
	10L40K	1,023	80	13	94	130,000
	10L50K	1,116	87	13	94	130,000
	20L35K	1,975	83	24	94	130,000
	20L40K	1,975	83	24	94	130,000
	20L50K	2,153	91	24	94	130,000

Info subject to change. Visit www.kenall.com for IES files and additional information.

Model: MS11FSR-PP-MW-20L40K-DCC-DV

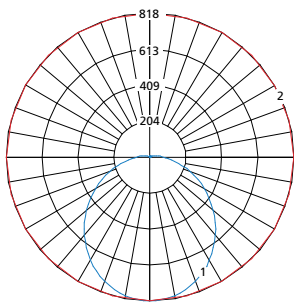

Max Candela = 818 Located At Horizontal Angle = 0, Vertical Angle = 0
 1 - Vertical Plane Through Horizontal Angles (0-180) (Through Max. Cd.)
 2 - Horizontal Cone Through Vertical Angle (0) (Through Max. Cd.)

Model: MS11ESR-PP-MW-20L40K-DCC-DV

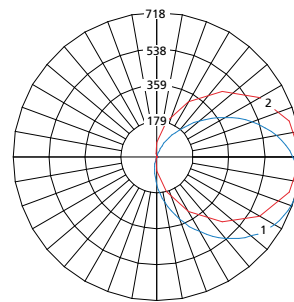

Max Candela = 718 Located At Horizontal Angle = 0, Vertical Angle = 65
 1 - Vertical Plane Through Horizontal Angles (0-180) (Through Max. Cd.)
 2 - Horizontal Cone Through Vertical Angle (65) (Through Max. Cd.)



www.kenall.com | P: 800-4-Kenall | F: 262-891-9701 | 10200 55th Street Kenosha, Wisconsin 53144, USA

This product complies with the Buy American Act: manufactured in the United States with more than 50% of the component cost of US origin. It may be covered by patents found at www.kenall.com/patents. Content of specification sheets is subject to change; please consult www.kenall.com for current product details. ©2022 Kenall Mfg. Co.

A brand of **legrand**

MILLENIUM™ SQUARE

MS11 SERIES – SEMI-RECESSED

DIMENSIONAL DATA

SERIES PP, ND, CO (SIDE & BACK VIEW)

MS11FSR, CSR, ESR

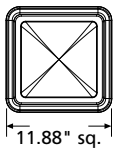

MS11DSR



MS11FSR, CSR, ESR

(2) 3/4" NPT
Top & Bottom (Plugged)

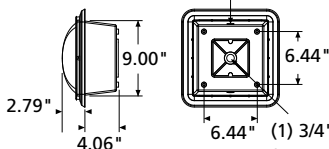

MS11DSR

(2) 3/4" NPT
Top & Bottom (Plugged)

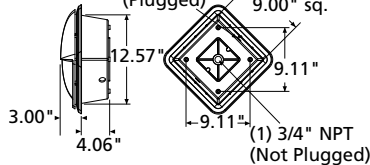

SERIES NL, CC (SIDE & BACK VIEW)

MS11FSR, CSR, ESR

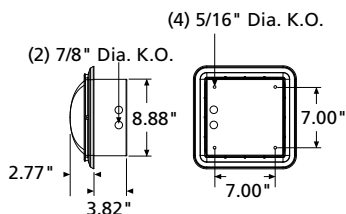

MS11DSR

