

MILLENIUM STRETCH™

MLRS5V SERIES – VANITY

PRODUCT FEATURES:

- » 5" linear wall mount luminaire for bathroom vanity applications
- » Extruded aluminum housing with decorative end caps
- » Low-profile –ADA compliant
- » Suitable for Damp Location environments

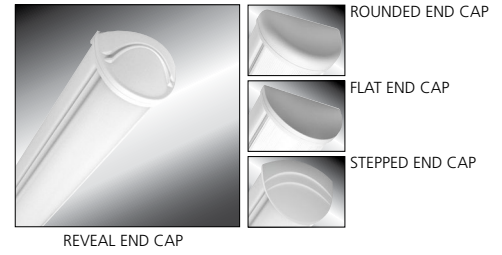

SPECIFICATIONS

HOUSING: Extruded marine grade aluminum body with die-cast aluminum end caps. TGIC polyester powder coat finished – 5-step pre-treatment. See Ordering Information for available finishes.

OPTIC: UV-Stabilized, high-efficiency diffused polycarbonate with smooth exterior and linear prismatic interior. Lens securely positioned in body channels and endcaps, locked into place with concealed tamper-resistant Torx® T-20 with center pin fasteners.

END CAPS: Marine grade die-cast aluminum. Four styles available: Flat, Rounded, Reveal and Stepped.

HARDWARE: Four stainless steel, tamper-resistant Torx® T-20 with center pin fasteners secure lens in housing body's lens channel.

LED MODDULE: Serviceable mid-power LED array. Minimum 80 CRI standard (R9>0), consult factory for optional 90CRI (R9>50). Maximum three-step MacAdam ellipse variation. See Ordering Information for available color temperature options.

DRIVER: 120-277VAC or 347VAC, 50/60Hz electrical input with serviceable constant-current driver (<20% THD, >0.90 PF). Minimum 85% driver efficiency. Standard 0-10V dimming with 1-100% range and dim-to-dark capabilities; 0.2mA maximum source current.

SENSOR & CONTROLS: Available with compatible third party controls. To see the full list of compatible controls, [click here](#).

INSTALLATION: Four-point mounting recommended. Horizontal or vertical wall-mount orientation.

WARRANTY: Limited ten (10) year LED warranty.

LISTINGS: Luminaire is certified to UL standards by Intertek Testing Laboratories for Damp Location - Horizontal and Vertical Wall Mount. ADA Compliant.



ORDERING INFORMATION (Ex: MLRS5V-48-RV-LG-PP-45L35K-DCC-DV-PH)

Model	Length	End Cap	Finish	Lens	Lamp Code	Driver Type	Voltage	Options
MLRS5V	48			PP		DCC		
	Length			Lens		Driver Type		
	48 4'			PP Pearlescent Polycarbonate		DCC 0-10V Dimming Constant Current		
	End Caps			Lamp Code		Input Voltage		
	F Flat			45L35K 45 Watt 3500K LED		DV 120-277 VAC, 50/60Hz		
	R Rounded			45L40K 45 Watt 4000K LED		347 347 VAC, 60Hz		
	RV Reveal			45L50K 45 Watt 5000K LED		Options		
	SP Stepped					LEL Integral 10W Emergency Battery Backup (0°C minimum operating temperature, n/a with 347V)		
	Finish					CDF Captive Diffuser Fasteners		
	MW Matte White					FS Single Fuse & Holder		
	MB Matte Black					PH Phillips Head Fasteners		
	LG Light Gray							
	CC Custom Color (Consult Factory)							



MILLENIUM STRETCH™

MLRS5V SERIES – VANITY

PERFORMANCE

Lamp Type	Initial Delivered Lumens		Input Power (W)	Drive Current (mA)	Estd. L70 LED Life (Hrs)
	@ 25°C	Efficacy (lm/W)			
45L35K	4246	85	50	94	150,000
45L40K	4526	90	50	94	150,000
45L50K	4707	94	50	94	150,000

Displayed information is for selected luminaires only. Additional wattages and color temperatures are also available. Visit www.kenall.com for additional information.

Model: MLRS5V-48-RV-MW-PP-45L35K-DCC-DV

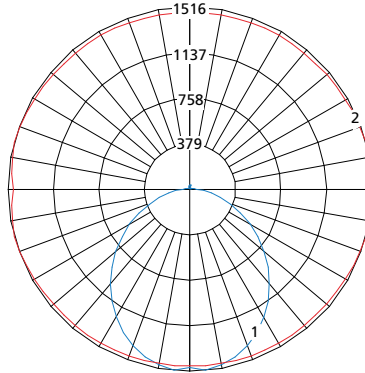

Maximum Candela = 1241 Located At Horizontal Angle = 15, Vertical Angle = 5

- 1 - Vertical Plane Through Horizontal Angles (15-195) (Through Max. Cd.)
- 2 - Horizontal Cone Through Vertical Angle (5) (Through Max. Cd.)

DIMENSIONAL DATA

CROSS SECTION/DETAILS

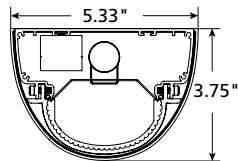

MOUNTING HOLES

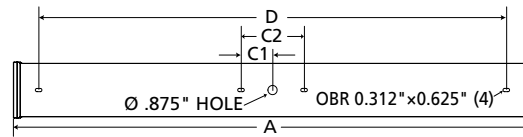

Nominal Four Foot Fixture Legend					
End Cap	A	B	C1	C2	D
SP	52.13	46.25	3.00	6.00	44.48
RV	51.67	46.25	3.00	6.00	44.48

