

**IMPORTANT SAFEGUARDS**

When using electrical equipment, basic safety precautions should always be followed, including the following:

**THIS PRODUCT MUST BE INSTALLED IN ACCORDANCE WITH THE APPLICABLE INSTALLATION CODE BY A PERSON FAMILIAR WITH THE CONSTRUCTION AND OPERATION OF THE PRODUCT AND THE HAZARDS INVOLVED.**

**CE PRODUIT DOIT ÊTRE INSTALLÉ SELON LE CODE D'INSTALLATION PERTINENT, PAR UNE PERSONNE QUI CONNAÎT BIEN LE PRODUIT ET SON FONCTIONNEMENT AINSI QUE LES RISQUES INHÉRENTS.**

DISCONNECT POWER TO ALL CIRCUITS BEFORE WIRING FIXTURE. INSTALL IN ACCORDANCE WITH ALL NATIONAL, STATE, AND LOCAL CODES. DO NOT CONNECT TO AN UNGROUNDED SUPPLY. READ ALL FIXTURE MARKINGS AND LABELS TO ENSURE CORRECT INSTALLATION OF FIXTURE. SUPPLEMENTAL INSTRUCTIONS MAY BE LOCATED ON THE FIXTURE, IN ADDITION TO THIS INSTRUCTION SHEET, REGARDING ORIENTATION, OR MOUNTING RESTRICTIONS.

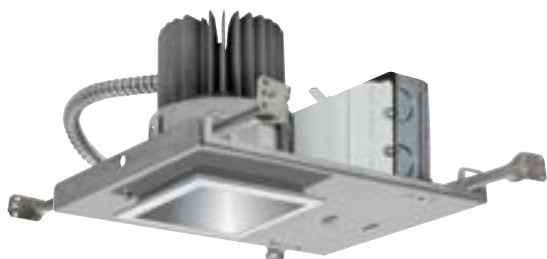

**LED**

**SAVE THESE INSTRUCTIONS**

THE ENVELA DOWNLIGHT CONTAINS SENSITIVE ELECTRONICS. TAKE CARE TO AVOID DAMAGE BY IMPROPER HANDLING OR STATIC ELECTRICITY DISCHARGE (ESD). EITHER TYPE OF DAMAGE COULD RENDER THE SYSTEM INOPERABLE OR CAUSE LATENT FAILURE.

**NEW CONSTRUCTION- DRYWALL CEILING** – RECOMMENDED CEILING CUTOUT- 4.125" SQUARE

Note- 28L or 28T fixtures must be installed minimum 24" center to center, 12" from wall and have 1/2" clearance above the trim.

1. Loosen locking screws to extend hanger bars. See Figure 1.
2. Align bottom of hanger bar tabs to bottom of joist.
3. Secure luminaire hanger bars using nails or screws.
4. Position luminaire as required and lock position by tightening locking screws.
5. Remove junction box cover.
6. Remove appropriate 1/2" knockout(s) and connect to electrical service.
7. Wire per wiring diagram using approved wire connectors. See Figure 2.
8. Replace junction box cover.

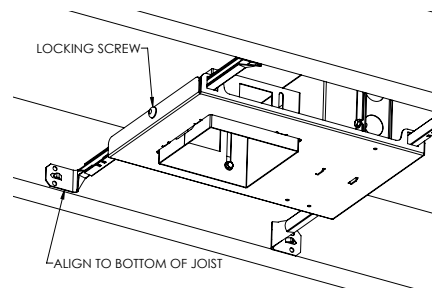

**FIGURE 1**

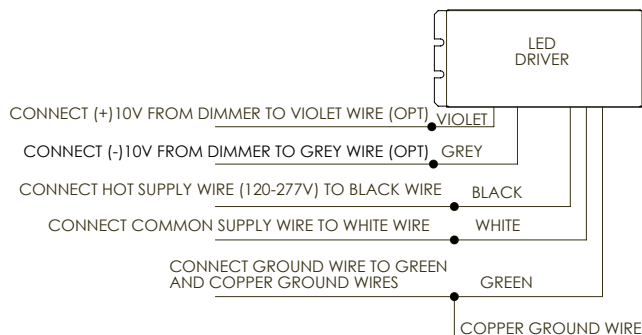
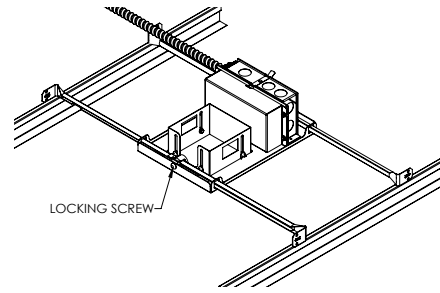

**FIGURE 2**



**GRID CEILING** – RECOMMENDED CEILING CUTOUT- 4.125" × 4.125" SQUARE OPENING

1. Loosen locking screws to extend hanger bars.  
See Figure 3.
2. Position luminaire as required and lock position by tightening locking screws.
3. Attach luminaire securely to grid using brackets, screws and nuts provided or wiring to grid members.  
See Figure 4
4. Remove junction box cover.
5. Remove appropriate 1/2" knockout(s) and connect to electrical service.
6. Wire per wiring diagram using approved wire connectors. See Figure 2.
7. Replace junction box cover.



**FIGURE 3**

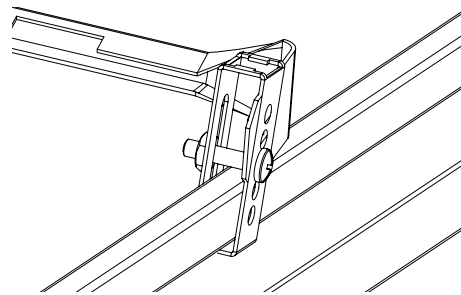
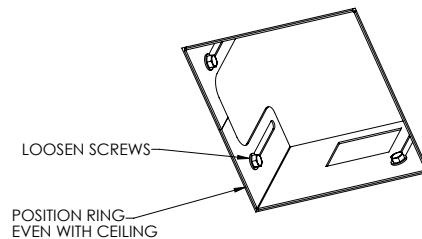

**FIGURE 4**

**TRIM CONNECTION AND INSTALLATION**

To clean reflector use only a soft micro fiber lens cloth or alcohol wipe.

1. With finished ceiling or tile in place, loosen adjustment screws (see Figure 5) and position ring even with ceiling. Re-tighten screws securely.
2. Connect electrical plugs and fasten conduit adapter to trim housing using the screw provided (see Figure 6).
3. Install trim into ceiling opening with retention springs aligned to slots in the adjustment ring. Compressing springs as necessary. Press firmly to ceiling.
4. Check to ensure the gasket between the trim ring and ceiling is compressed.



**FIGURE 5**

**TRIM REMOVAL**

1. To remove trim, pull firmly on flange.



**SERVICE**

CAUTION- BEFORE BEGINNING ANY SERVICE, DISCONNECT POWER TO THE FIXTURE.

**DRIVER REPLACEMENT**

1. For room side access, remove trim from ceiling by pulling downward firmly on the flange.
2. Disconnect conduit adapter by loosening the screw. (See Figure 6)
3. Disconnect connector and remove trim housing to a safe location.
4. Remove (4) screws and remove adjustment ring.
5. Lift spring to remove LED driver/cover assembly.
6. Disconnect leads and reconnect to new driver. Refer to Figure 2 for wiring diagram.
7. Install new driver/cover. Place cover tab into slot in frame and pivot until snapped under spring.
8. Re-install adjustment ring and adjust flush to ceiling.
9. Re-install trim housing following instructions in "Trim Connection and Installation" section.

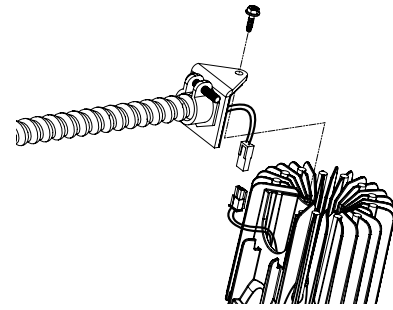

**FIGURE 6**

**MODULE REPLACEMENT**

1. For room side access, remove trim from ceiling by pulling downward firmly on the flange.
2. Disconnect conduit adapter by loosening the screw. (See Figure 6)
3. Disconnect connector and remove trim housing to a safe location.
4. Remove heatsink from lower housing by removing (3) screws and lifting off.
5. Remove (3) screws, reflector plate and insulators as shown in Figure 7. LED module may then be removed and replaced.
6. Apply heatsink paste to back of new module.
7. Feed the connector through the opening in the housing and position the insulators and reflector plate.
8. Secure the LED module, insulators and reflector plate to the housing by re-installing the (3) screws. See Figure 7.
9. Re-assemble the heatsink to the lower housing by replacing the (3) screws.
10. Re-install trim housing following instructions in "Trim Connection and Installation" section.

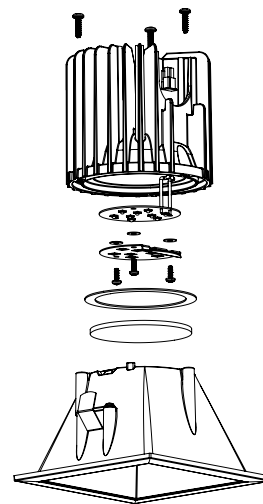

**FIGURE 7**



## CUSTOMER SERVICE

---

For technical assistance, call 1-800-4KENALL (1-800-453-6255).

## WARRANTY

---

For warranty information visit [www.kenall.com/Resources/Certified-Performance-Warranties](http://www.kenall.com/Resources/Certified-Performance-Warranties)

